

Service Manual

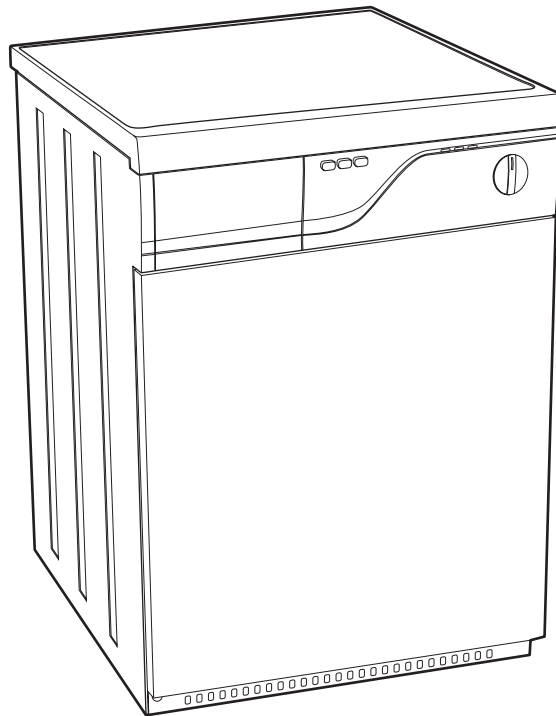

Condenser Drier

IMPORTANT
Remove the plug from the mains power supply when carrying out any operations on the machine.

CONTENTS

| | |
|---|---------|
| Tools necessary for dismantling the various parts of the appliance | Page 03 |
| Step 1 Removing the top cover (B360) | Page 03 |
| Step 2 Removing and/or replacing the upper tie-rods (B350) | Page 03 |
| Step 3 Removing and/or replacing the upper cross-member (B031) | Page 03 |
| Step 4 Removing and/or replacing the programmer knob assembly | Page 04 |
| Step 5 Removing and/or replacing the programmer (B290) from the control panel (B270) | Page 04 |
| Step 6 Removing and/or replacing the buttons (B210) and switches (B330-B340-B015) from the control panel | Page 04 |
| Step 7 Removing and/or replacing the water recovery container (A026) and the container handle assembly (B014 + B052 + B053) | Page 05 |
| Step 8 Removing and/or replacing: - the water recovery container tray (A025) - the cover (A022) of the water recovery container tray - the Pump-Tray feed pipe (A008) - the feed pipe (A009) from the Container Tray to the Container Pump | Page 05 |
| Step 9 Removing and/or replacing the control panel (B270) | Page 06 |
| Step 10 Removing and/or replacing the drum light bulb (A004) and/or the bulb holder (A006) | Page 06 |
| Step 11 Removing and/or replacing: - the filter housing (A021) - the filter housing gasket (A018) - the nib of the door microswitch (A062). - the nib seating plug (A065). - the bottom left – top right hinge (A012) - the top left – bottom right hinge (A013) - the door (A015) - the inner door panel (A014) | Page 07 |
| Step 12 Removing the brush assembly and relative humidity sensing brushes, consisting of: - A620 Bracket - A610 Brush holder - A630 Humidity sensing brush - A640 Pin - A570 Spring | Page 08 |
| Step 13 Removing and/or replacing the power supply cable and/or terminal block (B450) | Page 08 |
| ELECTRICAL CONNECTIONS | Page 09 |
| CONNECTING USING A 3-CORE POWER SUPPLY CABLE | Page 09 |
| CONNECTING USING A 4-CORE POWER SUPPLY CABLE | Page 09 |
| Step 14 Removing and/or replacing: - the air intake inspection cover (B540) - heater element (B560) - the rear air duct (B017) - the maximum temperature thermostat (B030) - the safety thermostat (B006) | Page 10 |
| Step 15 Removing and/or replacing the rear panel (B580) | Page 11 |
| Step 16 Replacing and/or removing the drive belt (A290) | Page 12 |
| Step 17 Replacing and/or removing the rear drum seal with felt (B025) | Page 12 |
| Step 18 Replacing and/or removing the drum assembly (A300) | Page 13 |
| Step 19 Replacing and/or removing the drum paddle with probe (A320) and/or the drum paddle without probe (A310) from the drum assembly (A300) | Page 13 |
| Step 20 Replacing and/or removing the slide blocks (A530) and the felt seal (A045) from the drum support surround (A340) | Page 13 |
| Step 21 Removing and/or replacing: - the water drain pump (A003) - the water drain pump housing cover (A037) - the drain pump safety microswitch (A038) - the safety float (A042) | Page 14 |
| Step 22 Removing and/or replacing: - the motor (A120) - the fan (A200) | Page 14 |
| Step 23 Removing and/or replacing the electric fan (A002) | Page 15 |
| Step 24 Removing and/or replacing the filter housing surround (A340) | Page 15 |
| Step 25 Removing and/or replacing the condenser container (A028) | Page 16 |
| Step 26 Replacing the bottom panel (A260) | Page 16 |
| Step 27 Replacing and/or removing the left hand side panel (B040) and/or the right hand side panel (B230) | Page 17 |

Tools necessary for dismantling the various parts of the appliance:

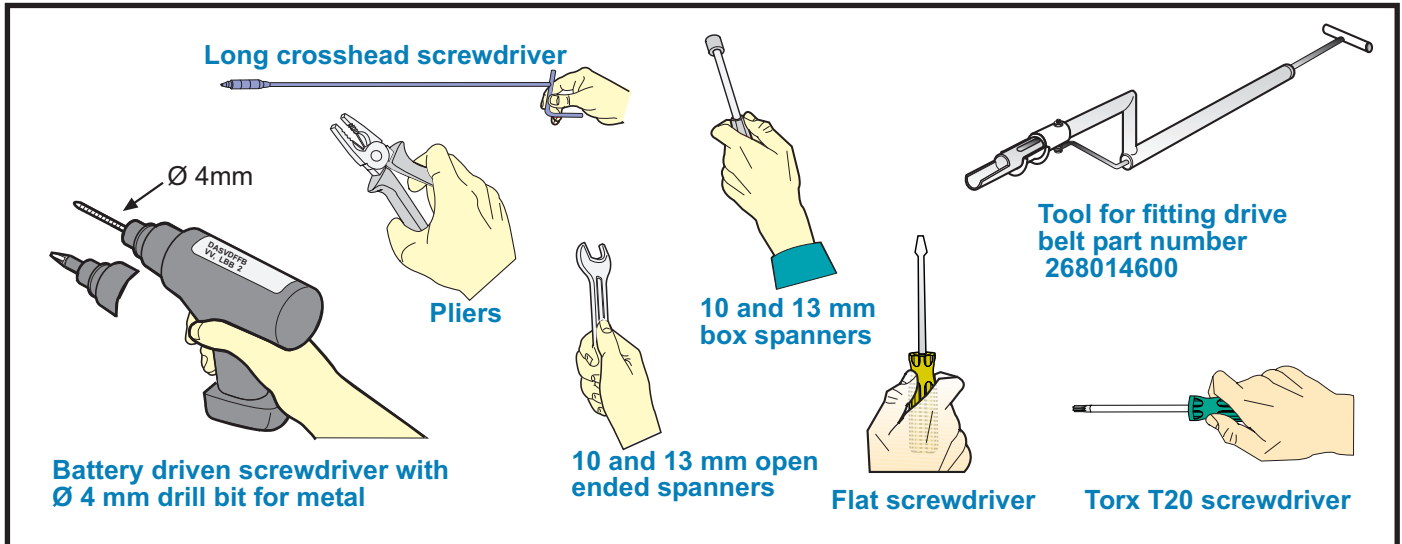

Step 1 Removing the top cover (B360):

- Use a crosshead screwdriver to remove the two screws (B440) securing the back of the top cover panel (B360).
- Lift the back part of the cover and push it forwards to remove it.
- To re-assemble, follow the same procedure in reverse order.

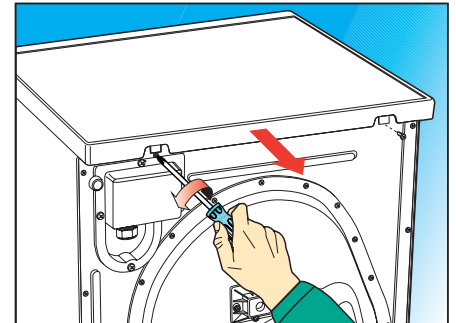
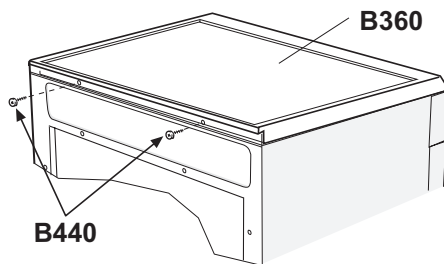

Step 2 Removing the upper tie-rods (B350):

- Use a crosshead screwdriver to remove the four screws (A510) securing the tie-rods to the side panels of the cabinet (B026).
- To re-assemble, follow the same procedure in reverse order.

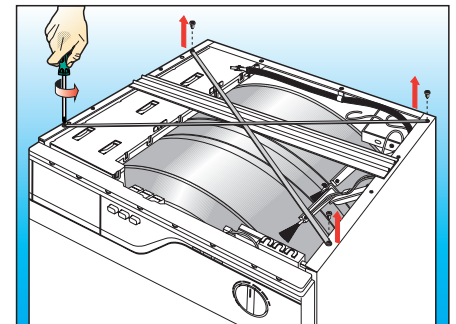

Step 3 Removing the upper cross-member (B031):

- Use a crosshead screwdriver to remove the four screws securing the cross-member to the side panels of the cabinet (B026).
- To re-assemble, follow the same procedure in reverse order.

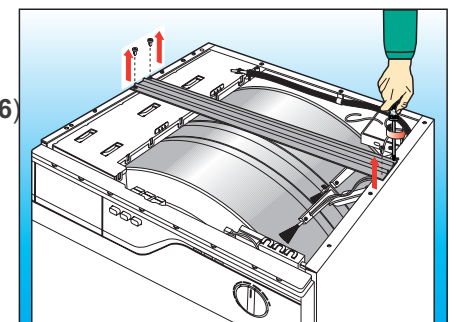
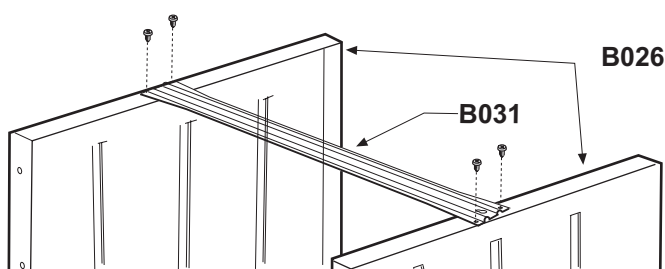

Step 4

Removing and/or dismantling the programmer knob assembly:

- Grasp the knob manually and pull it out gently.
- Remove the knob cover (B740) together with the pointer (B013) and cover plate (B730) by levering delicately on the lugs. Then carefully remove the pieces.
- Recover the two springs (B750), cam (B220) and spring (B067).
- To re-assemble, follow the same procedure in reverse order.

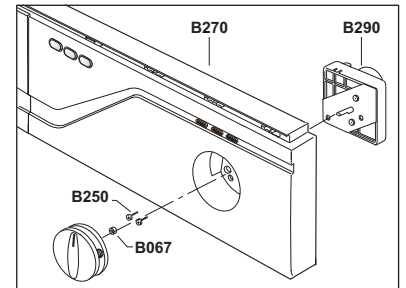
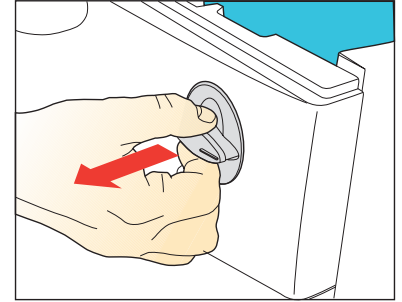
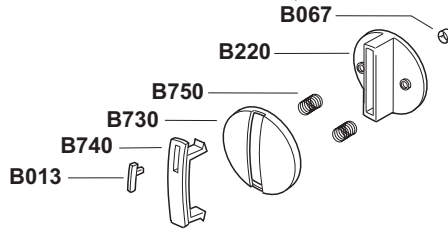

Step 5

Removing and/or replacing the programmer (B290) from the control panel (B270):

- Remove the top cover (Step 1).
- Remove the programmer knob by grasping it gently and pulling (Step 4).
- Use a crosshead screwdriver to remove the two screws (B250) fixing the programmer (B290) to the control panel (B270).
- To remove the electrical connections from the programmer, proceed as follows:
 - Use a flat screwdriver as a lever on the connector clip and remove the connector.
 - Use the pliers to remove all the other electric wires, noting their positions.
- To re-assemble, follow the same procedure in reverse order, taking care to check that the wire colours and markings correspond to the appliance's wiring diagram.

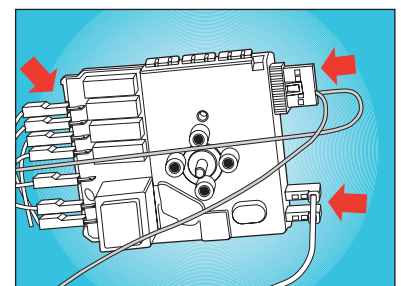
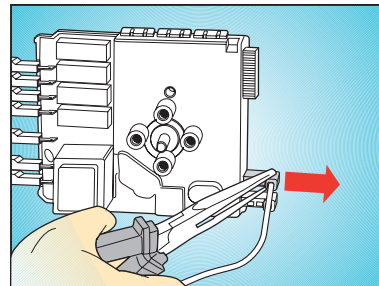
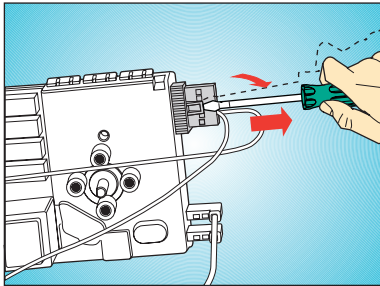
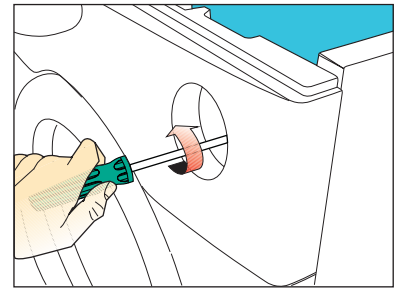

Step 6

Removing and/or replacing the buttons (B210) and switches (B330-B340-B015) from the control panel:

- Remove the top cover (Step 1).
- To remove the buttons (B210), insert the point of a screwdriver in the button mounting slot on the inside of the control panel and then push the button outwards.
- To remove the switches (B330-B340-B015) from the front of the control panel, use a screwdriver as a lever on the retaining lugs and then remove the switches.
- Disconnect the wiring noting the positions of the wires.
- To re-assemble, follow the same procedure in reverse order.

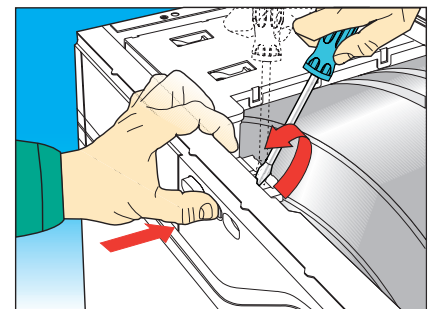
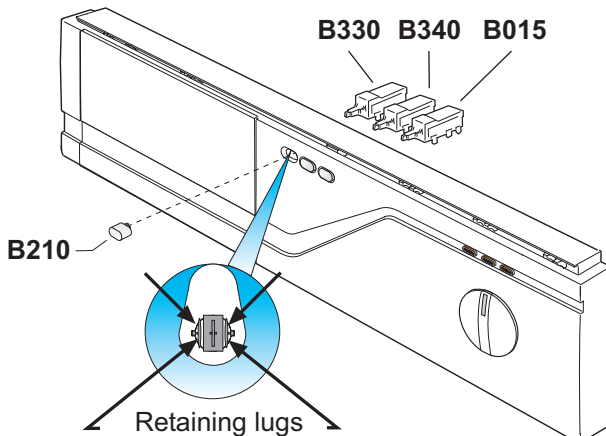

Step 7

Removing, dismantling and/or replacing the water recovery container (A026) and the container handle assembly (B014 + B052 + B053):

- Grasp the handle of the control panel to pull out the water recovery container assembly (A026).
- Use a crosshead screwdriver to remove the fixing screws securing the handle assembly to the water recovery container.
- Use a flathead screwdriver to lever out the plug (A056) of lever (A054), then recover the spring (A055).
- To dismantle the handle assembly, remove spring (B053) from its seating.
- To re-assemble, follow the same procedure in reverse order.

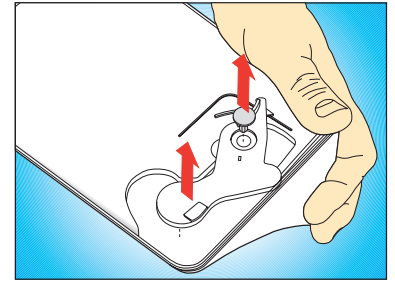
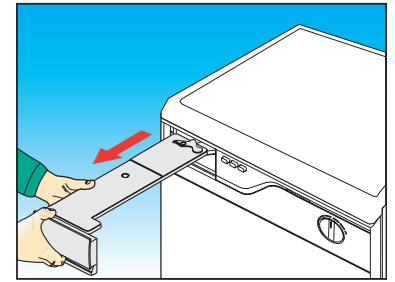
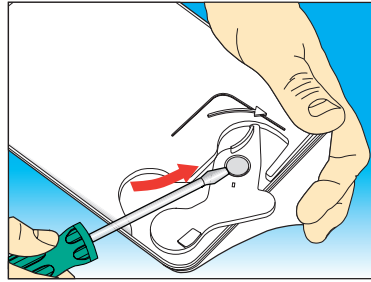
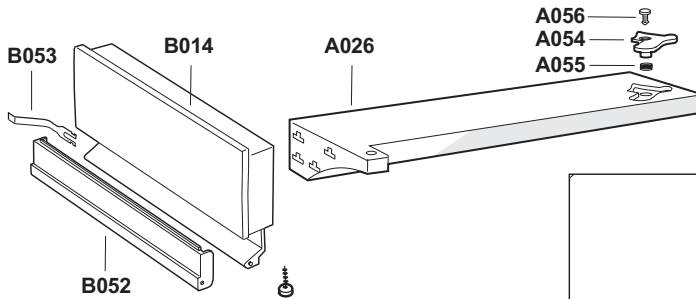

Step 8

**Removing and/or replacing the water recovery container tray (A025):
the cover (A022) of the water recovery container tray:
the Pump-Tray feed pipe (A008):
the feed pipe (A009) from the Container Tray to the Container Pump:**

- Remove the top cover (Step 1).
- Remove the water recovery container assembly (Step 7) without dismantling it.
- Remove the upper tie-rods (B350) (Step 2).
- Remove the upper cross-member (B031) (Step 3).
- Use a crosshead screwdriver to remove the screws securing the tray to the side panels of the cabinet, and then the four screws fixing it to the control panel.
- Remove the four screws securing the rear panel to the side panels to access pipe connection (A009). Disconnect the pipe.
- Use a flat screwdriver as a lever to remove the nozzle (A023) from its housing. At this point, the tray assembly (A025 + A022) can be removed by moving it towards the centre of the appliance and then lifting it.
- To re-assemble, follow the same procedure in reverse order.

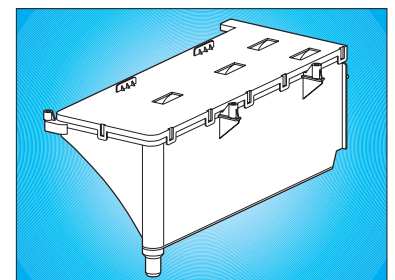
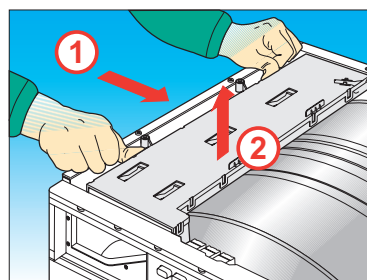
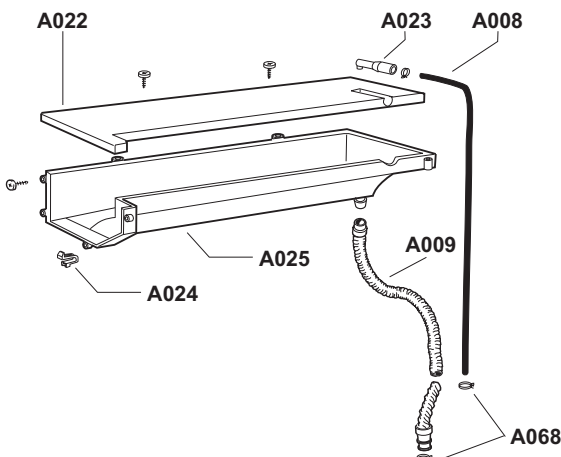
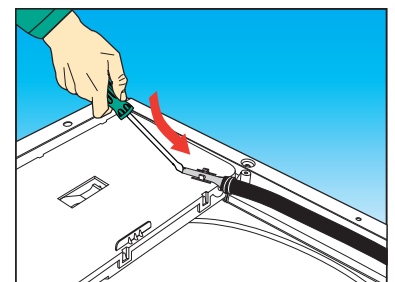
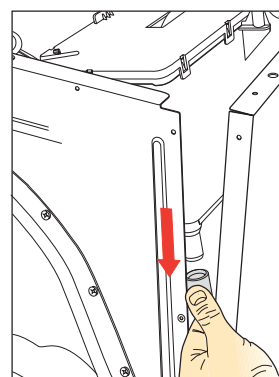
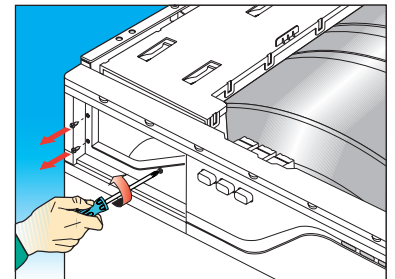
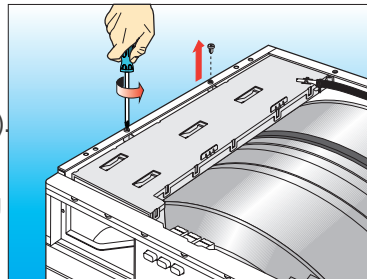

Step 9 Removing and/or replacing the control panel (B270):

- (a) Remove the top cover (**Step 1**).
- (b) Remove the water recovery container assembly (**Step 7**) without dismantling it.
- (c) Remove the upper tie-rods (**B350**) (**Step 2**).
- (d) Remove the upper cross-member (**B031**) (**Step 3**).
- (e) Remove the programmer knob assembly (**Step 4**).
- (f) Remove the programmer (**B290**) (**Step 5**).
- (g) Remove the buttons (**B210**) and switches (**B330-B340-B015**) (**Step 6**) without disconnecting the wiring.
- (h) Remove the three indicator lights.
- (i) Use a long crosshead screwdriver to remove the four screws fixing the control panel to the cabinet.
Remove the control panel and recover the three indicator lights (**B620**) and the cable clamp (**B600**).
- (j) To re-assemble, follow the same procedure in reverse order.

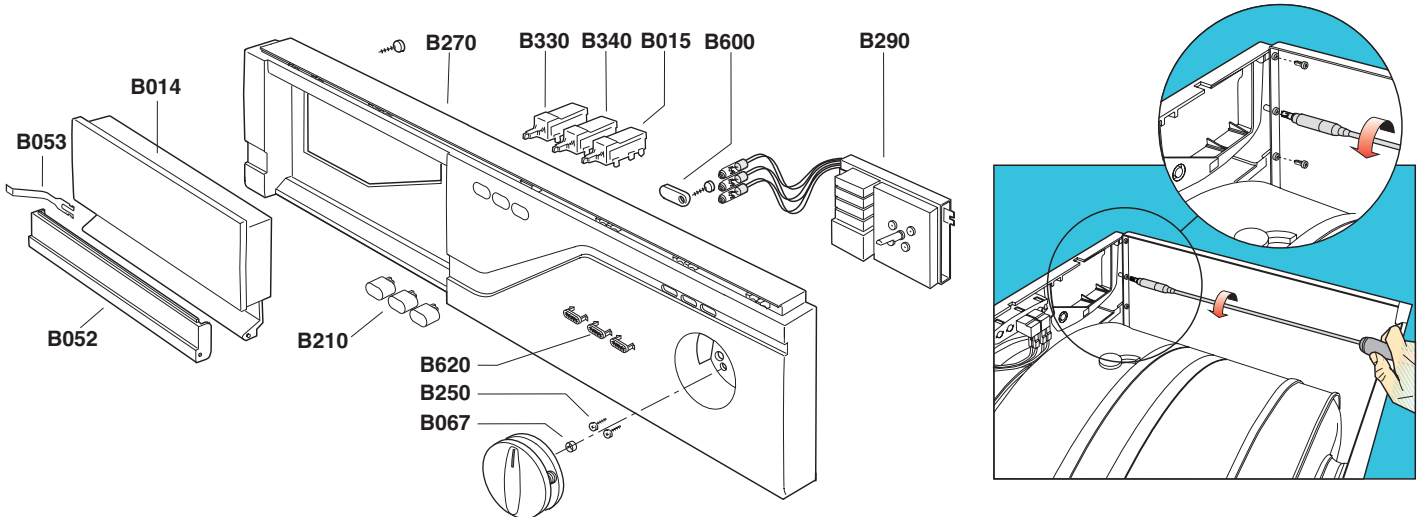

Step 10 Removing and/or replacing the drum light bulb (A004) and/or the bulb holder (A006):

- (a) Remove the top cover (**Step 1**).
- (b) From the door opening, use a pair of pliers to grip the bulb protector (**A005**) and rotate it anticlockwise.
- (c) Unscrew the bulb (**A004**) and replace it.
- (d) Once the bulb has been removed, release the bulb holder (**A006**) by manually levering the locking tabs and then remove it from the outside.

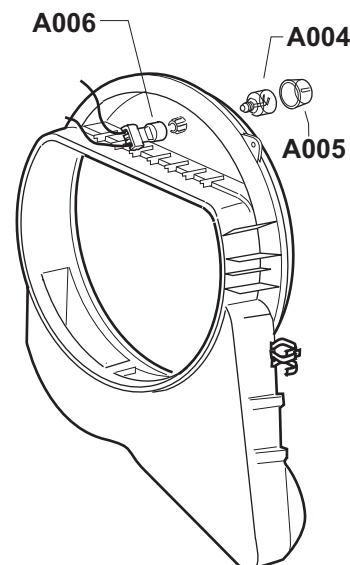
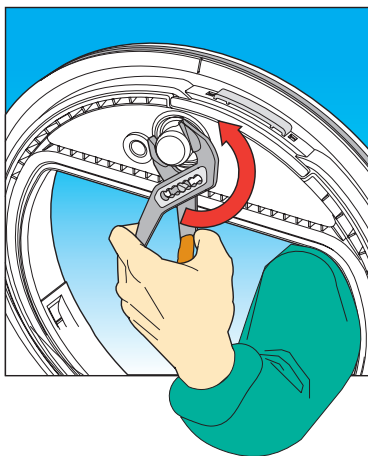

Step 11

Removing and/or replacing:

- (a) The filter housing (A021) and the filter housing gasket (A018).
- (b) The nib of the door microswitch (A062).
- (c) The nib seating plug (A065).
- (d) The bottom left - top right hinge (A012) and the top left - bottom right hinge (A013)
- (e) The door (A015).
- (f) The inner door panel (A014).

First open the door, then:

- (a) Use a crosshead screwdriver to remove the four fixing screws securing the filter housing (A021), then remove and recover the gasket (A018).
- (*) To re-assemble, follow the same procedure in reverse order.
- (b) Gently insert a flat screwdriver and use it as a lever between the nib (A062) of the microswitch and the seating in the inner door panel (A014), strike the top of the nib gently with a rubber hammer and remove it from the seating.
- (*) To re-assemble, follow the same procedure in reverse order.
- (c) Gently insert a flat screwdriver and use it as a lever between the nib plug (A065) and the seating in the inner door panel (A014), strike the top of the nib gently with a rubber hammer and remove it from the seating.
- (*) To re-assemble, follow the same procedure in reverse order.
- (d) Use a crosshead screwdriver to remove the two fixing screws of the bottom left hinge (A012), then remove the door assembly (A015 + A014).

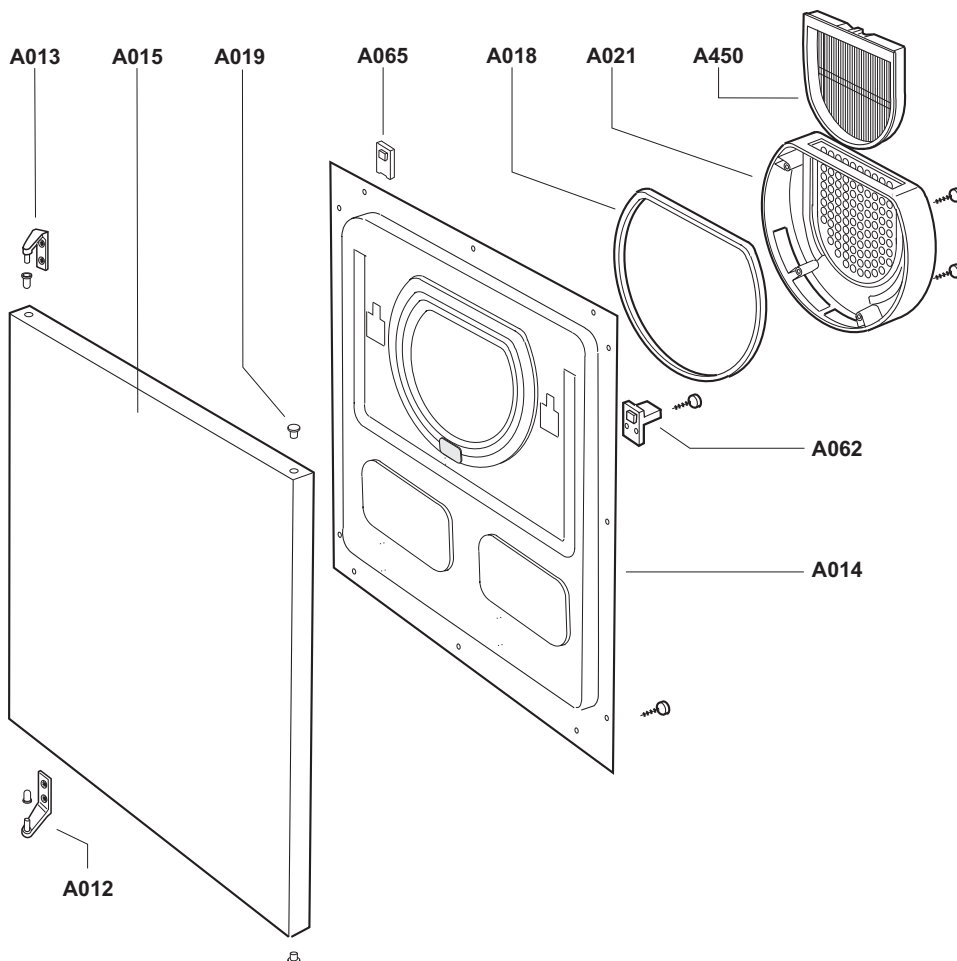
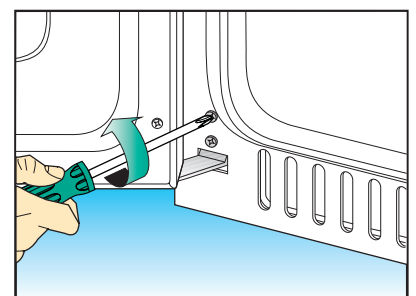
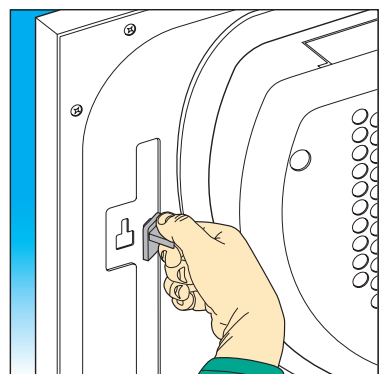
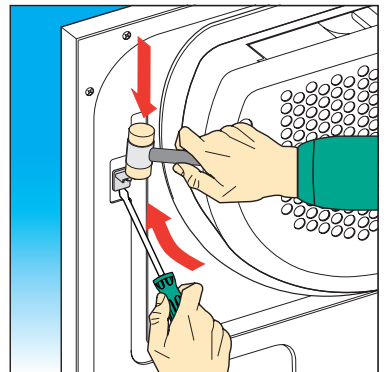
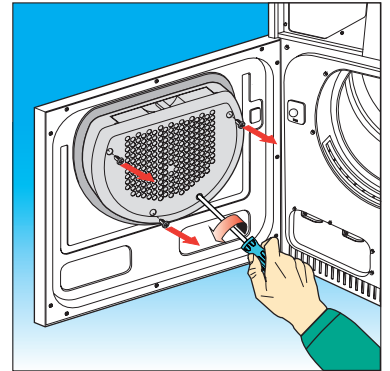

Step 12

Removing the brush assembly and relative humidity sensing brushes, consisting of:

- A620 Bracket
- A610 Brush holder
- A630 Humidity sensing brush
- A640 Pin
- A570 Spring

- (a) Remove the top cover (**Step 1**).
- (b) Use a crosshead screwdriver to remove the fixing screws securing the brush assembly to the cabinet.
- (c) Use a crosshead screwdriver to remove the fixing screw securing the electric wiring to the brush holder.
- (e) To re-assemble, follow the same procedure in reverse order.

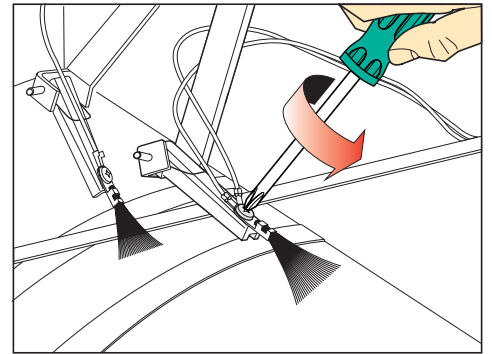
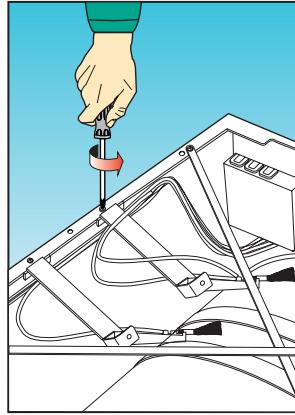
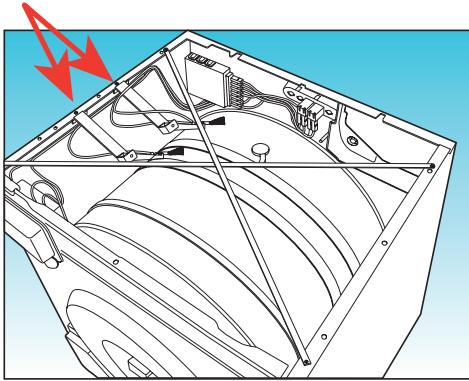
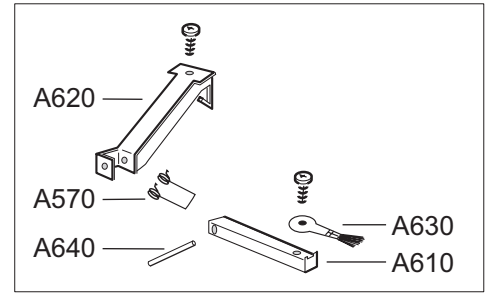

Step 13

Removing and/or replacing the power supply cable and/or terminal block (B450):

- (a) Remove the top cover (**Step 1**).
- (b) From the back of the drier, use a cross-head screwdriver to remove the four screws securing the terminal block cover (B076), then replace the power cable and/or terminal block (B450) following the procedures reported below.
- (c) To re-assemble, follow the same procedure in reverse order.

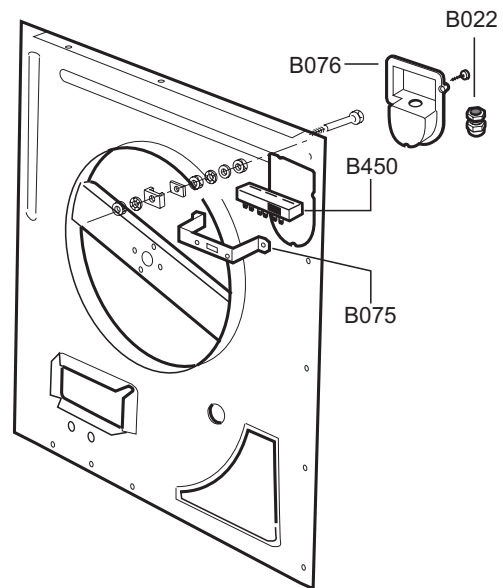
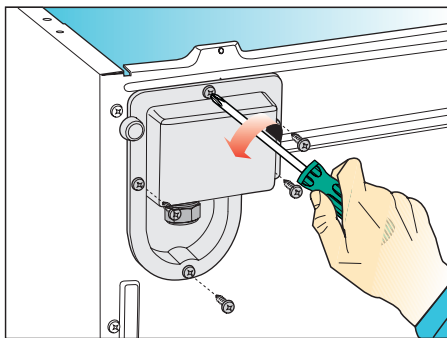

ELECTRICAL CONNECTIONS

The power supply cable must be equipped with an earth connection. If the appliance is to be used in a damp or wet atmosphere, the power supply must be fitted with a differential switch as protection. The connection to a permanent power supply source must be made by a qualified electrician.

Supplied system: Single-phase, 230 V, 60 Hz, with 2500 Watt heater element and 30 A fuse to install.

CONNECTING USING A 3-CORE POWER SUPPLY CABLE

WARNING!! Before starting this procedure, make sure that the power supply to the fuse box/mains switch has been disconnected.

Use a power supply cable with three N. 10 copper conductors and a suitable socket for type NEMA 10-30R 3-core cables, as shown in the following figure.

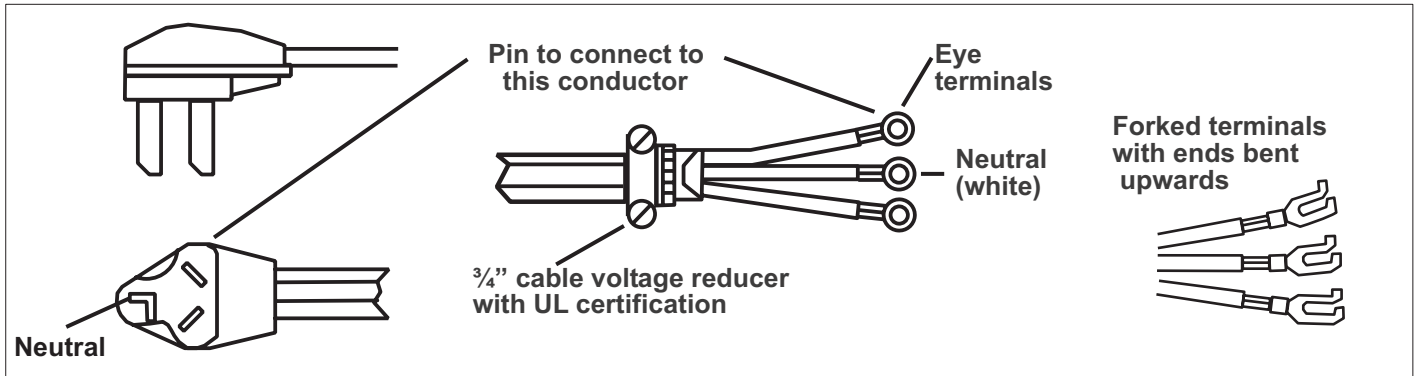

To connect a 3-core power supply cable, proceed as follows:

1. Disconnect the power supply at the fuse box or main switch.
2. Remove the terminal block cover.
3. Fit the cable voltage reducer underneath the terminal block opening.
4. Slacken or remove the centre screw of the terminal block.
5. Connect the neutral (white) wire of the power supply cable to the centre silvered screw of the terminal block, then tighten the screw.
6. Connect the other wires to the outer screws.
7. Tighten the screws of the cable voltage reducer.
8. Replace the terminal block cover on the back of the appliance.
9. Insert the plug of the appliance in the mains wall socket.
10. Reconnect the power supply at the fuse box or main switch.

The numbers in the following figure refer to the steps of the procedure.

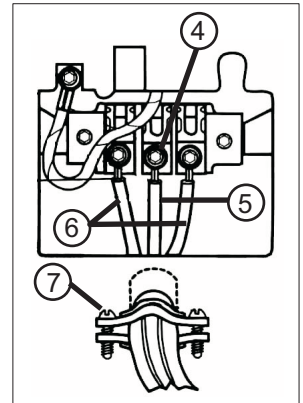

CONNECTING USING A 4-CORE POWER SUPPLY CABLE

WARNING!! Before starting this procedure, make sure that the power supply to the fuse box/mains switch has been disconnected.

Use a power supply cable with four N. 10 copper conductors and a suitable socket for type NEMA 14-30R 4-core cables, as shown in the following figure. The fourth wire and the neutral conductor must be identified by a green cap and white cap respectively.

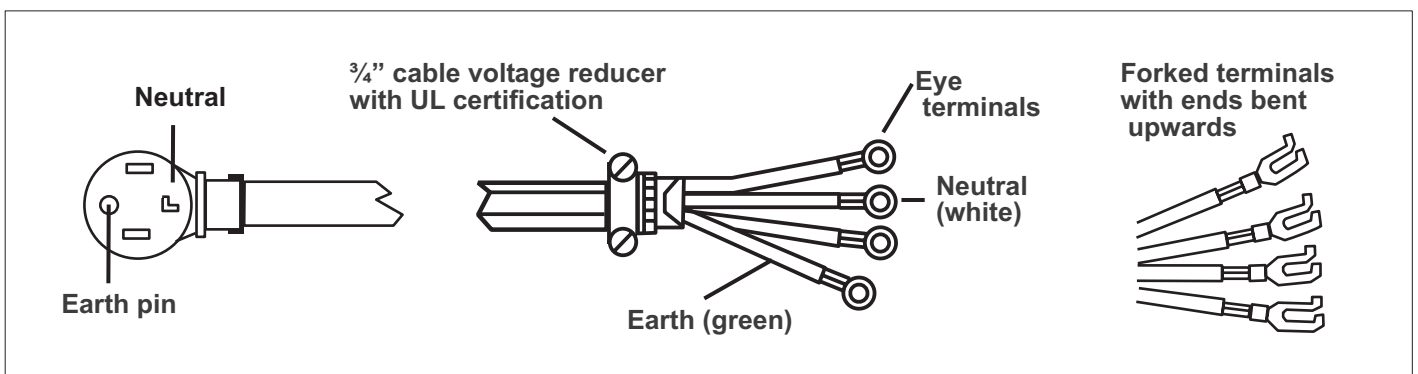

MAINTENANCE PROCEDURES

To connect a 4-core power supply cable, proceed as follows:

1. Disconnect the power supply at the fuse box or main switch.
2. Remove the terminal block cover.
3. Fit the cable voltage reducer underneath the terminal block opening.
4. Remove the centre screw of the terminal block.
5. Remove the earth wire (green with yellow stripes) from the external earth screw. Stop under the silvered centre screw of the terminal block.
6. Connect the earth wire (green) of the cable to the earth conductor screw.
7. Connect the neutral wire (white) of the cable under the centre screw of the terminal block.
8. Connect the other wires to the outer screws.
9. Tighten the screws of the cable voltage reducer.
10. Replace the terminal block cover on the back of the appliance.
11. Insert the plug of the appliance in the mains wall socket.
12. Reconnect the power supply at the fuse box or main switch.

The numbers in the following figure refer to the steps of the procedure.

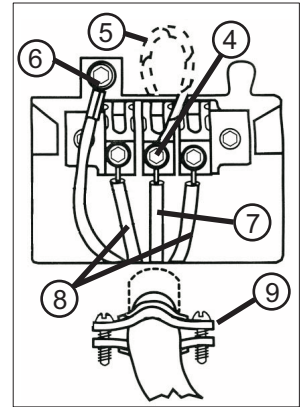

Step 14

Removing and/or replacing:

- the air intake inspection cover (B540)
- heater element (B560)
- the rear air duct (B017)
- duct gasket (B027)
- the maximum temperature thermostat (B030)
- the safety thermostat (B006)

- (a) Use a crosshead screwdriver to remove the fixing screws securing the air intake inspection cover (B540).
- (b) Disconnect the wiring from the heater element (B560) making use of the space left by the air intake inspection cover (B540) removed previously.
- (c) Use a crosshead screwdriver to remove the four fixing screws securing the drum shaft support flange (B650), and then remove the drum shaft support (B640).
- (d) Use a crosshead screwdriver to remove the 21 fixing screws securing the rear air duct, remove the dummy cable grommet and remove the rear air duct.
- (e) Use a crosshead screwdriver to remove the four fixing screws securing the heater element (B560). Replace the element, remembering to remove and recover the screws securing the maximum temperature thermostat (B030) and the safety thermostat (B006).

Very important:

Each time the rear air duct is removed (B017) the duct gasket (B027) must be replaced with a new one.

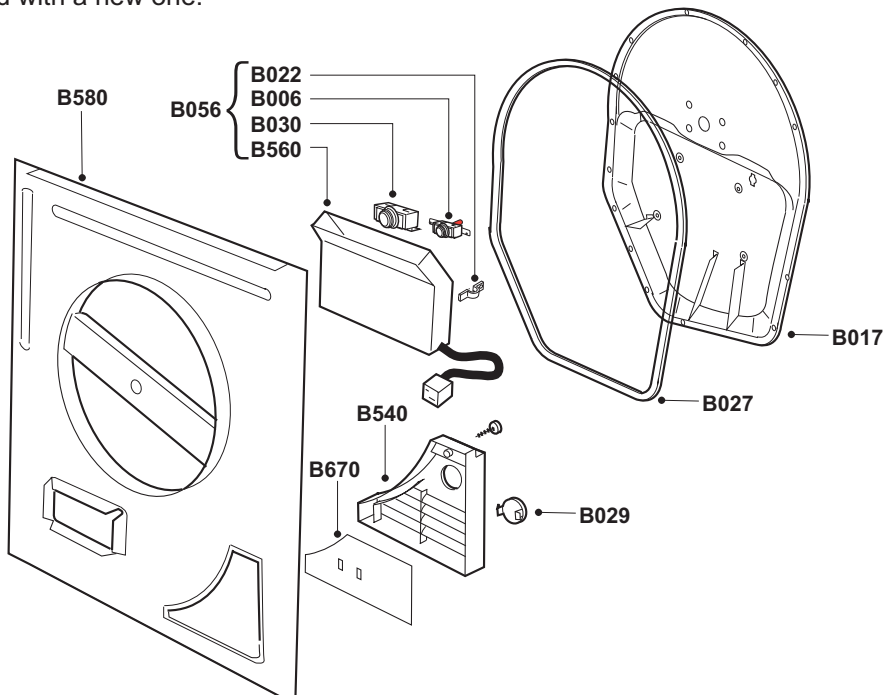
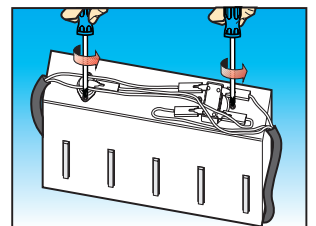
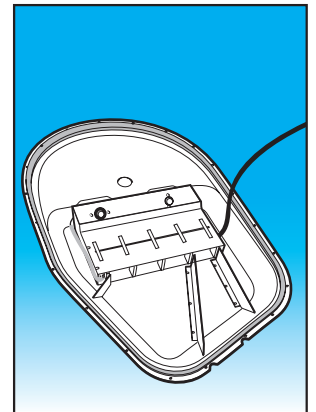
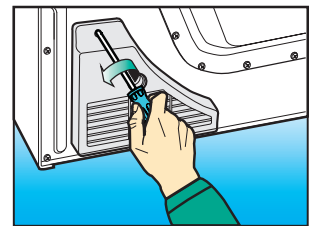

Step 15 Removing and/or replacing the rear panel (B580):

- (a) Remove the top cover (**Step 1**).
- (b) Remove the power supply cable and the power supply cable terminal block cover (**B076**) (**Step 13**).
- (c) Use a crosshead screwdriver to remove the fixing screws securing the air intake inspection cover (**B540**).
- (d) Disconnect the wiring from the heater element (**B560**) making use of the space left by the air intake inspection cover (**B540**) removed previously.
- (e) Release the toothed belt (**A290**) (using the space left previously) to free the drum of the belt tension and to be able to remove the rear panel (**B580**).
- (f) Use a crosshead screwdriver to remove the four fixing screws securing the drum shaft support flange (**B650**), and then remove the drum shaft support (**B640**).
- (g) Use a crosshead screwdriver to remove the 21 fixing screws securing the rear air duct, remove the dummy cable grommet and remove the rear air duct (**B017**).
- (h) Use a crosshead screwdriver to remove the screw securing the condensation pipe clamp.
- (i) Use a crosshead screwdriver to remove the two fixing screws securing the condenser container (**A028**) to the rear panel.
- (j) Use a crosshead screwdriver to remove the 13 screws securing the rear panel (**B580**) and replace it.

NB: When replacing the rear panel (**B580**), recover all the components fixed to it (see exploded view):

Very important:

Each time the rear air duct is removed (**B017**) the duct gasket (**B027**) must be replaced with a new one.

- (k) To re-assemble, follow the same procedure in reverse order, taking care to insert the belt (**A290**) temporarily around the drum (**A300**) (**Step 16**). Then reconnect the motor terminal block and the heater element wiring. When replacing the drum shaft support only (**B640**), apply the grease supplied as spare part number **190013800** on the inside part in contact with the drum shaft. Make sure that the teeth of the drum shaft support are facing the rear panel.

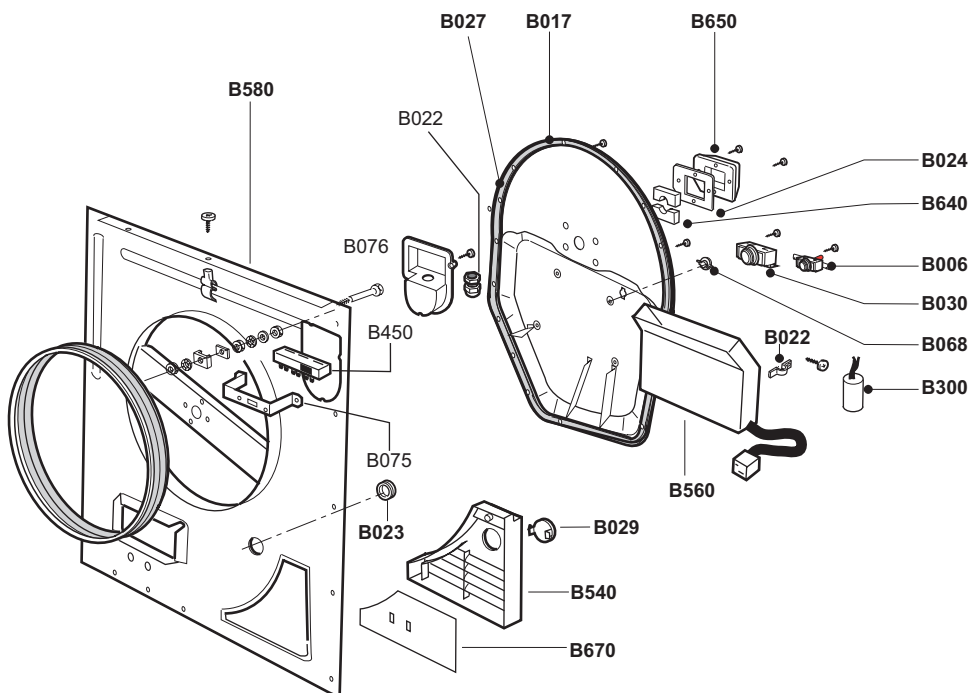
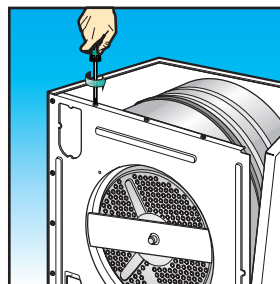
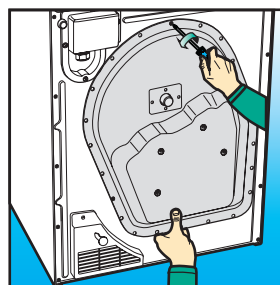
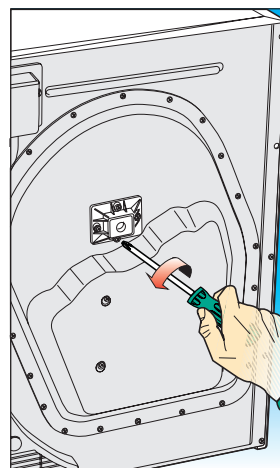
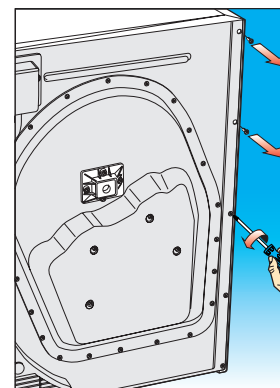

Step 16 Removing and/or replacing the drive belt (A290):

- (a) Remove the top cover (B360) as described in **Step 1**.
- (b) Remove the rear panel (B580) following **Step 15**, dismantling only those parts necessary.
- (c) Manually remove the belt (A290) from the drum and motor.
- (d) To re-assemble, use special tool number **268014600**, supplied as a spare part.
To position the belt, insert it in the slot of the rear panel. Hook up the belt as shown in the figure below, then press to slide the belt onto the motor shaft. Gently rotate the tool and remove it. Rotate the drum manually to check the correct alignment of the belt (if the alignment is not perfect, repeat the operation).

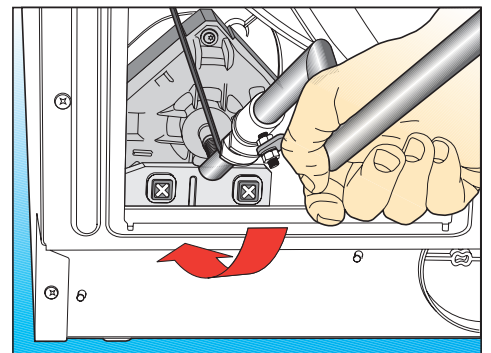
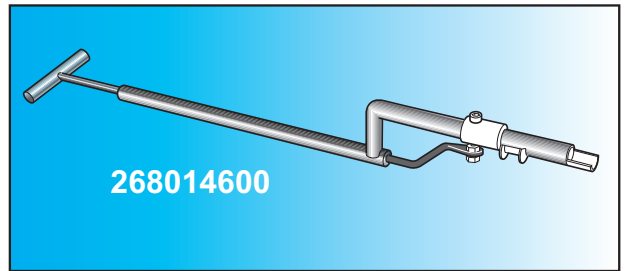
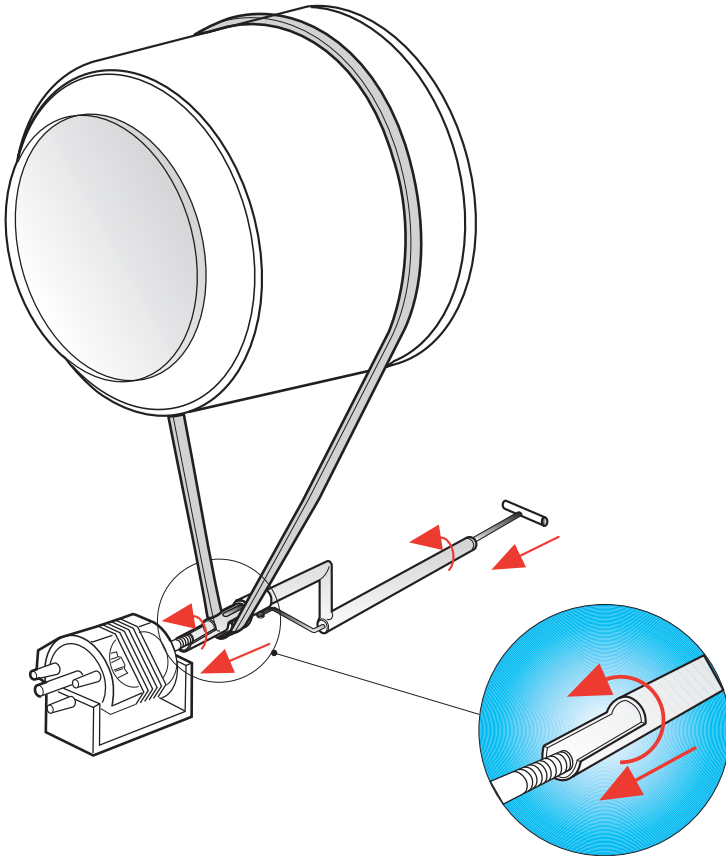

Step 17 Replacing and/or removing the rear drum seal with felt (B025):

- (a) Remove the top cover (B360) as described in **Step 1**.
- (b) Remove the rear panel (B580) following **Step 15**, dismantling only those parts necessary.
- (c) Manually remove the seal with the felt (B025).
- (d) To re-assemble, follow the same procedure in reverse order, taking care to reposition the seal correctly. Spread some lubricating grease over the entire surface of the white felt.

NB: A special assembly consisting of a seal (B025) with a container of lubricating grease can be ordered using part number **720206000**.

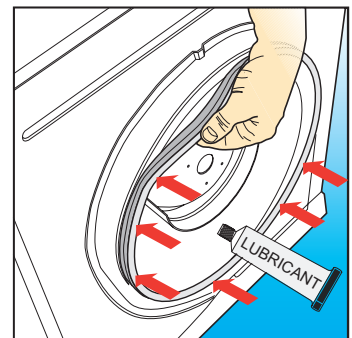
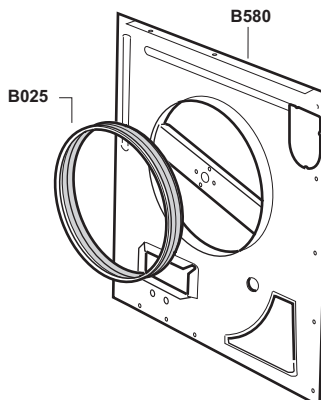
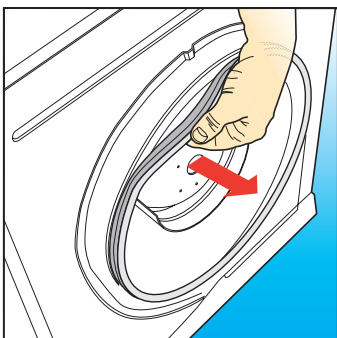

Step 18 Replacing and/or removing the drum assembly (A300):

- (a) Remove the top cover (B360) as described in **Step 1**.
- (b) Remove the rear panel (B580) following **Step 15**, dismantling only those parts necessary.
- (c) Manually remove the belt (A290) from the drum and motor.
- (d) Remove the two fixing screws (A510) securing the tie rods (B350) to the back of the drier. Push the side panels apart and extract the drum.
- (e) To re-assemble, follow the same procedure in reverse order, following **Step 16** to replace the belt.

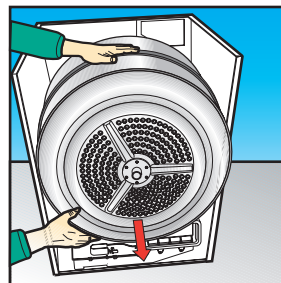
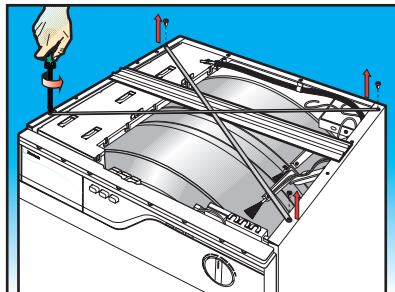

Step 19 Replacing and/or removing the drum paddle with probe (A320) and/or the drum paddle without probe (A310) from the drum assembly (A300):

- (a) Remove the top cover (B360) as described in **Step 1**.
- (b) Remove the three fixing screws securing the paddle to be replaced.
- (c) To re-assemble, follow the same procedure in reverse order, following **Step 18** to replace the belt.

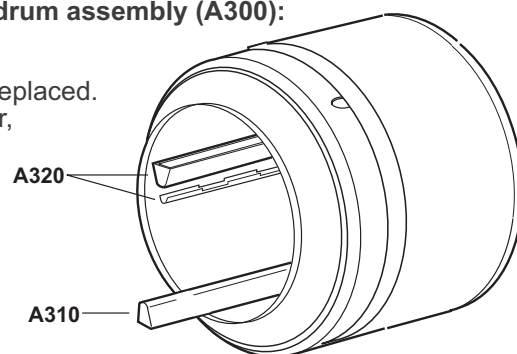

Step 20 Replacing and/or removing the slide blocks (A530) and the felt seal (A045) from the drum support surround (A340):

- (a) Remove the top cover (B360) as described in **Step 1**.
- (b) Remove the drum (A300) following **Step 18**.
- (c) Use one hand to press on the rear catch of the slide block (A530) and remove it.
- (d) Remove the cover (B590) in order to be able to release the drum support slide block (A061), use one hand to press and release the slide block. Release the other support slide block (A061) located on the right hand side.
- (e) At this point, the felt seal (A045) can be removed with the help of a screwdriver.

NB: When replacing either the slide blocks or the felt seal, it is advisable to fit both new slide blocks (A530) and a new seal (A045). A kit is available for this operation and can be ordered as spare part number 720208100. The kit also contains the two-sided adhesive tape for fixing the felt seal.

- (f) To re-assemble, follow the same procedure in reverse order, following **Step 18** to replace the belt.

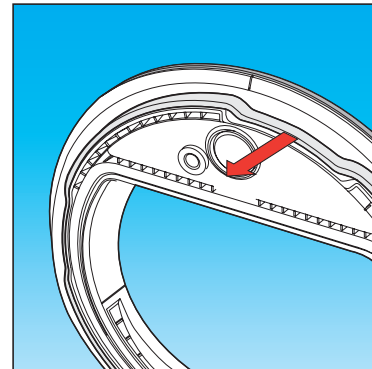
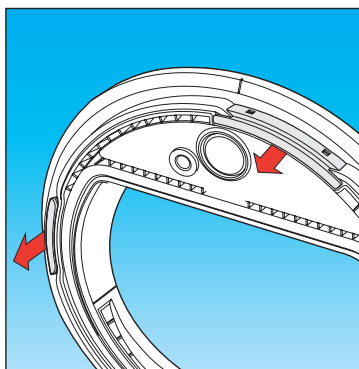
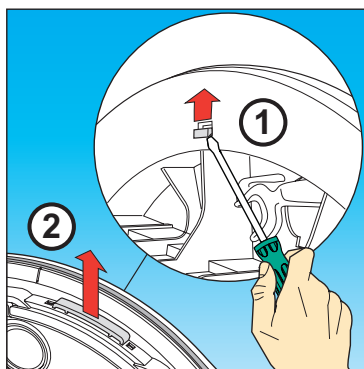

Step 21

Removing and/or replacing:

- the water drain pump (A003).
- the water drain pump container cover (A037)
- the drain pump safety microswitch (A038).

- (a) Follow **Step 18** to remove the drum in order to have easy access to the parts to replace.
- (b) Use a flat screwdriver to lever the locking tab and remove the drain pump safety microswitch (A038), if replacing, disconnect the wiring.
- (c) Use a crosshead screwdriver to remove the water drain pump (A003) fixing screw. Disconnect the wiring and remove the pump from the container cover (A037). If replacing, use a pair of pliers to remove the tray feed pipe (A009) locking clamp (A068).
- (d) Remove drain pump container feed pipe (A009).
- (e) Use a crosshead screwdriver to remove the screws securing the drain pump container cover (A037), then slide the cover to the left (motor side) to release the locking mechanism. If replacing, recover the safety float (A042) and float stop ring (A053).
- (f) To re-assemble, follow the same procedure in reverse order.

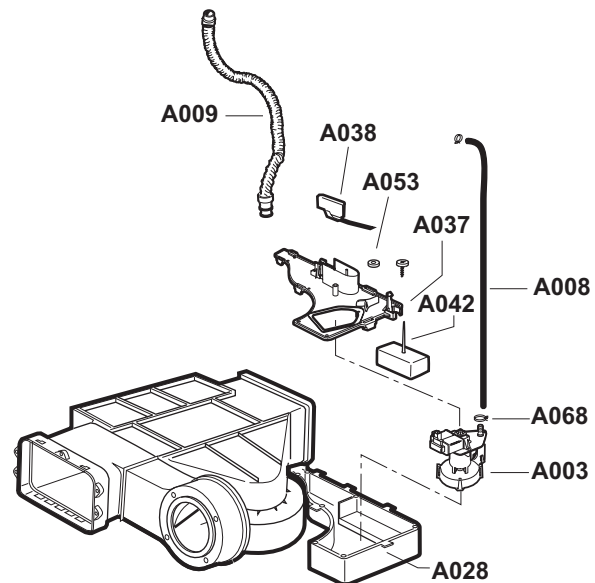
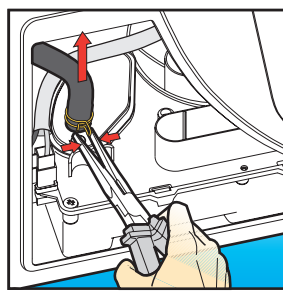
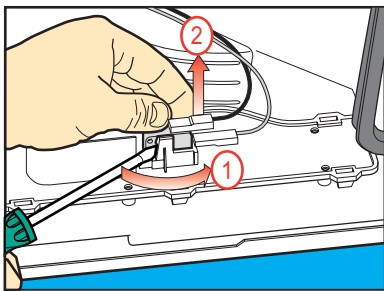

Step 22

Removing and/or replacing:

- the motor (A120).
- the fan (A200).

- (a) Follow **Step 18** to remove the drum in order to have easy access to the parts to replace.
- (b) Lie the appliance on its back and use a 10 mm open-ended spanner to remove the four motor fixing screws (A390).
- (c) Rise the appliance and remove the drain pump container cover (A037) without dismantling any of the components. This will provide more working space.
- (d) Use a long crosshead screwdriver to remove the nine fixing screws securing the scroll flange (A035).
- (e) Use a 10 mm open-ended spanner to hold the motor shaft nut and use a 10 mm box spanner to slacken the fan (A200) locknut (A110).
- (f) Use a crosshead screwdriver to remove the three flange (A035) fixing screws.
- (g) To re-assemble, follow the same procedure in reverse order, taking care to replace nut (A110) with a new one in order to guarantee the operation of the self-locking system, otherwise use a locking compound. When fitting the motor group, make sure that seal (A027) is not damaged or incorrectly positioned.

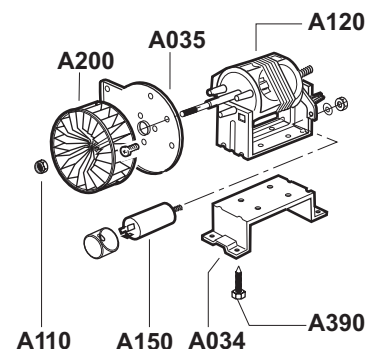
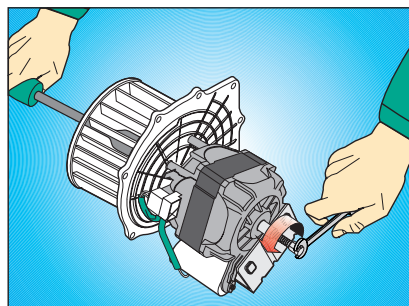
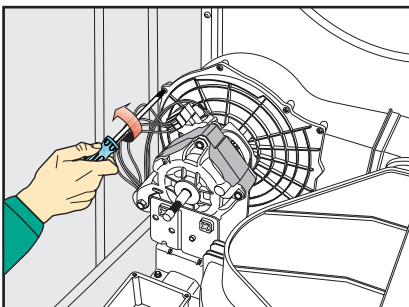

Step 23 Removing and/or replacing the electric fan (A002):

- Follow **Step 18** to remove the drum in order to have easy access to the parts to replace.
- Disconnect the wires from the electric fan (**A002**).
- Lie the drier on its back.
- Use a crosshead screwdriver to remove the four screws securing the electric fan support (**A011**).
- Remove the electric fan group, then separate the electric fan (**A002**) from its support (**A011**) by removing the four fixing screws using a crosshead screwdriver.
- If replacing, recover the parts to be re-used.
- To re-assemble, follow the same procedure in reverse order.

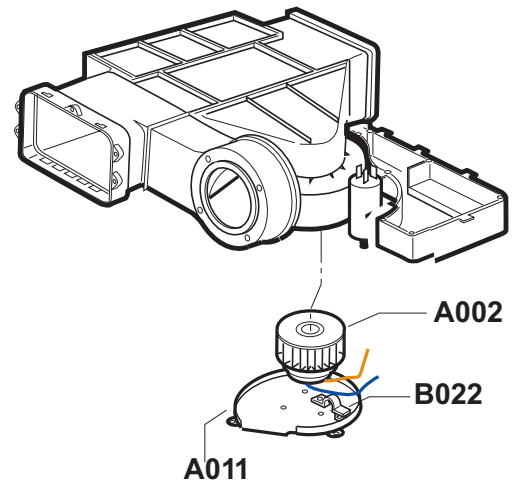

Step 24 Removing and/or replacing the filter housing surround (A340):

- Follow **Step 18** to remove the drum in order to have easy access to the parts to replace.
- Carry out the operations in **Step 22** to remove the motor (**A120**).
- Use a crosshead screwdriver to remove the three fixing screws between the filter housing surround (**A340**) and the condenser container (**A028**).
- Use a crosshead screwdriver to remove the five fixing screws securing the filter housing surround to the front panel (**B028**).
- To obtain more working space, remove the four fixing screws securing the humidity condenser (**A049**).
- Disconnect the wiring from the filter housing surround and remove it.
- If replacing, recover the parts to be re-used.
- To re-assemble, follow the same procedure in reverse order.

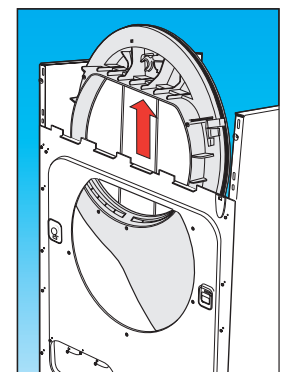
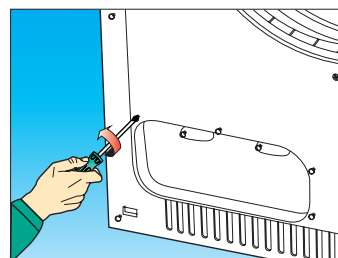
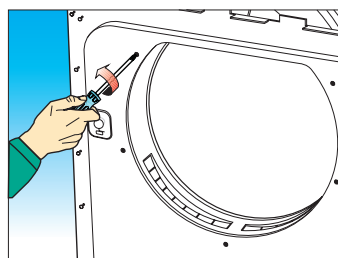
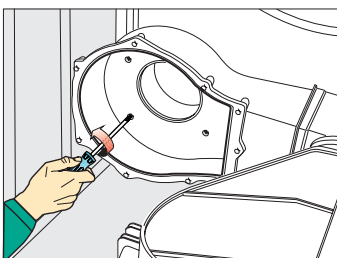
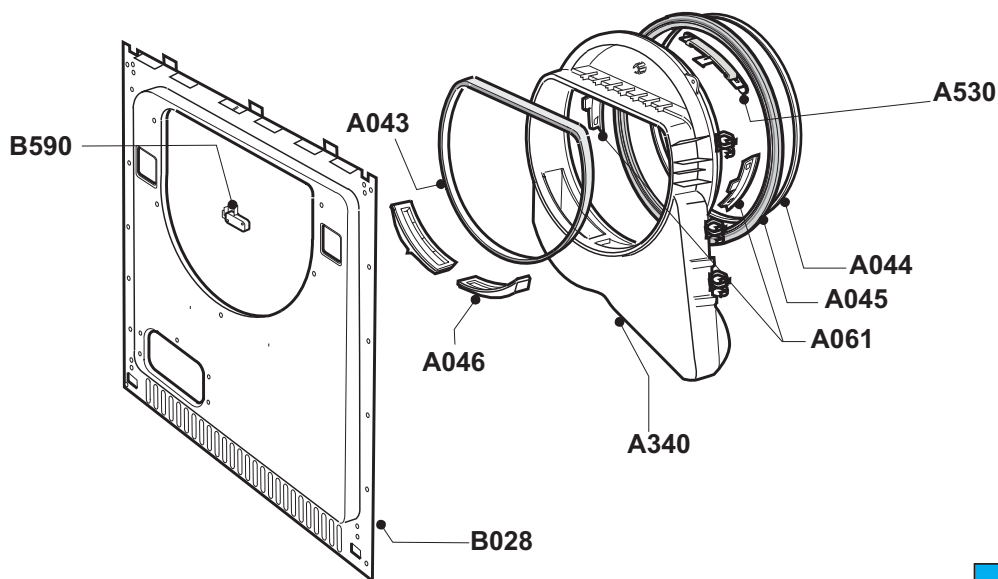

Step 25 Removing and/or replacing the condenser container (A028):

- (a) Follow **Step 18** to remove the drum in order to have easy access to the parts to replace.
- (b) Carry out the operations in **Step 22** to remove the motor (A120).
- (c) Use a crosshead screwdriver to remove the three fixing screws between the filter housing surround (A340) and the condenser container (A028).
- (d) Remove the electric fan (A002) following **Step 23** in order to have more working space.
- (e) Remove the four fixing screws securing the humidity condenser (A049) to the front panel.
- (f) Lie the appliance on its back and use a crosshead screwdriver to remove the three fixing screws securing the condenser container (A028) to the bottom panel (A260).
- (g) If replacing, recover the parts to be re-used.
- (h) To re-assemble, follow the same procedure in reverse order.

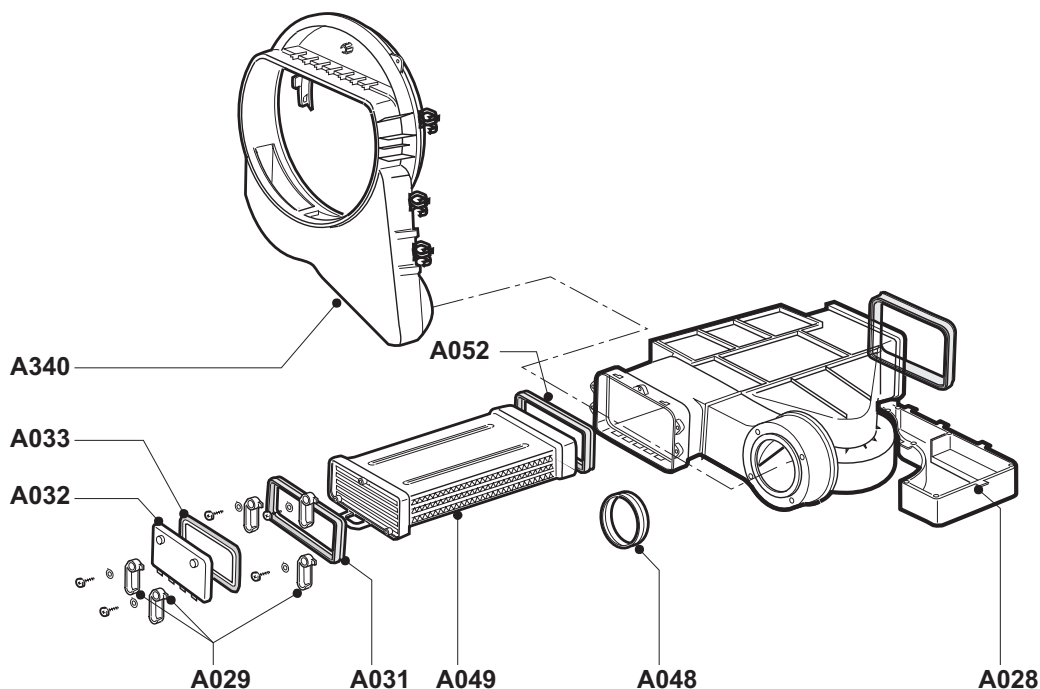
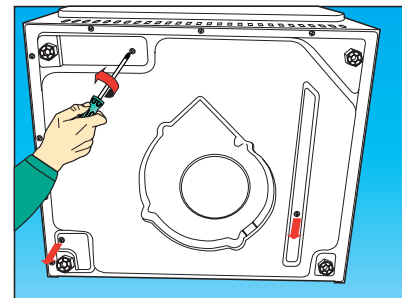

Step 26 Replacing the bottom panel (A260):

- (a) Remove the top cover (B360) as described in **Step 1**.
- (b) Remove the rear panel (B580) following **Step 15**, dismantling only those parts necessary.
- (c) Manually remove the belt (A290) from the drum and motor following **Step 16**.
- (d) Remove the drum assembly (A300) following **Step 18**.
- (e) Remove the five fixing screws (A480) from the front panel, then remove the screws securing the bottom panel (A260).
- (f) Remove the motor (A120) following **Step 22**. Remove the bottom panel (A260) fixing screws and recover the four adjustable feet (A250).
- (f) To re-assemble, follow the same procedure in reverse order, following **Step 16** to replace the belt.

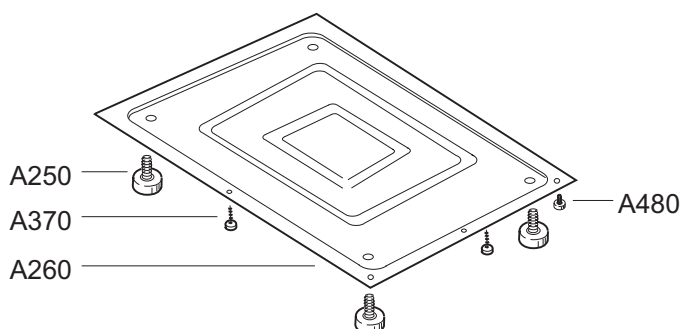

Step 27 Replacing and/or removing the left hand side panel (B040) and/or the right hand side panel (B230):

- (a) Remove the top cover (B360) as described in **Step 1**.
- (b) Remove the rear panel (B580) following **Step 15**, dismantling only those parts necessary.
- (c) Manually remove the belt (A290) from the drum and motor following **Step 16**.
- (d) Remove the drum assembly (A300) following **Step 18**.
- (e) Remove the five fixing screws (A480) from the front panel, then remove the screws securing the bottom panel (A260).
- (f) To re-assemble, follow the same procedure in reverse order, following **Step 16** to replace the belt.

