



GE Appliances

TECHNICIAN'S MANUAL

**INTERIM FRONT SERVICE
DRYER (SCD)**

DDE7900S

DDE7905S

DDG7980S

DDG7985S

Pub. No. 31-2058



TABLE OF CONTENTS

SECTION 1.

INTERIM DRYER (front service SCD)

- GENERAL INFORMATION ----- PG 2.
- DRYER SPECIFICATIONS ----- PG 3.
- NEW INSTALLATION ----- PG 4.
 FOAM BASE REMOVAL
 SUPURR-FLEX DUCTING
 LEVELING LEG CHANGES/ADJUSTMENTS
- DOOR REVERSING ----- PG 5.
- BACKSPLASH AND CONTROL OPERATION ----- PG 6.
- FRONT SERVICE ACCESS ----- PG 7.
- DRUM REMOVAL AND SERVICE ----- PG 8.
- DRUM/FRONT/AND BEARINGS ----- PG 9.
- THERMOSTAT LOCATION AND DUCTING SPECIFICATIONS ----- PG 10.
- AIR FLOW AND SEALS ----- PG 11.

SECTION 2

EXPLODED DIAGRAMS AND PARTS PAGES

GENERAL INFORMATION INTERIM DRYER

A new standard capacity Louisville built dryer is being produced effective 1/94. It replaces the existing model.

Design considerations are in response to needs for feature changes by consumers, compliance with Department of Energy, energy consumption standards, and ease of serviceability.

Feature changes include a patented five-knuckle hinge which allows for a reversible door on some models. This change is shown in the use and care book and is for the consumer to perform to fit their requirements. The door is considerably stiffer than the previous model, which helps to prevent alignment problems. The color matched door handle comes preinstalled in the factory, and the dryers have a Picture frame door for better appearance. Another issue is the consumers need to better match the washer, this has been addressed by having a flush front with the toe kick removed. Air is drawn in from louvers in the rear.

The Department of Energy compliance issues are addressed with the new front service dryers and both gas and electric exceed requirements. The venting specifications are more flexible as a result of having an 8" blower wheel on all models. Both gas and electric dryers comply with 1994 Agency compliance for UL, CSA, and AGA., residential and coin.

Technicians will appreciate the serviceability of the new dryers with most service problems being corrected from the front of the dryer. An integrated front has the drum slides mounted atop a track, which the drum uses as the bearing surface. The arrangement eliminates the need for the drum slides used on previous models, as well as resolve some of the "gap" problems and clothes damage.

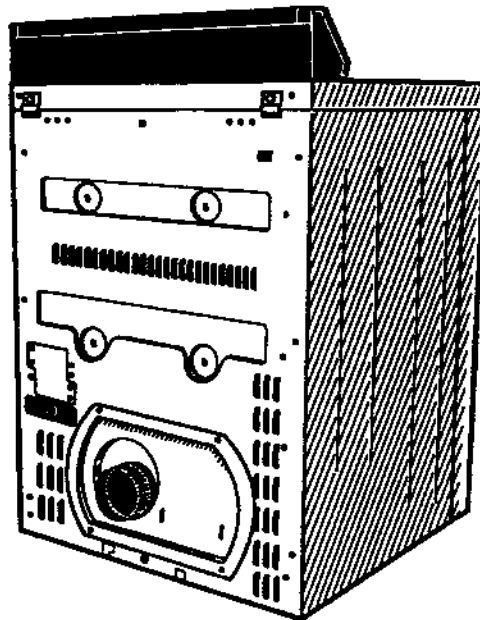

INTERIM DRYER SPECIFICATIONS

ELECTRIC	DDE7900S	DDE7905S
GAS	DDG7980S	DDG7985S
PRODUCTION SITE	LOU.	LOU
BACKSPLASH COLORS	W,A	W,A
CONTROL COLORS	CM	CM
CONTROL STYLE	ROTARY	CLEAN
CABINET COLORS	W,A	W,A
MOTOR	1/4HP	1/4HP
DRUM CAPACITY	LARGE	LARGE
DRUM MATERIAL	PORC.	PORC.
DOOR SWING	REVERS.	REVERS.
HEAT SELECTION/CONTROLS	4-ROT.	4-CLN
END OF CYCLE SIGNAL	SIG VAR	ON/OFF
DRUM LAMP	LAMP	LAMP
LONG DUCT CAPABILITY ELECTRIC	L. DUCT	L. DUCT
LONG DUCT CAPABILITY GAS	NO	NO
OPTIONAL EXTRA CARE	CARE	CARE
TIMER	3-ZONE	3-ZONE
TOTAL CYCLE COUNT	6	6
POWER REQUIREMENTS	208/240V	208/240V
VENTING CAPABILITY ELECTRIC	4 WAY	4 WAY
VENTING CAPABILITY GAS	3 WAY	3 WAY
WARRANTY	1 YR	1 YR

INTERIM DRYER

The front service dryers have a new foam base which allows the installer to "kick" off the base with the legs installed. The Electric dryer shown to the right has four legs, and with the exception of the base, is installed in the same fashion as the previous model.

ELECTRIC DRYER FOAM SHIPPING PADS

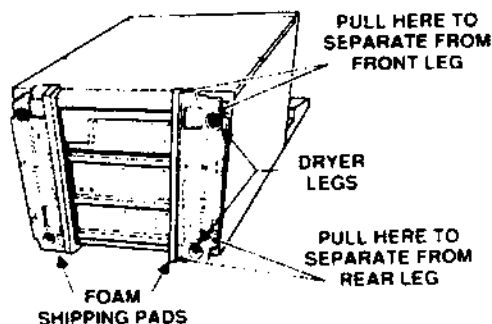

Ducting requirements are shown in the installation instructions (pub. 31-1730) for electric and (pub. 31-1728) for gas. Rigid 4" metal duct is recommended, and if it cannot be used, then SUPPURR-FLEX by DEFLECTO (part number WX8X73) may be used as transition venting between the dryer and the wall connection only. The use of this ducting will affect drying time. To minimize the effect of flexible ducting on dryer performance we recommend the following:

- Use the shortest length possible.
- Stretch the duct to its maximum length.
- Do not crush or collapse.
- SUPPURR-FLEX is not to be used inside the wall, or inside the dryer.
- Avoid resting the duct on sharp objects.
- Venting must conform to local building codes.

**NEVER USE PLASTIC OR OTHER
COMBUSTIBLE DUCTWORK**

GAS DRYER LEVELING LEG LOCATION

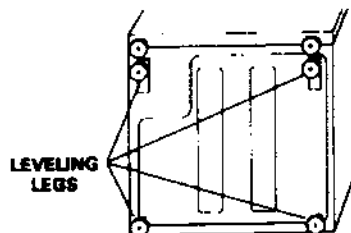

GAS DRYER FRONT LEVELING LEG ADJUSTMENT

On the gas dryer a counter weight has continued to be used as an anti-tip device. In the illustrations at right you will see that the gas dryer has 6 leveling legs. The front legs are to be installed by the installer, and adjusted per the illustration. The extra legs provide further anti-tip stability.



INTERIM DRYER DOOR REVERSING

The need for a larger loading opening and reversible door is addressed with the "S" model front service dryer. The reversible door instructions are shown in the Use and Care manual included with the dryer. The reversible door is a feature, and is not included on all models. Hotpoint, RCA, GE model series 4100, 5100, and 7000 are not reversible.

Reversible models have two door latches, non reversible have a latch and a plug. The door is stiffer than the previous model and has an improved door strike. The door is self aligning.

Customers will need a Phillips screwdriver and are given the following information to reverse the door:

PREPARATION:

1. Open the door and remove the filler plugs from the side of the opening without hinges.
2. With the door completely open, remove the bottom screw from each hinge on the dryer face.

DRYER DOOR:

3. Insert these screws about half way into the top holes, for each hinge, on the opposite side. (Where you removed filler plugs.)
4. Loosen the top screw from each hinge on the dryer face half way.
5. With one hand holding the top of the door and the other hand holding the bottom, remove the door from the dryer by lifting it up and out.
6. Rotate the door 180°. Insert it on the opposite side of the opening by moving the door in and down until the top hinge and the bottom hinge are resting on the top screws inserted in step 3.
7. Remove the remaining screws from the side of the opening from which the door was removed. With these screws, secure each hinge at the bottom.
8. Tighten the two top screws of each hinge.
9. Reinsert the plastic plugs on the side from which the door was removed.

PICTURE WINDOW OPENING AND CONSUMER REVERSIBLE DOOR

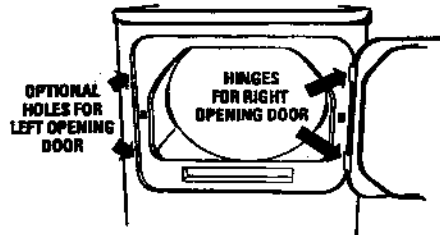

HINGE DETAIL

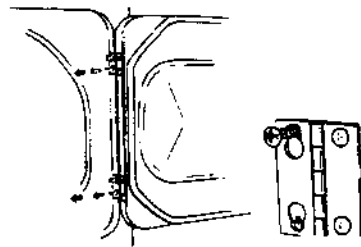

LIFT DOOR UP AND OUT

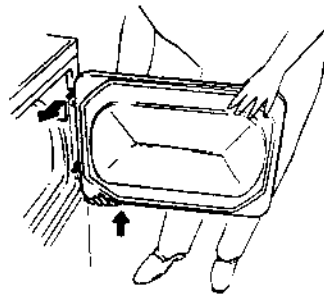

INSERT OPPOSITE SIDE

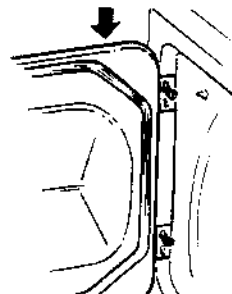

INTERIM DRYER BACKSPLASH AND CONTROL OPERATION

DDE7905S and DDG7985S

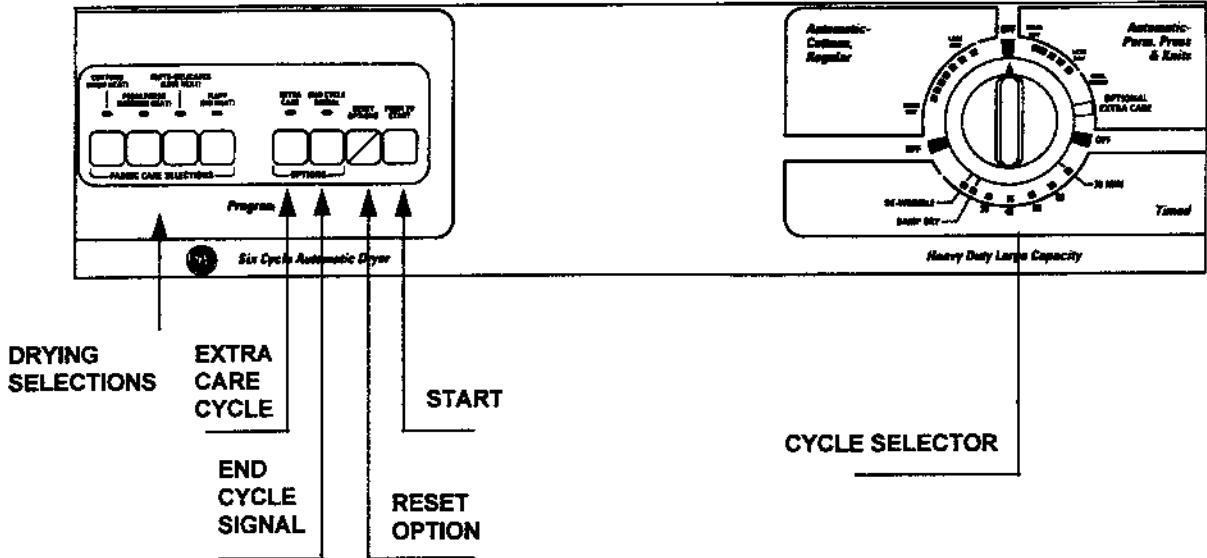

- PRESS PUSH TO START BUTTON
- PRESS PAD TO SELECT EXTRA CARE CYCLE, PROVIDES 15 MINUTES OF NO-HEAT TUMBLING AFTER THE CLOTHES ARE DRY.
- PUSH RESET OPTION TO CHANGE OPTION

DDE7900S and DDG7980S

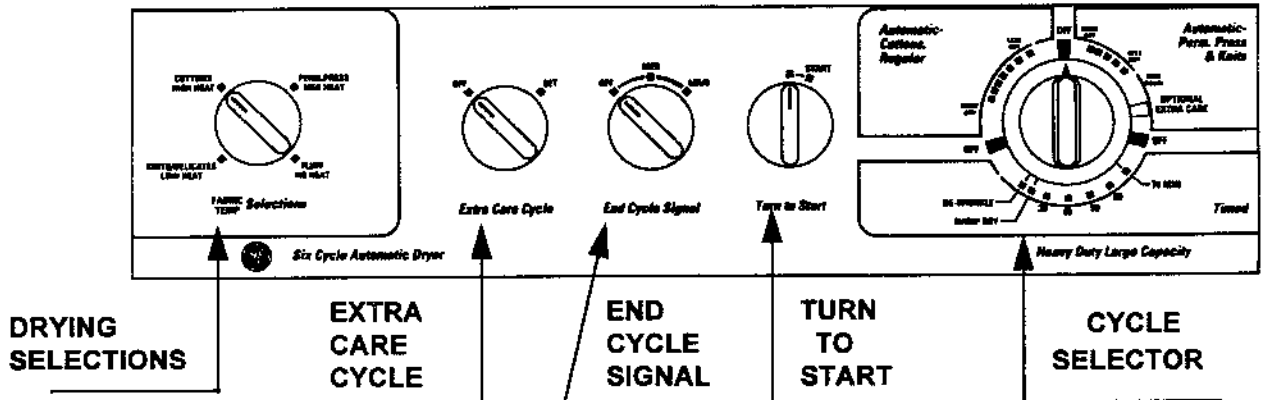

- TURN START KNOB TO START DRYER
- EXTRA CARE TURN KNOB TO SET

INTERIM DRYER SERVICE ACCESS

To service the dryer note that rating plate is on the door opening lower left.

Mini manual is located in the backsplash, and can be accessed in the same manner as the "R" models. (remove two screws on the left and right base of the backsplash, carefully remove and roll backsplash forward.) On gas model dryers the wiring diagram, (left side of the schematic) is permanently glued to the underside of the top, as well as having the mini manual in the location described above.

To service the components accessible from the top:

1. Remove two Quadrex screws that hold top to cabinet. (#2 Phillips works well)
2. Carefully lift top back, and make sure it is supported.

The fronts on the gas and electric models are the same. The gas access panel has been eliminated, and a sight hole on the right side has been used to verify ignition.

To service the front:

1. Remove two 5/16 " hex screws that hold the cabinet to the front, as shown in the illustration at right.
2. Disconnect the harness door switch and light switch connectors from the front (the harness has a strain relief through the top flange of the cabinet side. Make sure you replace the strain relief, or replace it to properly dress the harness away from the dryer drum when reassembling). Illustration is shown on the harness plug at right. When pulling the front away from the cabinet, support the drum with one hand to prevent the drum from dropping hard on the front.
3. Tip the dryer front away from the top of the dryer, while resting the bottom of the front on the support pivots.

TOP SCREWS

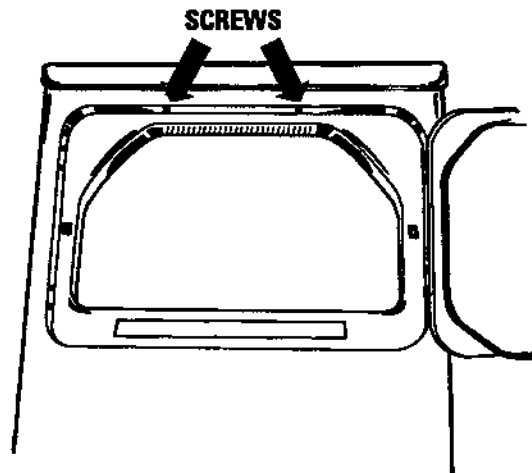

REMOVE TWO SCREWS CABINET TO FRONT

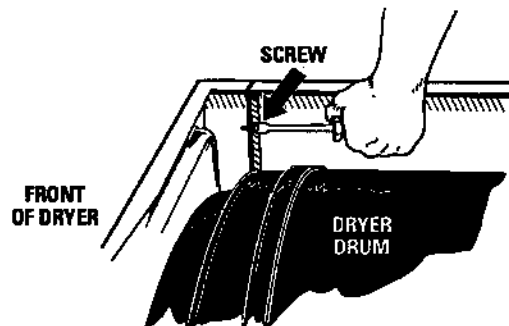

HARNESS DISCONNECT CABINET TO FRONT

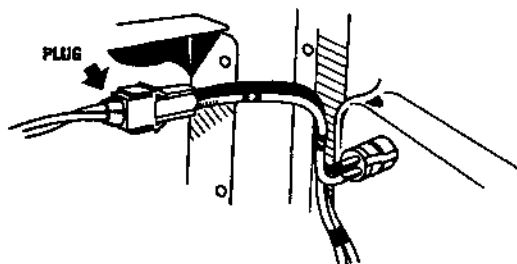

INTERIM DRYER DRUM REMOVAL AND SERVICE ACCESS

BELT IN PLACE

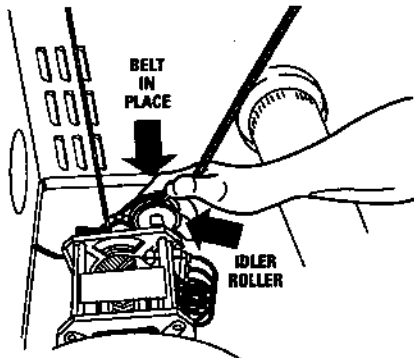

RELEASE IDLER ARM

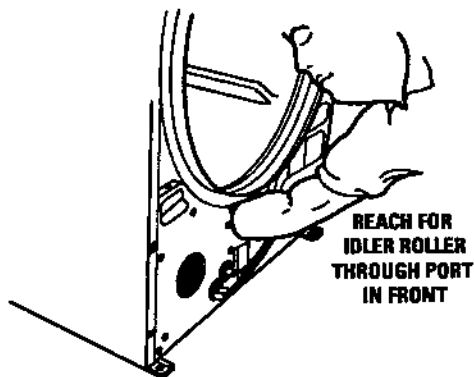

PULL ROLLER DOWN

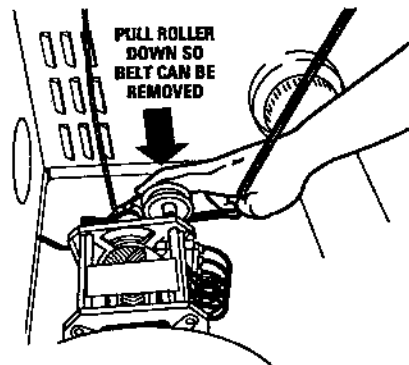

IDLER ARM AND BELT SWITCH (REAR VIEW)

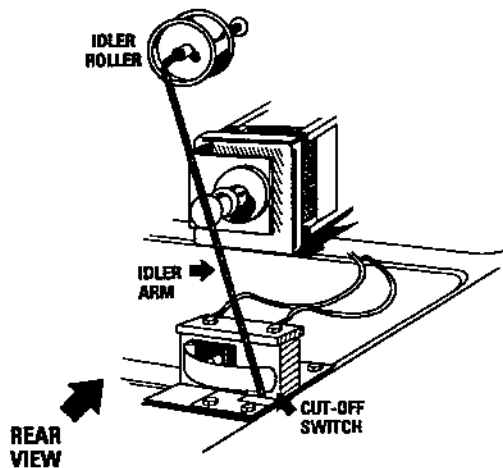

REMOVE BELT

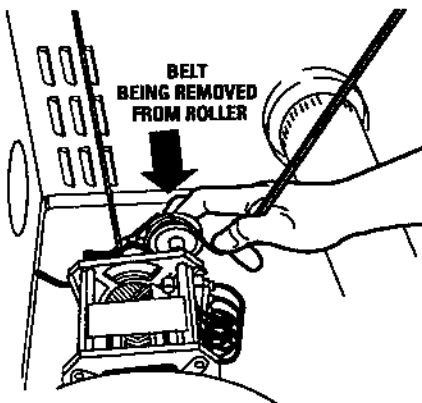

Service for the heater housing, motor, thermostats, internal exhaust, idler arm, and belt switch are now easily accessible.

Addition of new belt switch provides shut off of motor when belt breaks.

To service belt switch:

1. Repeat steps above including drum removal.
2. Remove two 1/4" hex screws to release belt switch for replacement. Use care when replacing not to damage switch actuator arm.

INTERIM DRYER BEARINGS

To remove drum:

1. With front removed use cut-out port in the center of front to reach idler arm.
2. Push the idler arm to the right to release tension, at the same time pushing the belt off the idler roller with your thumb. Slowly release the idler arm.
3. With belt disconnected, grasp the drum with one hand on the front drum lip and on the rear drum head, and lift it out and away from the dryer.

Service for the heater housing, motor, thermostats, internal exhaust, idler arm, and belt switch are now easily accessible.

The redesign to accomplish front service had several positive benefits. The customer complaint of clothes damaged like shirt collar tips due to excessive gap has been eliminated. The front shown below has the inside flange of the drum riding on the slides shown, reducing gap.

To remove drum slide bearings:

1. Remove two top to cabinet screws.
2. Lean front forward.
3. Pull drum bearing up (as shown) and lift out.
4. To replace reverse procedure taking care to align bearing hole with embossment.

DRUM SLIDE BEARING SURFACE

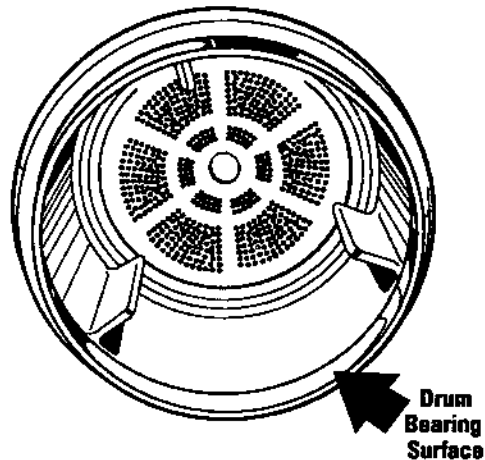

DRYER FRONT DRUM BEARING REPLACEMENT

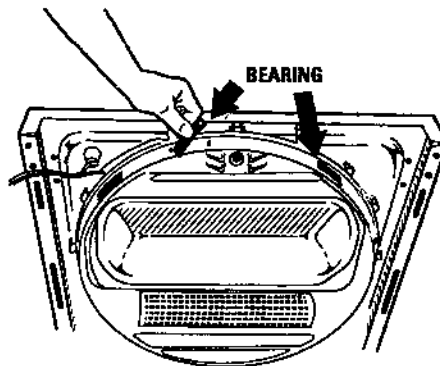

INTERIM DRYER THERMOSTAT LOCATION

ELECTRIC DRYER THERMOSTAT

OPERATION:

HIGH LIMIT: Cycles both heater coils for restricted air flow conditions. It also advances timer when tripped.

SAFETY THERMOSTAT: Shuts down the entire system when it detects abnormal conditions.

INLET CONTROL THERMOSTAT: Opens outer heater coil when airflow is restricted. (Dryer runs at half heat, slow drying, but continues to dry.) Does not advance timer when tripped. Reduces drum inlet temperatures and provides excellent performance at low airflow conditions.

HI DRUM OUTLET, LOW DRUM OUTLET: Operating thermostats.

ELECTRIC THERMOSTAT LOCATION

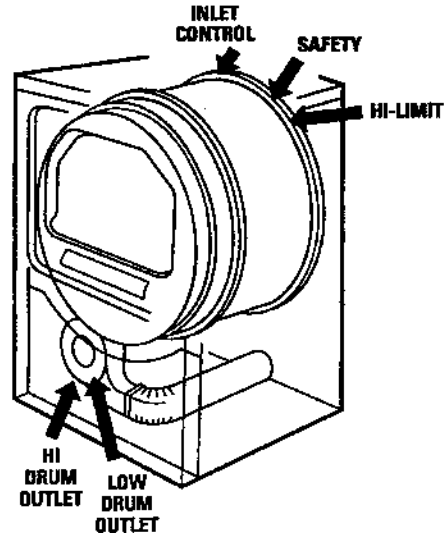

ELECTRIC DRYER DUCTING SPECIFICATIONS

NUMBER OF 90° TURNS	EXHAUST HOOD TYPE		
	A	B	
0	90 FT.	60 FT.	MAXIMUM LENGTH OF 4" DIA. RIGID METAL DUCT
1	60 FT.	45 FT.	
2	45 FT.	35 FT.	
3	35 FT.	25 FT.	
4	25 FT.	15 FT.	
0	55 FT.	45 FT.	MAXIMUM LENGTH OF 4" DIA. FLEXIBLE METAL DUCT
1	40 FT.	30 FT.	
2	30 FT.	20 FT.	
3	20 FT.	15 FT.	
4	15 FT.	10 FT.	

GAS DRYER DUCTING SPECIFICATIONS

NUMBER OF 90° TURNS	EXHAUST HOOD TYPE		
	A	B	
0	35 FT.	30 FT.	MAXIMUM LENGTH OF 4" DIA. RIGID METAL DUCT
1	25 FT.	20 FT.	
2	15 FT.	10 FT.	
0	30 FT.	15 FT.	MAXIMUM LENGTH OF 4" DIA. FLEXIBLE METAL DUCT
1	20 FT.	10 FT.	
2	10 FT.	—	

GAS THERMOSTAT LOCATION

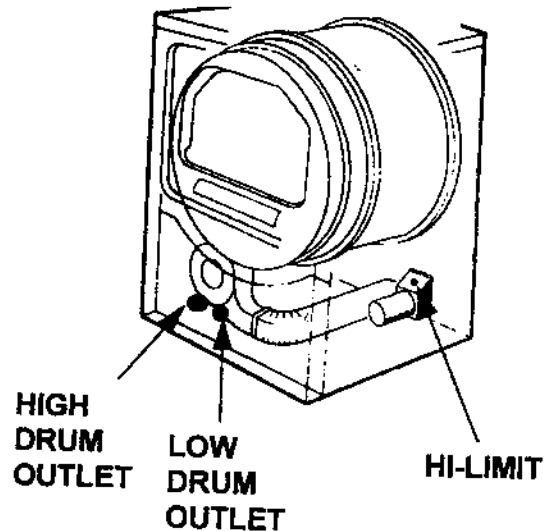

INTERIM DRYER AIR FLOW AND SEALS

Proper air flow through the dryer is essential for normal operation of the temperature control and safety systems. This new model draws air in from louvers in the rear. (see illustration)

LOUVERS DRAW AIR IN FROM REAR

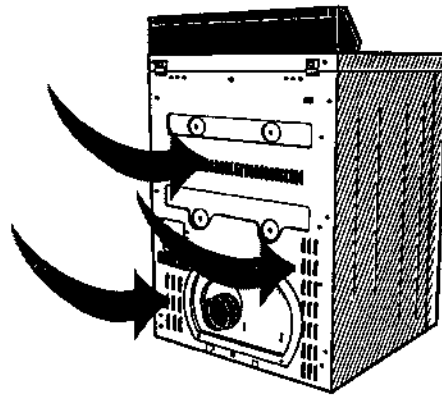

GAS:

Air is **PULLED** into the cabinet. (see illustration). A portion of this air is heated by the gas burner in the combustion chamber and is pulled up the rear duct into the diffuser. The remainder of this air enters the diffuser directly through vents and is mixed with the heated air. This hot mixed air is **PULLED** into the drum rear, across the clothes load, through the lint trap and down the trap duct into the blower. From the blower, the air is **PUSHED** out the exhaust system.

GAS DRYER

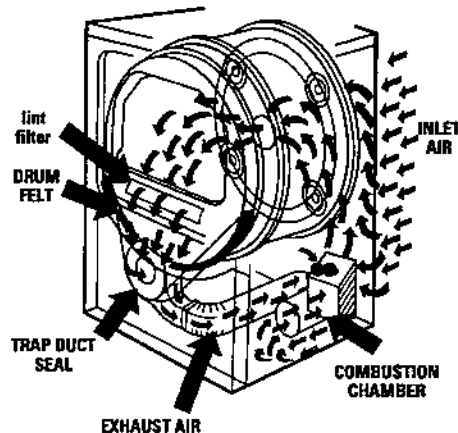

Any air leaks between the air inlet and blower such as rear duct, diffuser, or trap duct to cabinet front sealing in improper temperatures. The air being pulled down the trap duct across the drum outlet thermostat will be cooler than normal, giving this thermostat a false indication (delayed or no-trip). Leaks ahead of the blower will also reduce the volume of air through the combustion chamber causing cycling of the inlet hi-limit thermostat.

ELECTRIC:

Air is **PULLED** into the cabinet and drawn up across the heaters located behind the drum in the heat diffuser. This hot air is **PULLED** into the drum rear, across the clothes load, through the lint trap and down the trap duct into the blower. From the blower the air is **PUSHED** out of the exhaust system.

ELECTRIC DRYER

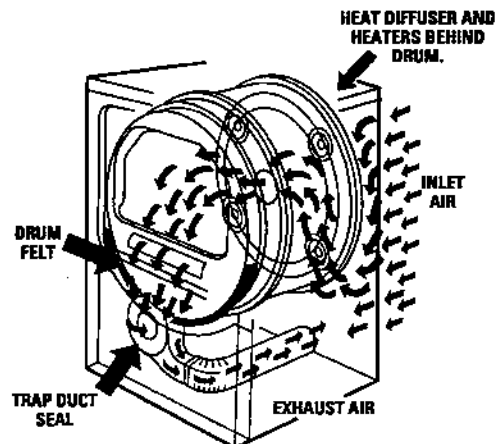

REPLACEABLE FELT SEAL

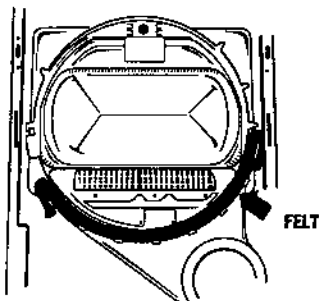

MODEL DDE7900SAL

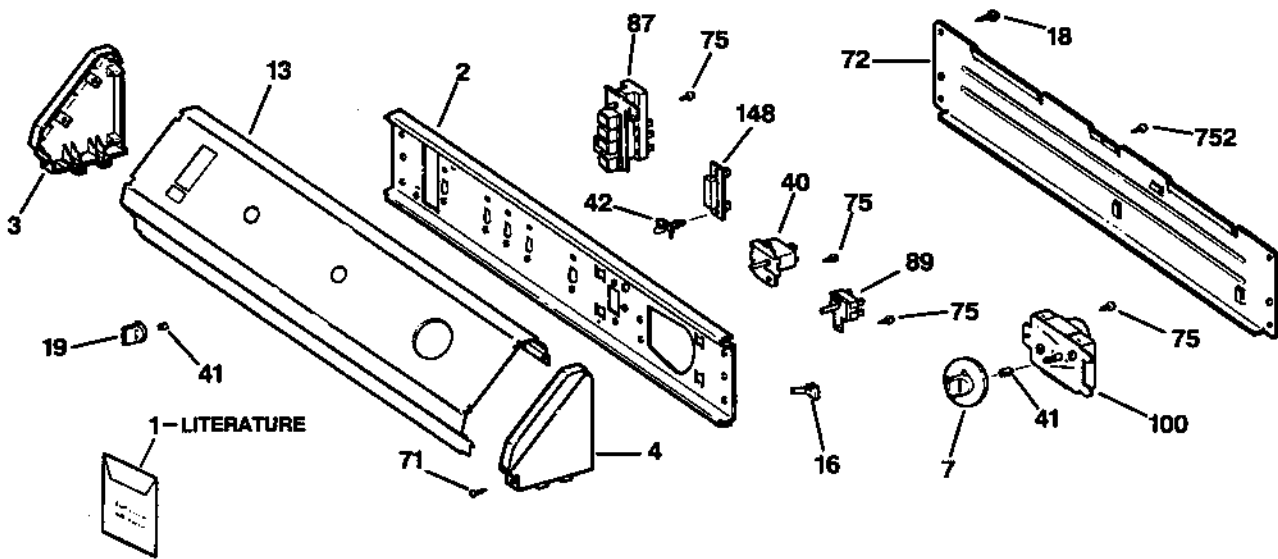

MODEL DDE7900SAL

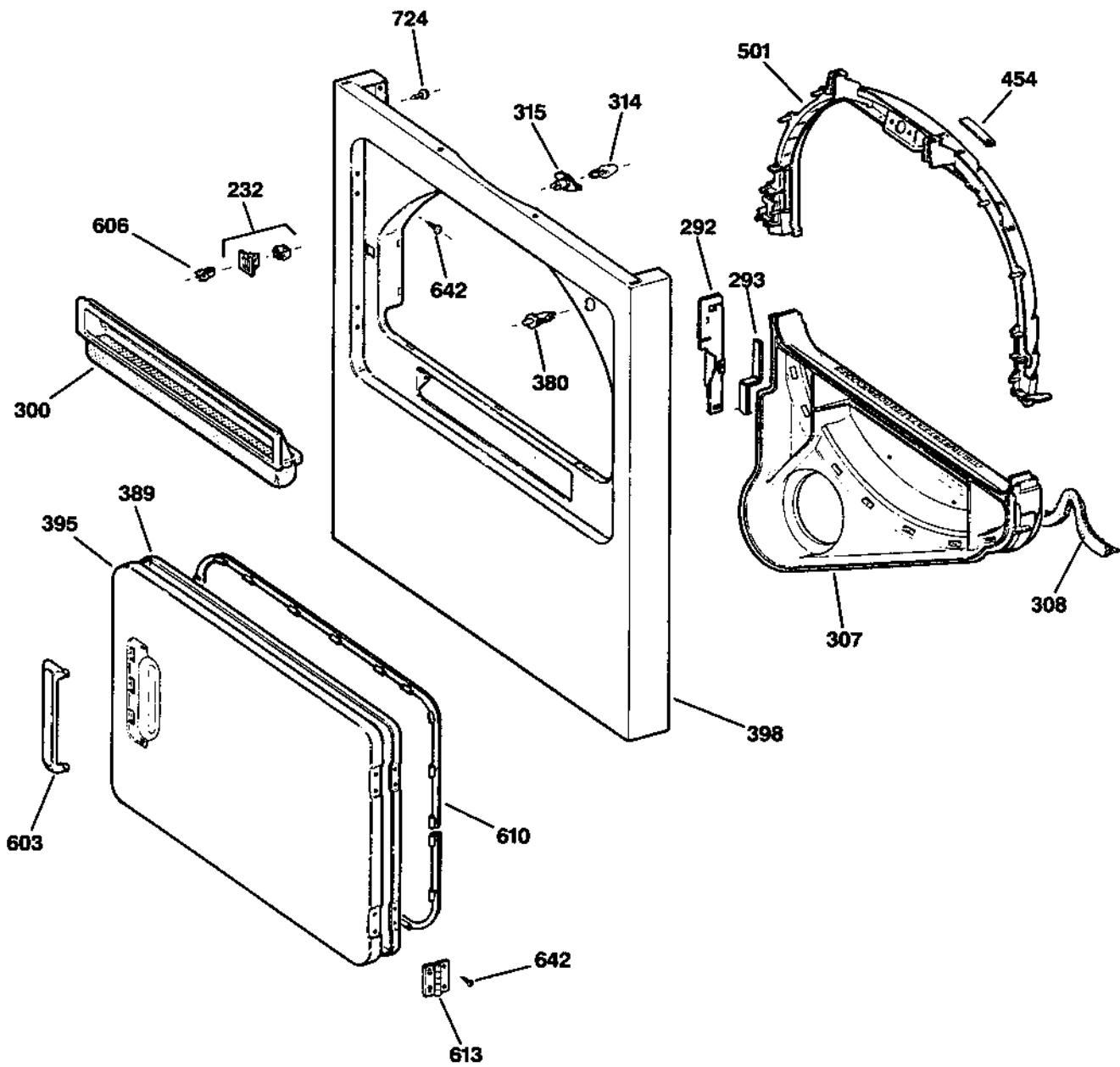

(ART NO. WE7526) C

MODEL DDE7900SAL

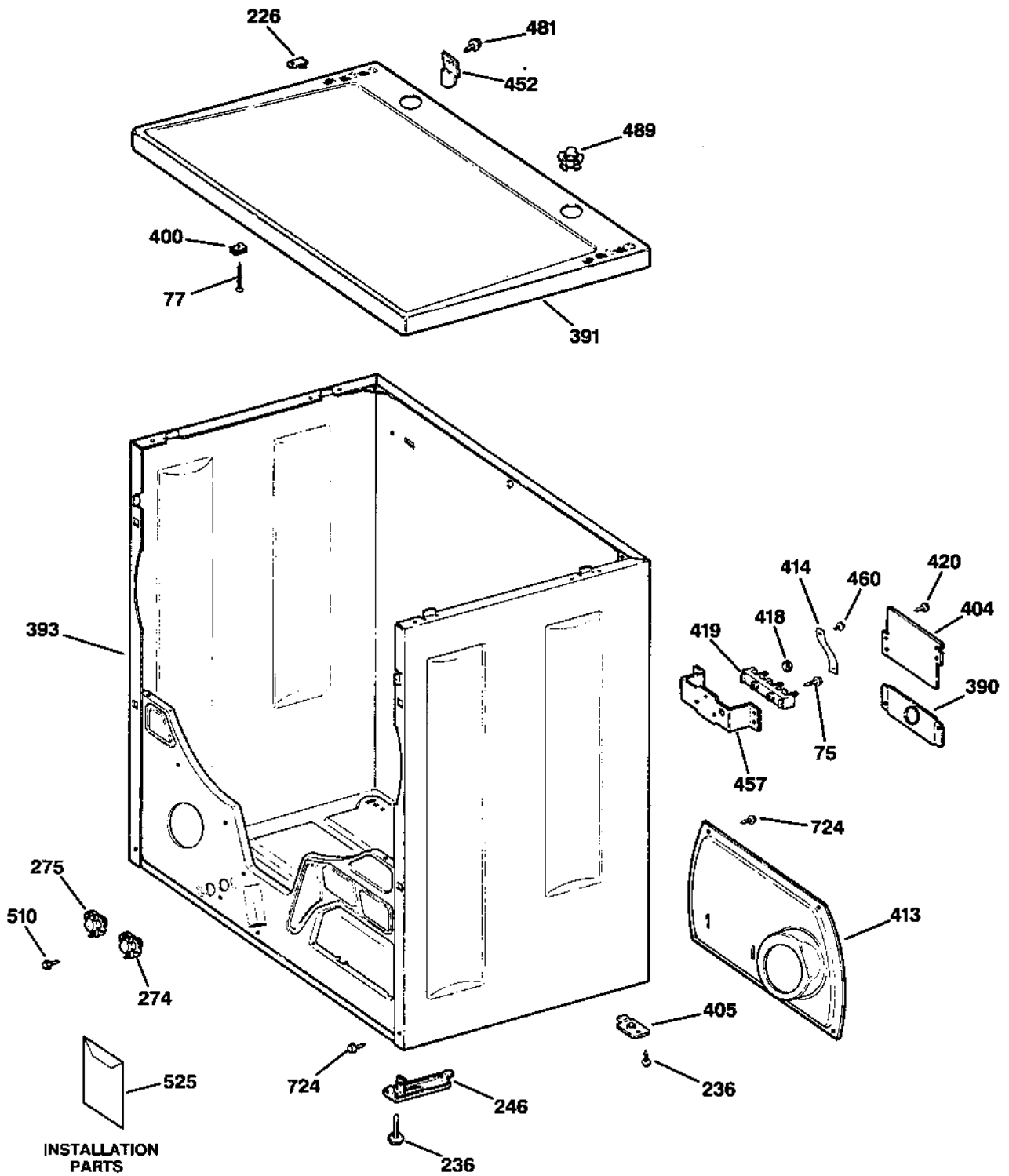

MODEL DDE7900SAL

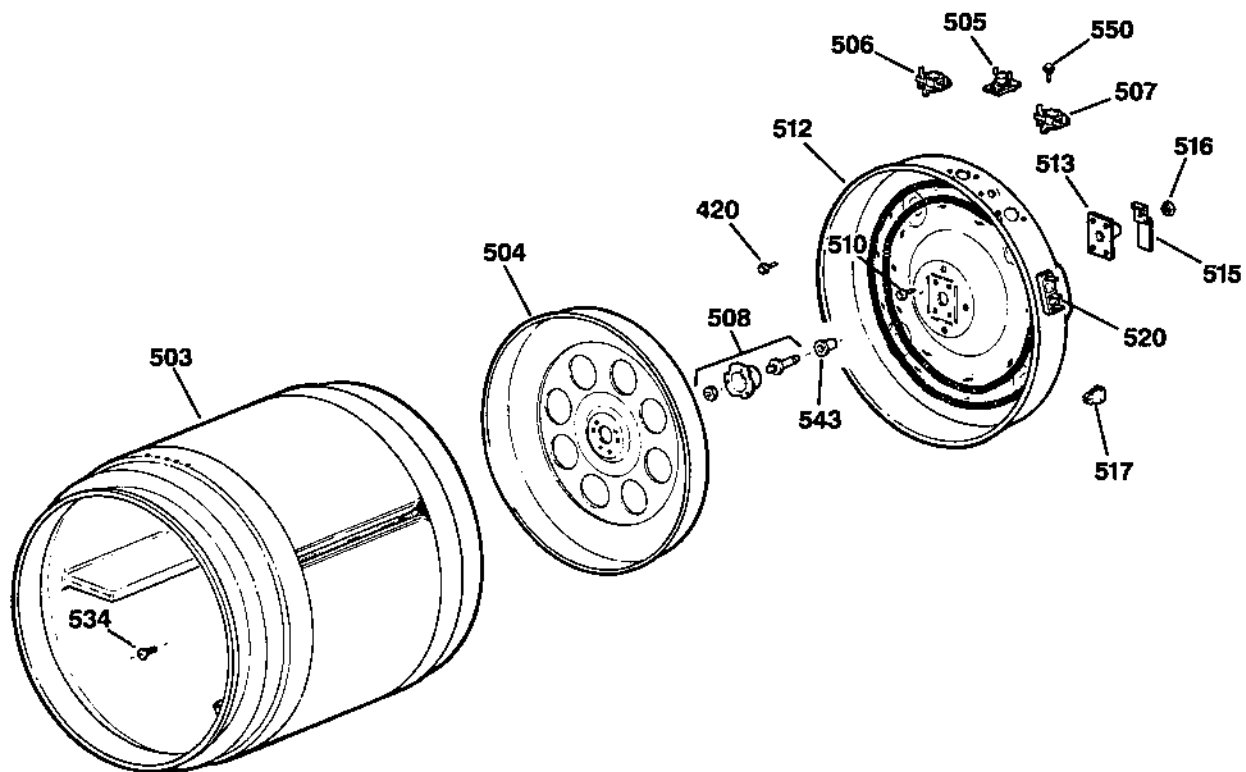

BLOWER & DRIVE ASSEMBLY

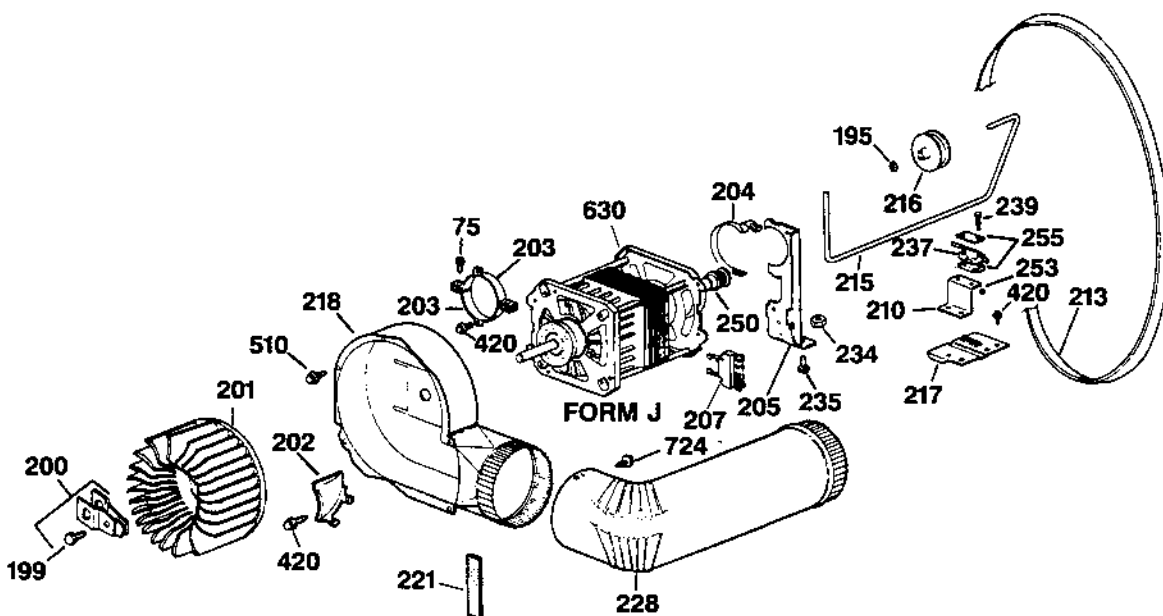

D
D
E
7
9
0
0
S
A
L

REF. NO.	PART NO.	PART DESCRIPTION	
1	49-9706	MANUAL USE & CARE	1
	31-1702	PM INSTRUCTION INSTAL	1
	PUB# 31-2677	PM SHEET MINI MAMUAL	1
2	WH46X0312	PLATE MOUNTING	1
3	WH42X2225	END CAP L.H. BK	1
4	WH42X2226	END CAP R.H. BK	1
7	WE01X1178	KNOB & CLIP TIMER	1
13	WE19X0917	SWITCH TRIM	1
16	WH02X1151	CLIP GROUND	1
18	WH02X1152	SCREW 8-16X5/8 HX	4
19	WH01X2274	KNOB & CLIP ASM	2
35	WE04X0784	SWITCH PUSHBUTTON	1
40	WE04X0798	BUZZER	1
41	WE01X0980	U CLIP	3
42	WE02X0373	SUPPORT CIRC BOARD	2
70	WH02X0937	SCREW 10-15X7/16 HXW	2
71	WH02X1153	SCREW 8-18X1 PH	2
72	WH46X0311	PANEL ACCESS	1
77	WE02X0377	SCR 8-18 AB OVP 1.75 S	2
85	WE04X0779	SWITCH ROTARY	1
100	WE04X0791	TIMER	1
148	WE04X0799	RESISTOR & BOARD ASM	1
178	WH02X0939	SCR 6-19 PT HX 1/4 S	2
195	WH02X0885	NUT	1
199	WE02X0280	SCR 14-10 A HX 1 S	1
200	WE01X0688	CLAMP	1
201	WE16X0017	WHEEL BLOWER	1
202	WE01X0689	BAFFLE BLOWER HOUSING	1
203	WE13X0182	STRAP MOTOR	2
204	WE01X0921	STRAP MOTOR	1
205	WE13X0161	BRACKET MOTOR	1
207	WE04X0710	SWITCH-START FORM J MTR.	1
210	WE13X0198	BRACKET BELT SW	1
213	WE12X0082	BELT DRIVE	1
215	WE03X0069	SPRING IDLER	1
216	WE12X0092	PULLEY IDLER	1
217	WE13X0159	BRACKET IDLER SPRING	1
218	WE14X0134	HOUSING BLOWER	1
226	WH02X1154	GROMMET SCREW	2
228	WE14X0213	ELBOW EXHAUST	1

D
D
E
7
9
0
0
S
A
L

REF. NO.	PART NO.	PART DESCRIPTION	
232	WE01X1032	LATCH DOOR	2
234	WE02X0154	PALNUT	2
235	WE02X0194	SCR	2
236	WE02X0355	SCREW LEVELLING 5/16-24	4
237	WE04X0532	SWITCH ASM	1
239	WE02X0376	SCR 4-40 M HXW 3/4 S	2
246	WE01X1190	FOOT LEVELING	2
250	WE12X0041	PULLEY DRIVE	1
253	WE02X0245	NUT STOP	2
255	WE01X1191	SHIELD SWITCH	2
274	WE04X0811	THERMOSTAT ASM	1
275	WE04X0812	THERMOSTAT ASM	1
292	WE13X0199	SUPPORT SPANNER	1
293	WE09X0110	SEAL DUCT FILTER	1
300	WE18X0054	FILTER ASM	1
308	WE09X0108	FELT DUCT	1
314	WE04X0718	LAMP	1
315	WE04X0810	SOCKET LAMP	1
380	WE04X0197	SWITCH ASM PUSH BUTTON	1
389	WE10X0325	LINER DOOR	1
390	WE01X1174	PLATE	1
391	WE20X0761	TOP WH	1
393	WE20X0774	BASE & WRAPPER ASM WH	1
395	WE10X0326	PANEL DOOR	1
398	WE20X0775	FRONT CABINET	1
400	WE02X0134	CLIP	4
404	WE01X0425	PLATE	1
405	WE01X0468	PLATE LEVELING SCREW	2
413	WE14X0212	PANEL ACCESS	1
414	WE01X0339	GROUND STRAP	1
418	WZ07X0031	NUT	4
419	WE04X0168	BLOCK TERMINAL	1
420	WH02X0893	SCR 10-16 HX 3/8 S	9
432	WL02X0071	NUT	7
452	WE01X1094	BRACKET HINGE	2
454	WE03X0076	BEARING SLIDE	3
457	WE13X0162	BRACKET TERMINAL BLOCK	1
460	WZ04X0264	SCR 10-16 AB HXW 1 S	2
461	WZ05X0158	SCREW 8-32X3/8	2
481	WH02X0967	SCR 12-14 AB HXW 1/2 S	2

D
D
E
7
9
0
0
S
A
L

REF. NO.	PART NO.	PART DESCRIPTION	
489	WH01X2572	SLEEVE SPLIT	1
501	WE03X0077	SUPPORT FRONT BRG	1
503	WE21X0071	DRUM ASM	1
504	WE14X0086	DEFLECTOR	1
505	WE04X0730	T'STAT ASM SAFETY	1
506	WE04X0813	THERMOSTAT ASM	1
507	WE04X0584	THERMOSTAT L258-50	1
508	WE03X0039	SHAFT & BRACKET ASM	1
510	WE02X0263	SCREW 10-16X1/2 HW	23
512	WE11X0095	HEATER ASM	1
513	WE01X0461	BEARING RETAINER	1
515	WE01X1172	GROUND STRAP ASM	1
516	WE02X0169	NUT SHEET METAL	1
517	WE01X1176	INSULATOR CERAMIC	26
520	WE01X1177	TERMINAL RECEPTACLE	1
534	WE02X0153	SCREW	3
543	WE03X0074	BEARING DRUM SHAFT	1
550	WE02X0281	SCR 8-15 HX 3/8 S	8
603	WE01X1188	HANDLE DOOR	1
606	WE01X1192	STRIKE DOOR	1
610	WE09X0109	GASKET DOOR	1
613	WE01X1189	HINGE	2
630	WE17X0032	MOTOR ASM	1
642	WE02X0378	SCR 8-18 AB OVP 1/2 S 6H	14
679	WZ05X0155	SCR 8-18 AB HX 3/8 SS	2
724	WZ04X0288	SCR 10-16 AB HW 1/2S #8	2
875	WH02X0930	SCR 8-18 AB HW 3/8 S	14
907	WD09X0206	PUSHBUTTON	5