

# 36" GLASS SEALED-BURNER GAS COOKTOP

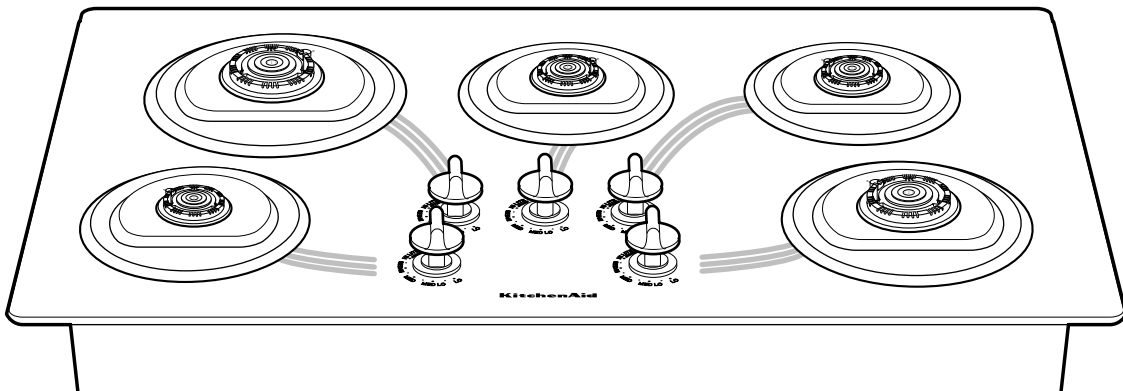

**MODEL KGCT366E**

**JOB AID  
Part No. 4317225**

## **FORWARD**

This Job Aid will introduce the technician to the 36" Glass Sealed-Burner Gas Cooktop, Models KGCT366EBL, KGCT366EWH, & KGCT366EAL. This Job Aid is a reference guide for the experienced technician. It is not designed as a replacement to basic training. This Job Aid does not replace the Service Manual or the Use and Care Guide. It is designed to be used in conjunction with these manuals.

## **OBJECTIVE**

The objective of this Job Aid is to have the experienced appliance technician become familiar with the operation and service of the 36" Glass Sealed-Burner Gas Cooktop. It is designed as reference material and is not a replacement for basic training.

**WHIRLPOOL CORPORATION assumes no responsibility for any repair made on our products by anyone other than Authorized Factory Service Technicians.**

## **WARNING**

### **Electrical Shock Hazard**

Disconnect the cooktop's line cord plug from the wall receptacle before you service any of the components inside the unit. Failure to do this could result in violent electrical shock.

## **VOLTAGE CHECKS**

When making voltage checks, be sure to observe the following precautions:

- 1. The floor must be dry. Water and dampness increase the chances of electrical shock.**
- 2. Set the voltmeter correctly for the voltage being measured.**
- 3. Touch only the insulated parts of the meter probes.**
- 4. Touch the component terminals, or wires, with the meter probe tips only.**
- 5. Touch the meter probe tips only on the terminals being checked. Touching other components could damage good parts.**

## **PARTS QUALITY**

An important step in the appliance repair procedure is the selection of FSP<sup>®</sup> (FACTORY SPECIFICATION PARTS) as replacements. Use of "fits-all," or "look alike" parts could result in early parts failure, safety hazard, or substandard performance of a WHIRLPOOL appliance. It could also result in an unnecessary repeat of your repair efforts.

To be sure that the part(s) you purchase meet the exacting quality standards used to build every new WHIRLPOOL appliance, be sure to ask for genuine FSP replacement parts, as specified for your model. "FSP" is a registered trademark of WHIRLPOOL CORPORATION.

You can buy your genuine FSP replacement parts from any authorized WHIRLPOOL Parts Distributor.

**WHIRLPOOL CORPORATION assumes no responsibility for any repair made on our products by anyone other than qualified TECH-CARE<sup>®</sup> Service Technicians.**

## IMPORTANT SAFETY INFORMATION

This Job Aid is intended for factory-service technicians only. We recommend that customers DO NOT service their own units, because of the complexity and risk of high-voltage electrical shock

### **WARNING**

**If the information in this Job Aid is not followed exactly, a fire or explosion may result causing property damage, personal injury or death:**

Do Not store or use gasoline or other flammable vapors and liquids in the vicinity of this or any other appliance.

#### **WHAT TO DO IF YOU SMELL GAS:**

- Do Not try to light any appliance.
- Do Not touch any electrical switch; Do Not use any phone in your building.
- Immediately call your gas supplier from a neighbor's phone. Follow the gas supplier's instructions.
- If you cannot reach your gas supplier, call the fire department.

Installation and service must be performed by a qualified installer, service agency or the gas supplier.

### **WARNING**

#### **Fire Hazard**

Do not obstruct the flow of combustion and ventilation air.

#### **Electrical Shock Hazard**

*It is the customer's responsibility to.*

- Contact a qualified electrical installer.
- Assure that electrical installation is adequate and in conformance with the National Electrical Code, ANSI/NFPA 70—latest edition\*, and all local codes and ordinances.
- Take special care when drilling holes into the wall for venting or electrical wiring. Electrical wires may be concealed behind the wall covering.
- Disconnect the power to any electrical circuits that could be affected by the installation of this cooktop.

Failure to do so could result in fire, electrical shock, or other personal injury.

#### **Personal Injury Hazard**

To eliminate the risk of burns or fires, do not install cabinets or store things above the cooktop. If cabinets are already installed above the cooktop, install a range hood to the bottom of the cabinet to prevent reaching over the heated cooking surface. The range hood should stick out a minimum of 5-inches (12.7 cm) from the front of the cabinets.

Reaching over a heated cooking surface could result in a serious burn or other injury.

- Copies of the standards listed above may be obtained from:

National Fire Protection Association  
Batterymarch Park  
Quincy, Massachusetts 02269

# Table of Contents

Model & Serial Number Location .....	Page 2
Component Locations .....	Page 2
Component Access .....	Page 3
Removing The Components .....	Page 4
Wiring Diagram .....	Page 8
Troubleshooting Chart .....	Page 9
Warranty .....	Page 10

# MODEL & SERIAL NUMBER LOCATION

The Model/Serial Number Plate is located on the burner box.

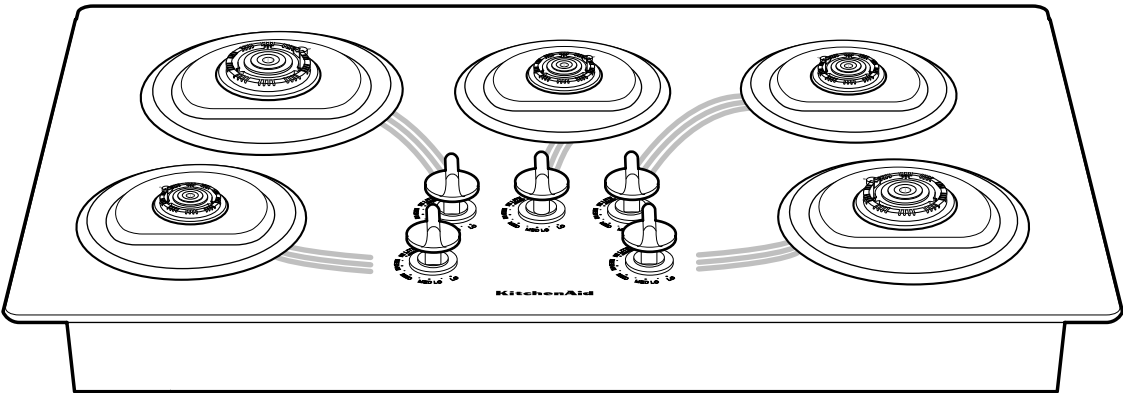

Model/Serial Plate  
(Underside Of Cooktop)

# COMPONENT LOCATIONS (View From Under The Cooktop)

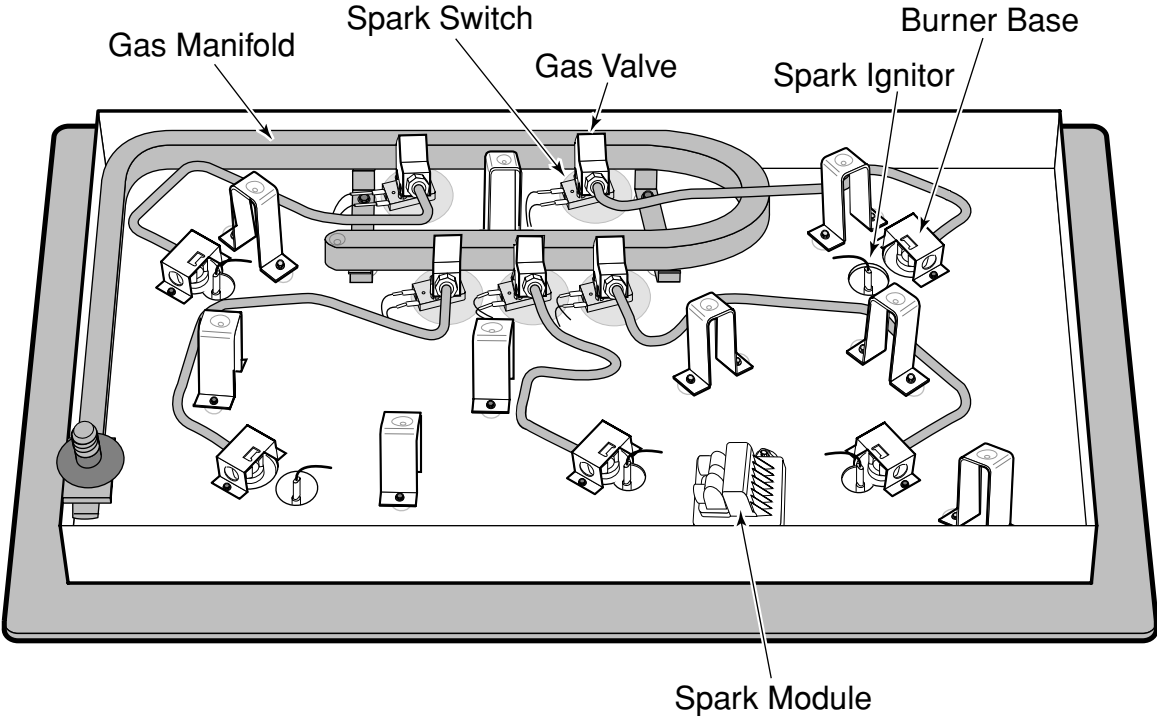

# COMPONENT ACCESS

## Tools Required:

1/4" Nut Driver

To remove the components for servicing, use the following procedure:

1. Remove the cooktop from the cabinet and turn it over.
2. Remove the hardware (screws and washers) from the burner box cover and lift the cover off the burner box, then disconnect the three power cord leads (see the inset), and remove the burner box cover. You can now access all of the components for service.

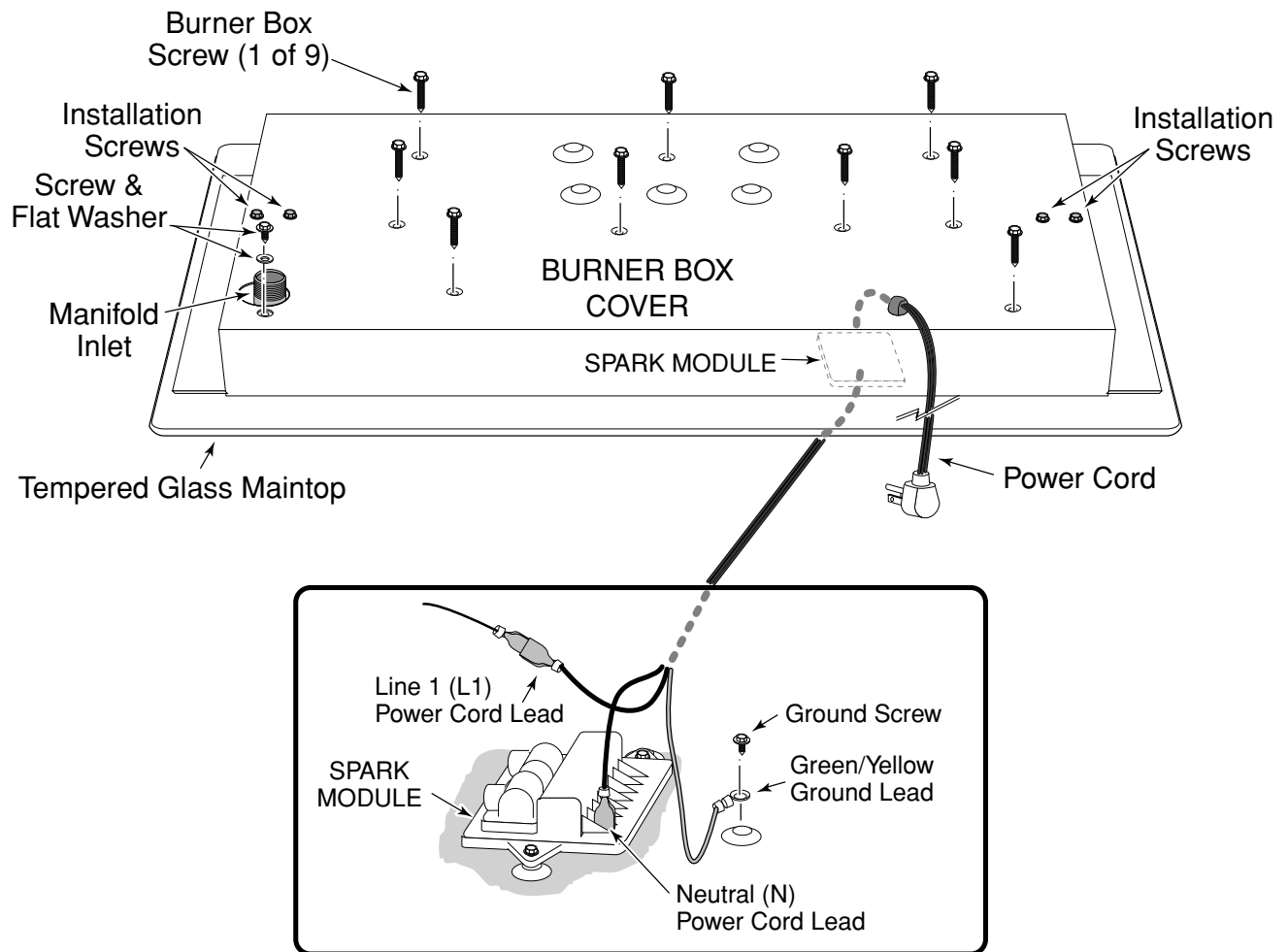

# REMOVING THE COMPONENTS

## REMOVING A GAS VALVE & SPARK SWITCH

### Tools Required:

1/4" Nut Driver

1/2" Open End Wrench

1. Turn off the gas and the electrical supply to the cooktop.
2. Remove the gas regulator and remove the cooktop from the cabinet.
3. Remove the knob from the control you wish to service and unsnap the bezel from the tempered glass.
4. Turn the cooktop over and remove the burner box cover (see page 3).
5. From the bottom of the unit, remove the hex-head screw and rubber washer from the gas valve and disconnect the gas line fitting, then remove the valve from the manifold, and pull the spark switch and rubber cover from the valve body.
6. Reassemble the unit.

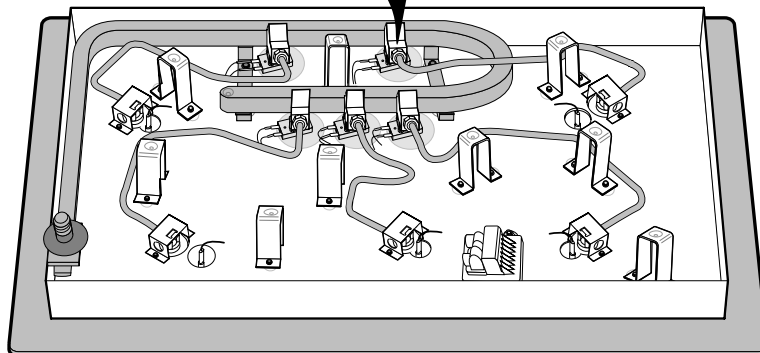
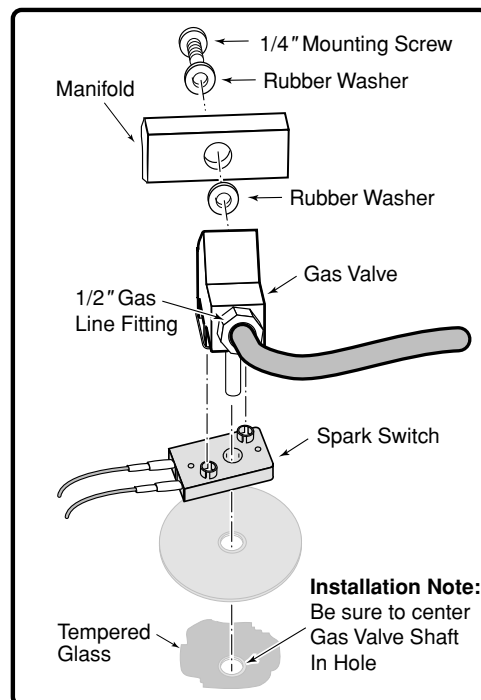



## REMOVING THE SPARK MODULE

### Tools Required:

1/4" Nut Driver

1. Turn off the gas and the electrical supply to the cooktop.
2. Remove the gas regulator and remove the cooktop from the cabinet.
3. Turn the cooktop over and remove the burner box cover (see page 3).
4. Remove the three screws from the spark module and remove it, then mount the new module in its place.
5. Disconnect the wires from the terminals of the old spark module and reconnect them to the same terminal locations on the new module.
6. Reassemble the unit.

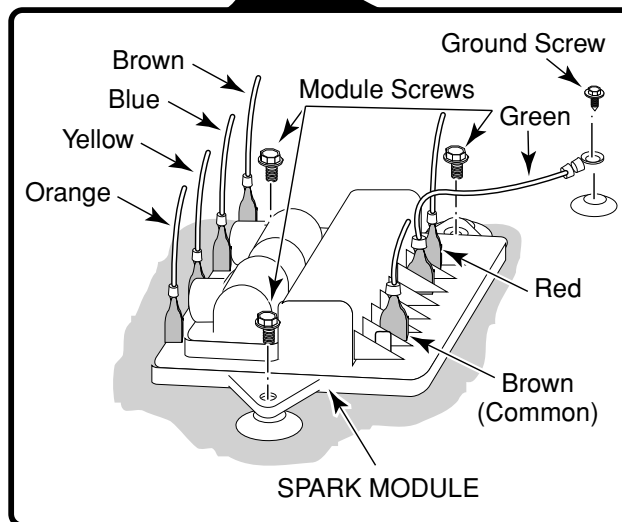
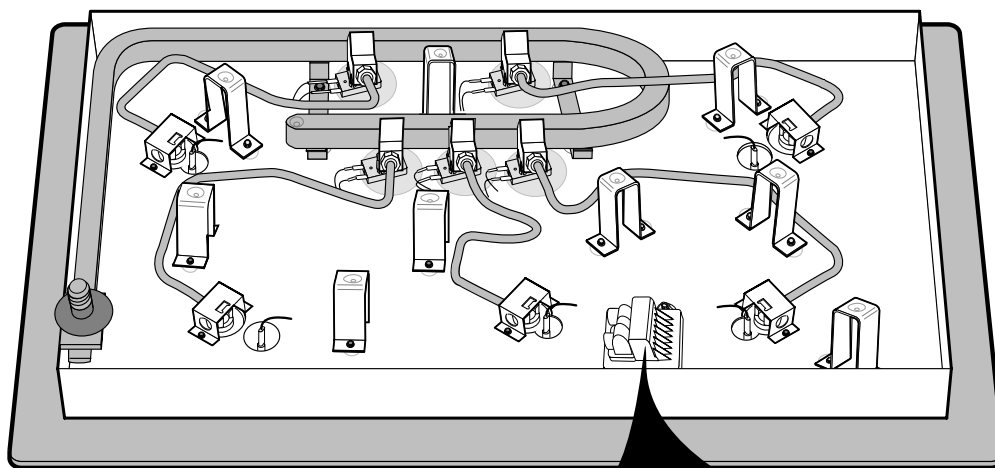

## **REMOVING A SURFACE BURNER & SPARK IGNITOR**

### **Tools Required:**

- 1/4 " Nut Driver
- 1/2 " Open End Wrench
- 3/8 " Open End Wrench

1. Turn off the gas and the electrical supply to the cooktop.
2. Remove the gas regulator and remove the cooktop from the cabinet.
3. Turn the cooktop over and remove the burner box cover (see page 3).

Refer to the illustration on the next page.

4. Disconnect the spark ignitor wire from the pin for the surface burner you wish to service.
5. Disconnect the gas line fitting from the surface burner that you wish to remove, and remove the hex-head screw from the surface burner bracket , then remove the burner and mounting plate from the cooktop glass.
6. Unclip the spark ignitor and remove it from the surface burner, then remove the three hex-nuts from the surface burner and remove it from the plate.
7. Reassemble the unit.

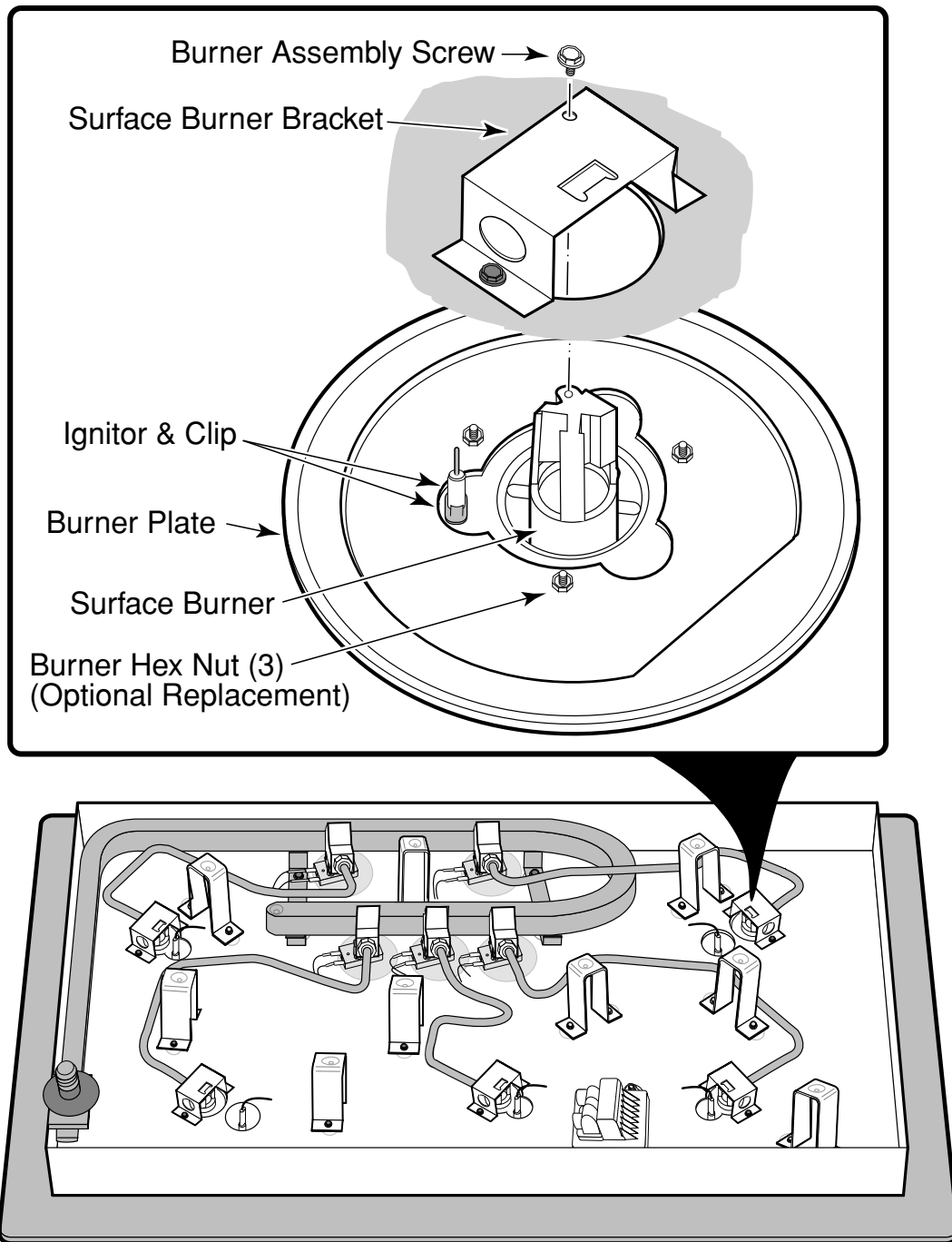

## REMOVING THE TEMPERED GLASS

1. Turn off the gas and the electrical supply to the cooktop.
2. Remove the gas regulator and remove the cooktop from the cabinet.
3. Remove the knobs and unsnap the bezels from the tempered glass.
4. Turn the cooktop over and remove the burner box cover (see page 3).
5. To remove the tempered glass, remove the five surface burner assemblies, (see page 6), and lift the glass off the burner box.
6. Reassemble the unit.

# WIRING DIAGRAM

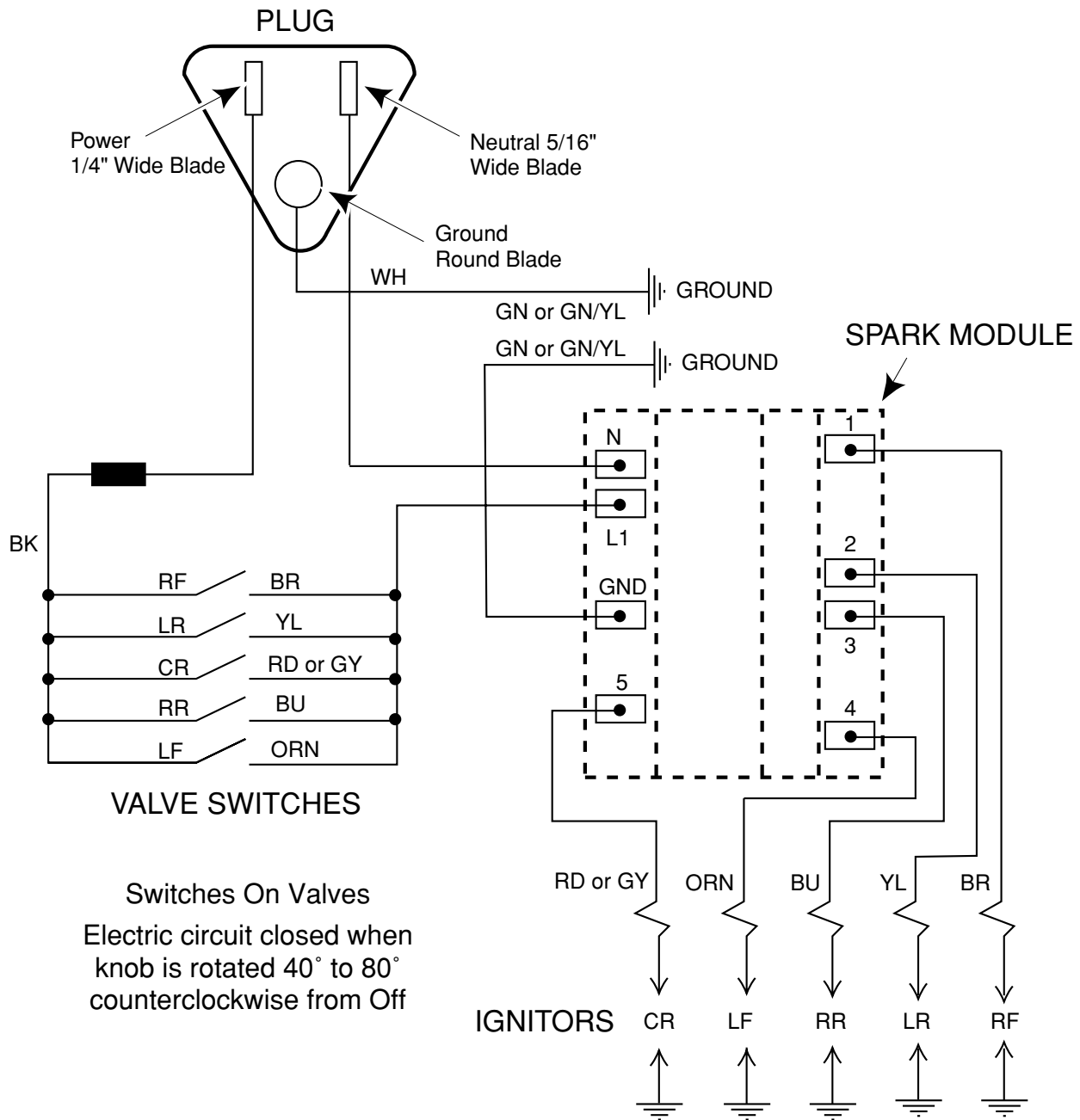

**! WARNING**

**Electrical Shock Hazard**

Disconnect from electrical supply before servicing.

Replace all panels before operating.

**120 VAC, 60 Hz, 1-Phase**  
**15- Or 20-Ampere**

The power cord on this appliance is equipped with a three-pronged (grounded) plug, which mates with standard three-prong (grounding) wall receptacles.

**Part #3191129**

# TROUBLESHOOTING CHART

## WARNING

### Electrical Shock Hazard

Certain procedures in this section require electrical tests or measurements while power is applied to the range. Exercise extreme caution at all times. If test points are not easily accessible, disconnect power, attach test equipment, and reapply power to test.

PROBLEM	POSSIBLE CAUSE	SOLUTION
Burner fails to light. The ignitor sparks.	No gas supply to cooktop.  Weak spark module.	Open the gas shutoff valve or valve on propane tank.  Refill or replace propane tank.  Replace module.
No sparking when any valve is turned to LITE position.	No electrical power to cooktop. Faulty spark ignition switch. Ignition switch off or not properly mounted on gas valve.  Faulty spark module. Check for: <ul style="list-style-type: none"> <li>• Loose or bad connections.</li> <li>• Burned or discolored wires.</li> </ul>	Reset circuit breaker or replace fuse. Check ignition switch. Check ignition switch mounting.  Replace spark module. Repair or replace wires or connectors.
Cooktop sparks when not in use.	Wrong polarity at electric hookup. Faulty spark ignition switch.	Correct wiring. Check switch.
Direct ignitor(s) will not spark.	Check for: <ul style="list-style-type: none"> <li>• Loose or bad connections.</li> <li>• Burned or discolored wires.</li> </ul> Faulty direct ignitor. Faulty valve spark switch.	Repair or replace wires or connectors.  Check ignitor. Check switch.

# WARRANTY

## KitchenAid® Gas Cooktop

LENGTH OF WARRANTY	KITCHENAID WILL PAY FOR:	KITCHENAID WILL NOT PAY FOR:
<p><b>ONE YEAR FULL WARRANTY</b> From Date of Installation.</p>	<p>Replacement parts and repair labor costs to correct defects in materials or workmanship. Service must be provided by an authorized KitchenAid servicing outlet.</p>	<p>A. Service calls to:</p> <ol style="list-style-type: none"> <li>1. Correct the installation of the cooktop.</li> <li>2. Instruct you how to use the cooktop.</li> <li>3. Replace house fuses or correct house wiring.</li> </ol>
<p><b>SECOND THROUGH FIFTH YEAR LIMITED WARRANTY</b> From Date of Installation.</p>	<p>Replacement parts for the gas burners to correct defects in materials or workmanship.</p> <p>For downdraft vent models, replacement parts for the downdraft vent motor to correct defects in materials or workmanship.</p>	<p>B. Repairs when cooktop is used in other than normal home use.</p> <p>C. Damage resulting from accident, alteration, misuse, abuse, improper installation or installation not in accordance with local electrical codes.</p> <p>D. Any labor costs during the limited warranties.</p> <p>E. Replacement parts or repair labor costs for units operated outside the United States.</p> <p>F. Pickup and delivery. This product is designed to be repaired in the home.</p>

**KITCHENAID DOES NOT ASSUME ANY RESPONSIBILITY FOR INCIDENTAL OR CONSEQUENTIAL DAMAGES.** Some states do not allow the exclusion or limitation of incidental or consequential damages, so this exclusion may not apply to you.

This warranty gives you specific legal rights, and you may also have other rights which vary from state-to-state.

® Registered Trademark of KitchenAid, St. Joseph, Michigan, U.S.A. 49085.