

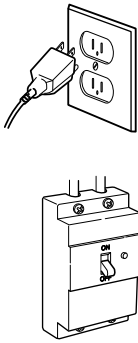

## 8. ERROR DIAGNOSIS AND CHECK LIST

### 8-1.DIAGNOSIS AND ANSWER FOR ABNORMAL OPERATION

SYMPTOM	GUIDE FOR SERVICE CALL
<p>NO POWER</p>	<div data-bbox="565 539 1122 909"> <p>Is the power plug connected firmly to 120V~ outlet?</p> <p>YES</p> <p>Power failure? or Breaker opened? Is the outlet controlled by a switch?</p> <p>NO</p> <p>Visit to check</p> </div> <div data-bbox="1203 546 1341 887">  </div>
<p>Water inlet trouble</p> <p>— NO INLET —</p>	<div data-bbox="565 1014 1122 1832"> <p>Is <b>NO INLET</b> displayed?</p> <p>YES</p> <p>Is the tap opened?</p> <p>YES</p> <p>Is the tap frozen?</p> <p>NO</p> <p>Is the water supply shut-off?</p> <p>NO</p> <p>Is filter in the inlet valve clogged with foreign material?</p> <p>YES</p> <p>NO</p> <p>Visit to check</p> </div> <div data-bbox="1175 1021 1373 1720"> <p>— NO INLET —</p>  <div data-bbox="1198 1518 1424 1720"> <p>Clean the filter of inlet valve</p>  </div> </div>

SYMPTOM	GUIDE FOR SERVICE CALL
<p>           ¥ Door does not open            ¥ Error displayed on the program         </p> <div data-bbox="280 636 441 696" data-label="Image"> </div>	<div data-bbox="586 450 1230 539" data-label="Text"> <p>Started with door opened? <b>YES</b></p> </div> <div data-bbox="1247 461 1409 521" data-label="Image"> </div> <div data-bbox="1240 577 1419 607" data-label="Text"> <p>Close the door</p> </div> <div data-bbox="1279 622 1382 719" data-label="Image"> </div> <div data-bbox="586 678 1144 790" data-label="Text"> <p>Didn't you press the [DOOR OPEN] button with water remained in the tub?</p> </div> <div data-bbox="915 909 976 938" data-label="Text"> <p><b>YES</b></p> </div> <div data-bbox="1045 842 1425 1021" data-label="List-Group"> <ol style="list-style-type: none"> <li>1. Press the [START/PAUSE] button to stop the appliance.</li> <li>2. Drain water by selecting spin.</li> <li>3. Open door by pressing the [DOOR OPEN] button.</li> </ol> </div> <div data-bbox="842 976 886 1005" data-label="Text"> <p><b>NO</b></p> </div> <div data-bbox="586 1070 1144 1189" data-label="Text"> <p>Isn't door opened in spite of pressing the [DOOR OPEN] button</p> </div> <div data-bbox="842 1196 886 1225" data-label="Text"> <p><b>NO</b></p> </div> <div data-bbox="586 1256 1149 1328" data-label="Text"> <p>Visit to check</p> </div> <div data-bbox="678 1346 1052 1375" data-label="Text"> <p>Check if the door switch is O-K.</p> </div>
<p>¥ DRAIN TROUBLE</p> <div data-bbox="250 1547 483 1621" data-label="Image"> </div>	<div data-bbox="586 1447 1144 1518" data-label="Text"> <p>Is  displayed?</p> </div> <div data-bbox="834 1525 894 1554" data-label="Text"> <p><b>YES</b></p> </div> <div data-bbox="1224 1458 1458 1525" data-label="Text"> <p><b>NO DRAIN</b></p> </div> <div data-bbox="586 1585 1144 1697" data-label="Text"> <p>Is the debris filter clogged with foreign material such as pins, coins, etc?</p> </div> <div data-bbox="1127 1626 1187 1655" data-label="Text"> <p><b>YES</b></p> </div> <div data-bbox="1214 1608 1328 1682" data-label="Text"> <p>Clean up the filter.</p> </div> <div data-bbox="1344 1563 1463 1704" data-label="Image"> </div> <div data-bbox="842 1688 886 1718" data-label="Text"> <p><b>NO</b></p> </div> <div data-bbox="586 1749 1149 1821" data-label="Text"> <p>Is the drain hose frozen with water, kinked, or crushed?</p> </div> <div data-bbox="842 1823 886 1852" data-label="Text"> <p><b>NO</b></p> </div> <div data-bbox="586 1883 1149 1955" data-label="Text"> <p>Visit to check</p> </div> <div data-bbox="1224 1720 1430 1883" data-label="Image"> </div>

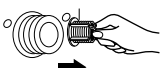
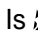
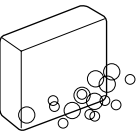
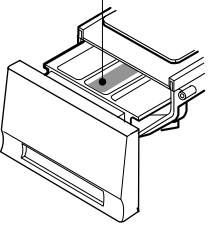
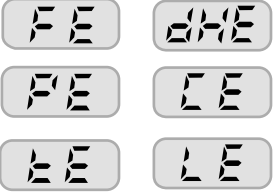
SYMPTOM	GUIDE FOR SERVICE CALL
<p>◦ Suds overflow from the appliance. (In this condition, wash and spin do not operate normally)</p>	<div data-bbox="586 394 1143 495">Is low-sudsing detergent for the drum washing machine used?</div> <div data-bbox="797 495 932 539">YES</div> <div data-bbox="586 551 1143 651">Is the proper amount of detergent used as recommended?</div> <div data-bbox="797 651 932 696">YES</div> <div data-bbox="586 696 1143 797">Recommend to reduce the amount of detergent.</div> <div data-bbox="634 819 1386 976"> <p>* This appliance has the automatic suds sensing function which operates under much suds condition for good rinse and preventing overflow.</p> <p>* When much suds are sensed, the suds removing function such as drain, water input, pause will operate without rotating the drum.</p> </div> <div data-bbox="1214 405 1403 573">  <p>LOW-SUDSING</p> </div>
<p>◦ No effect of softener</p>	<div data-bbox="586 1070 1143 1171">Is softener put in the correct compartment of the drawer?</div> <div data-bbox="797 1171 932 1216">YES</div> <div data-bbox="586 1227 1143 1305">Is the drawer closed during wash?</div> <div data-bbox="797 1305 932 1350">YES</div> <div data-bbox="586 1350 1143 1429">Is the softener cap clogged?</div> <div data-bbox="797 1429 932 1473">YES</div> <div data-bbox="586 1473 1143 1541">Explain how to use softener</div> <div data-bbox="618 1552 1049 1585">Clean the compartment for softener</div> <div data-bbox="1166 1115 1398 1429"> <p>Compartment for softener</p>  </div>
	<div data-bbox="586 1693 1143 1760">Visit to check</div>

# 8-2.FAULT DIAGNOSIS AND TROUBLE SHOOTING

## CAUTION

- 1. Be careful of electric shock or disconnecting the parts while trouble shooting.
- 2. First of all, check the connection of each part terminal with wiring diagram.
- 3. If you replace the MAIN PWB ASSEMBLY, Put in the connectors correctly.

### NO POWER

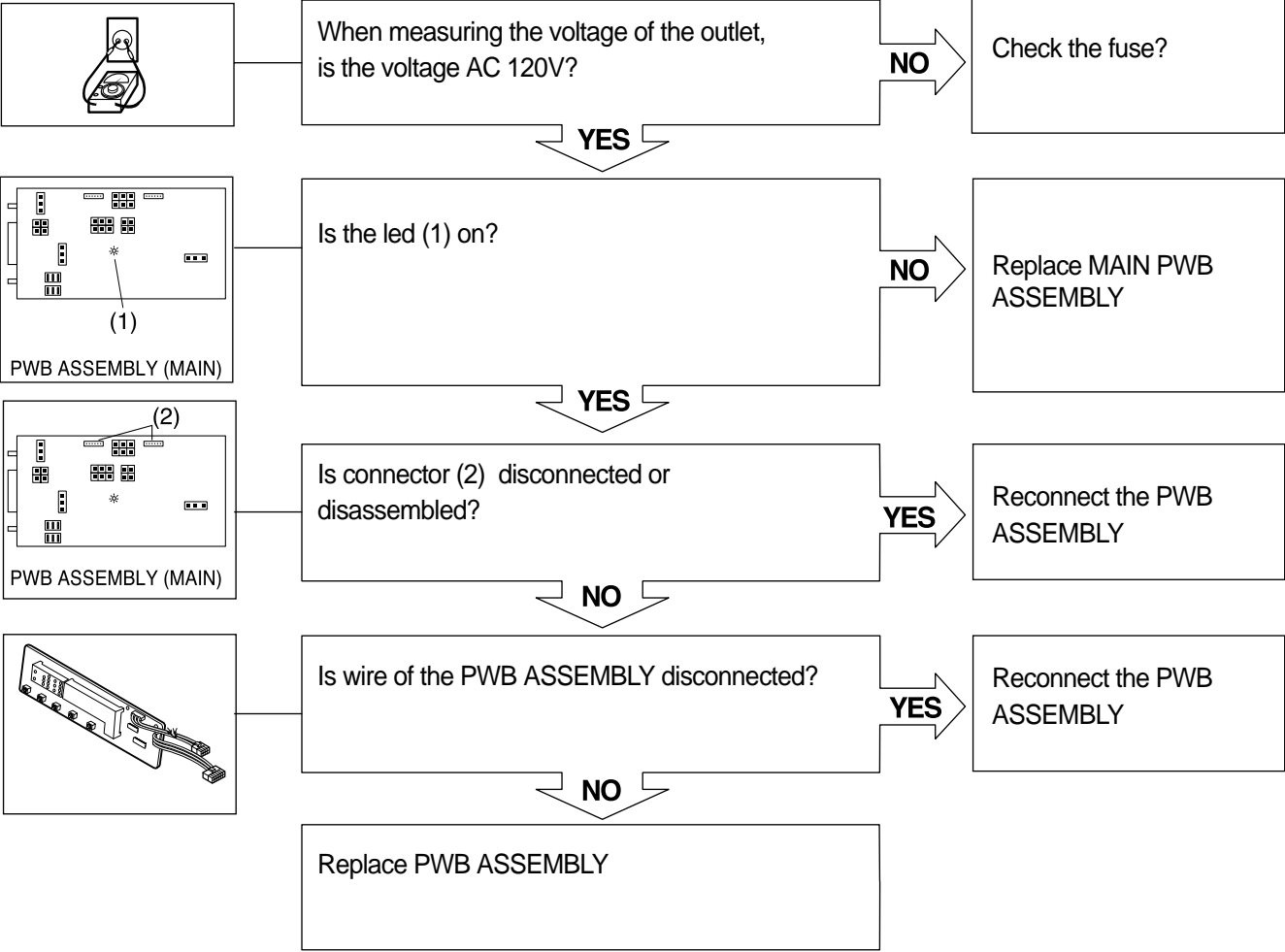

## NO WATER SUPPLY

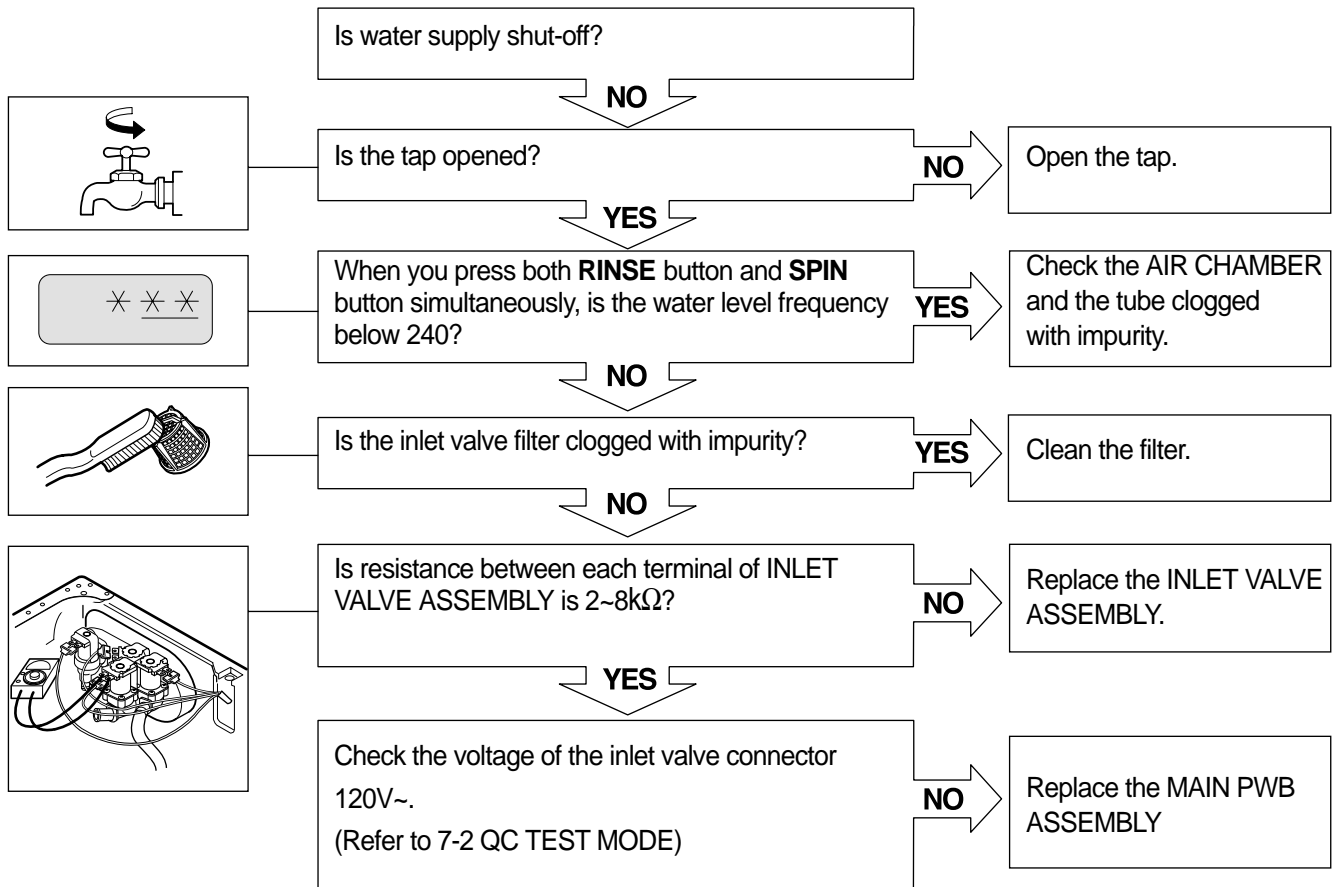

## DETERGENT DOES NOT FLOW IN

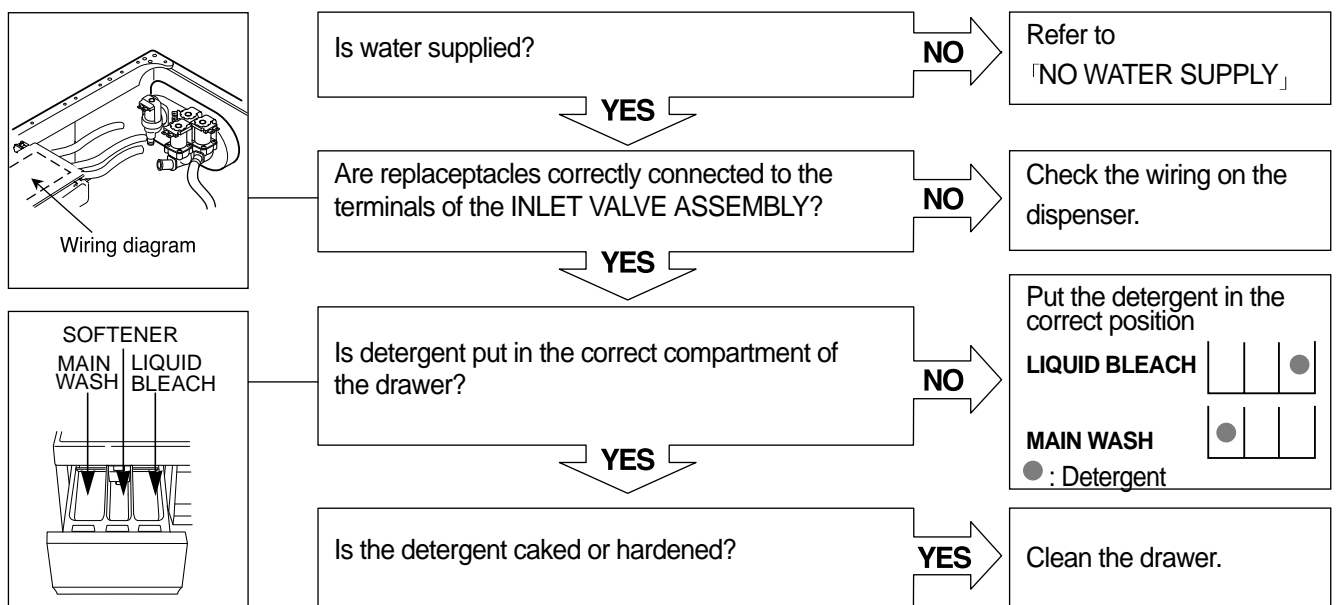

## SOFTENER DOES NOT FLOW IN

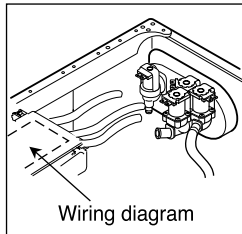

Is water supplied?

**NO**

Refer to  
「NO WATER SUPPLY」

**YES**

Are receptacles correctly connected to the terminals  
of the INLET VALVE ASSEMBLY?

**NO**

Check the wiring on the  
dispenser.

**YES**

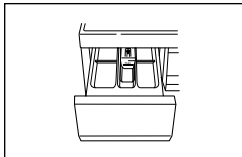

Is softener put in the correct compartment of the  
drawer?

**NO**

Put it in the correct  
compartment.

**YES**

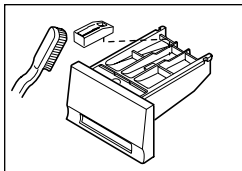

Is the softener cap clogged?

**YES**

Clean the Cap and  
Drawer.

## ABNORMAL SOUND

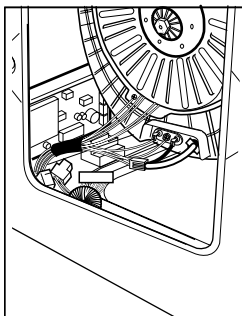

Is the motor bolt loosened?

**YES**

Fix the bolt tightly.

**NO**

Is there friction noise from the motor?

**YES**

Replace the STATOR  
ASSEMBLY or ROTOR  
ASSEMBLY.

## HEATING WITHOUT WATER

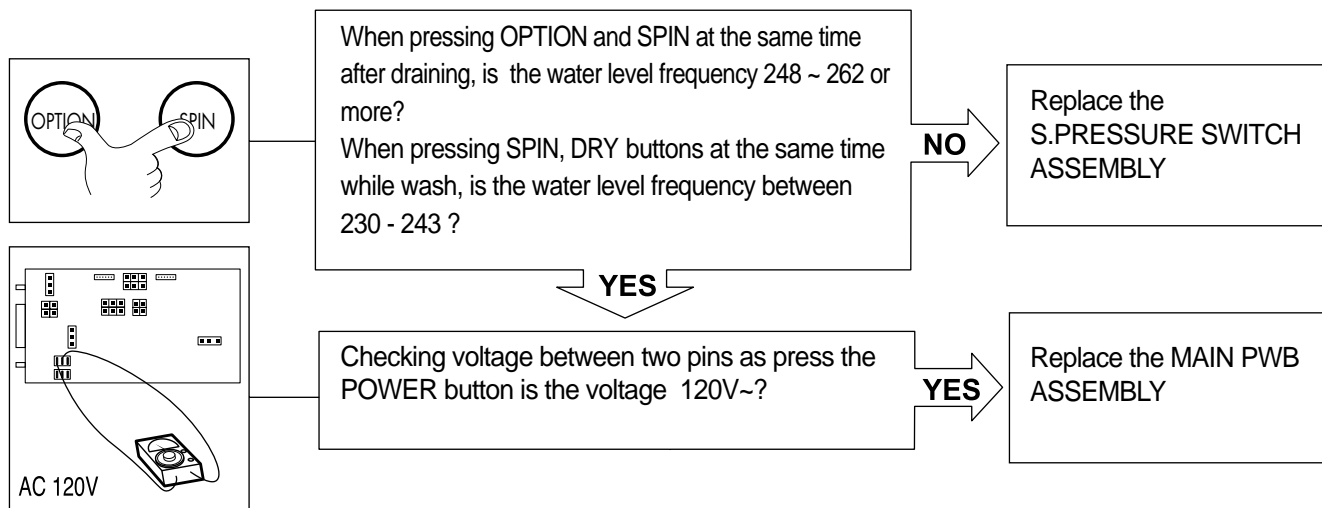

## DRAIN MALFUNCTIONING

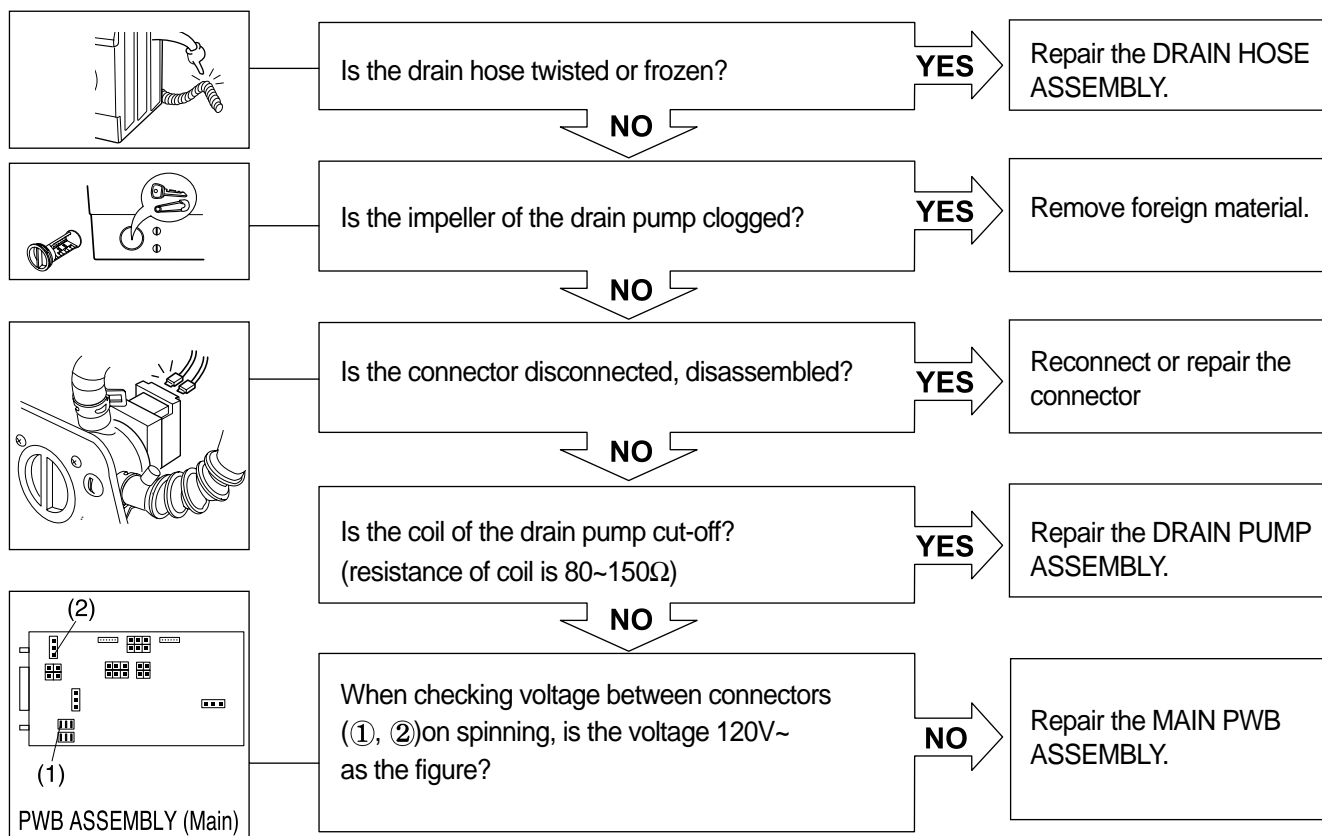

## WASH HEATER TROUBLE

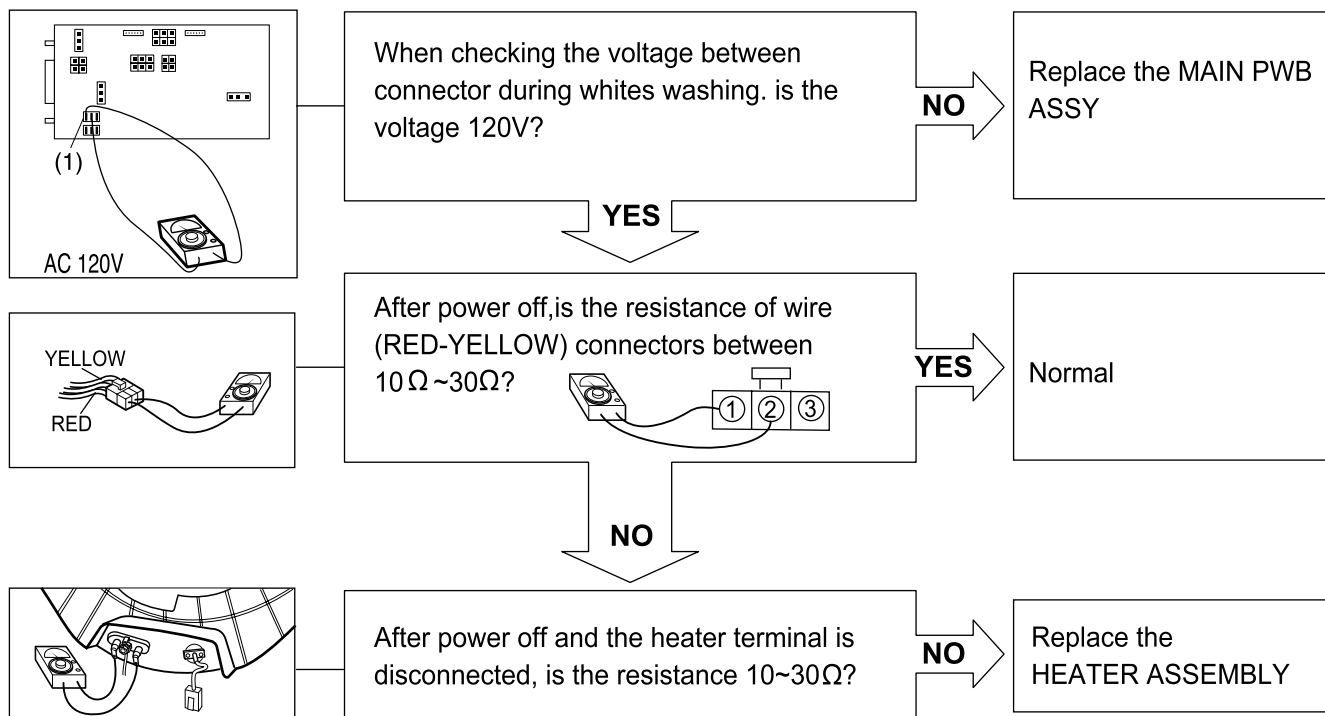

## HEATING CONTINUOUSLY ABOVE THE SETTING WATER TEMPERATURE

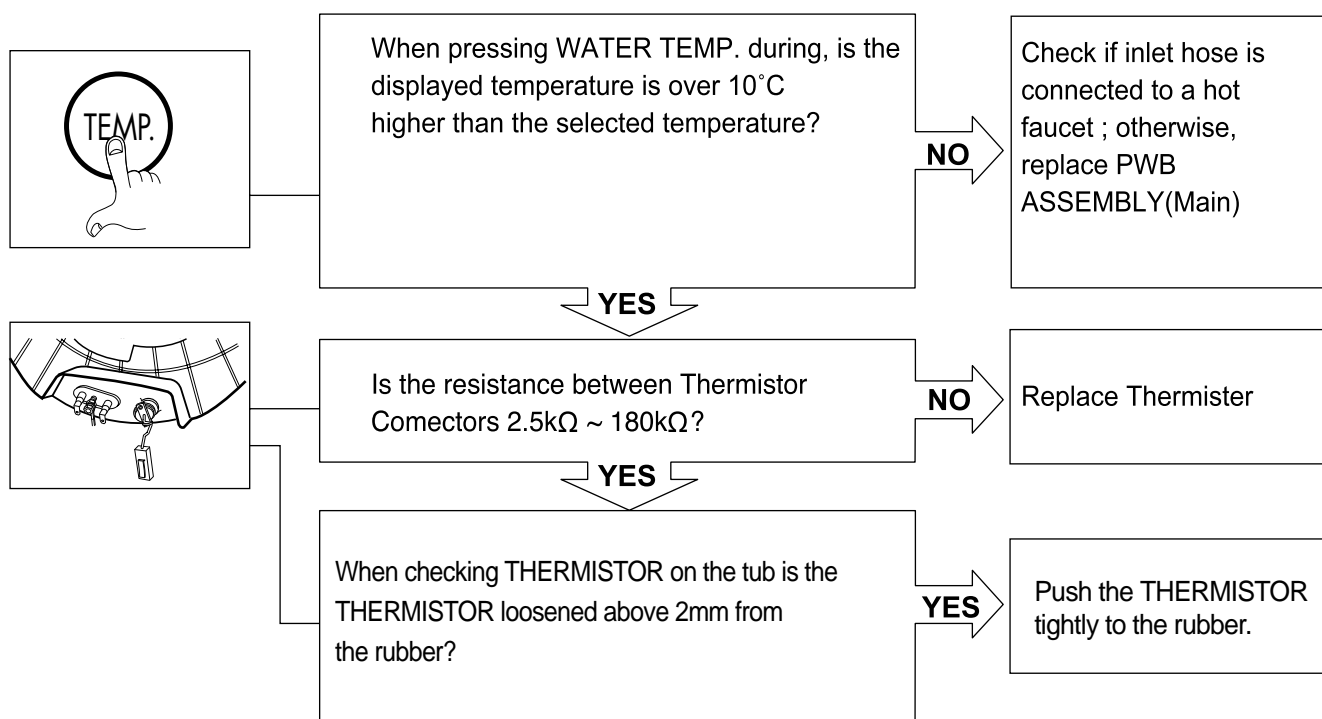



## SPIN TROUBLE

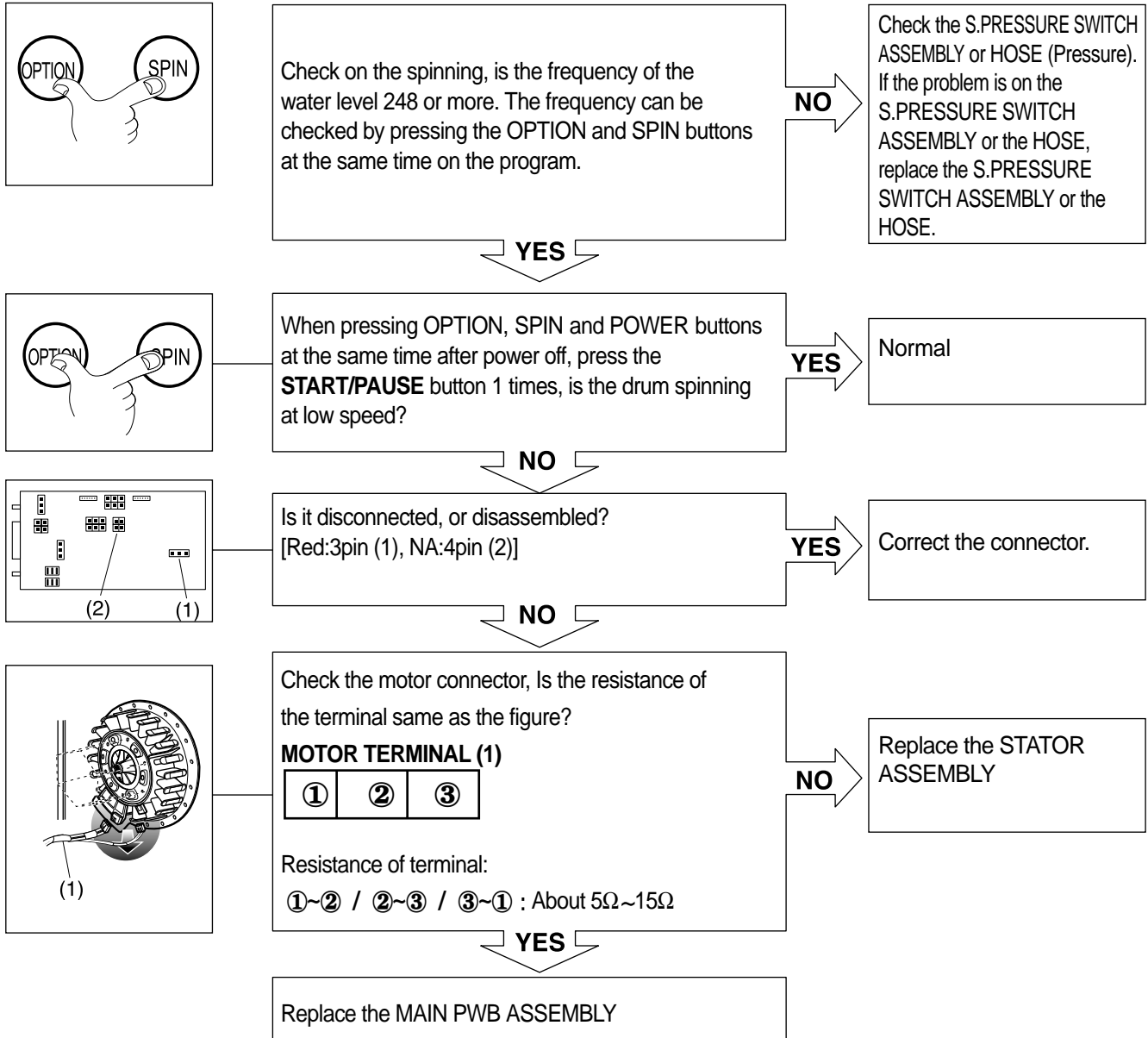

## Door does not open

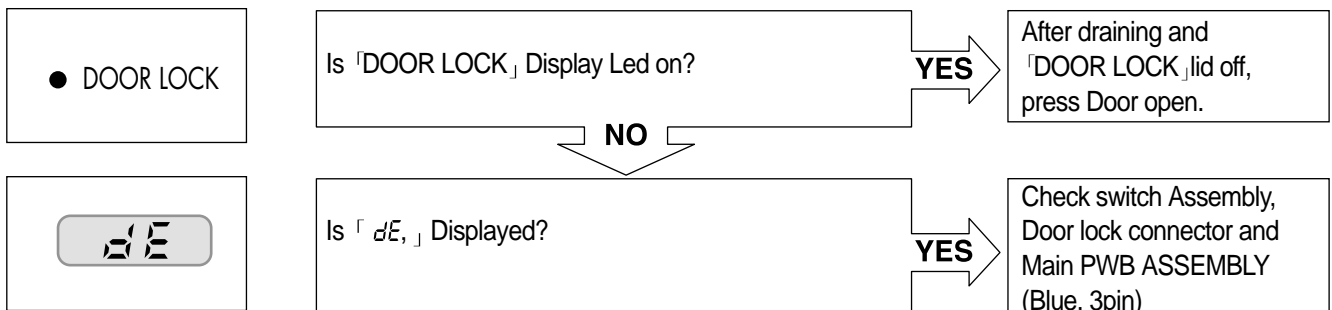

## [dHE] ERROR DISPLAY

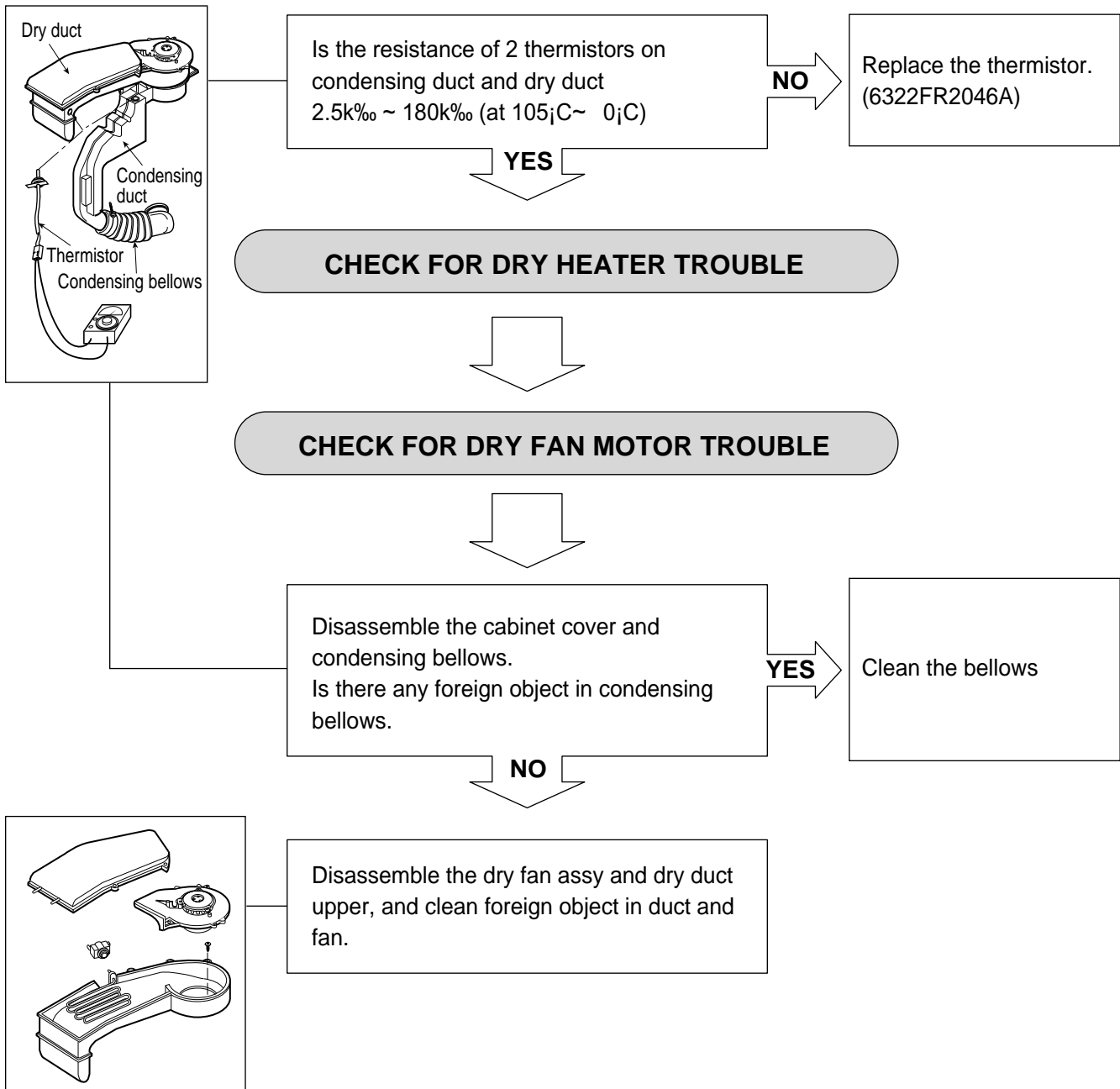

## DRY HEATER TROUBLE

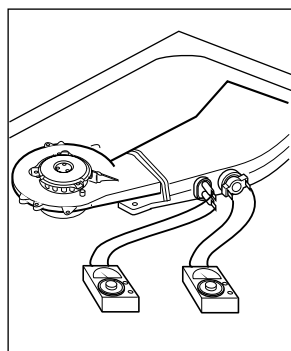

After power off, is the resistance of dry heater 10 ~ 40%?

**NO**

Replace the dry heater.

**YES**

Is thermostat closed?

**NO**

Replace the thermostat.

**YES**

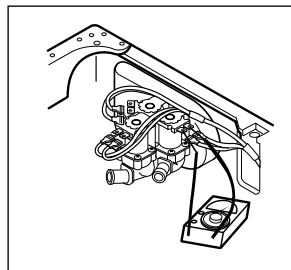

When checking voltage between connectors ( ① , ② ) on drying, is the voltage AC 120V as the figure?  
(Wire color : ① - Red, ② - Blue)

**NO**

Replace the PWB assy (Main)

## DRY FAN MOTOR TROUBLE

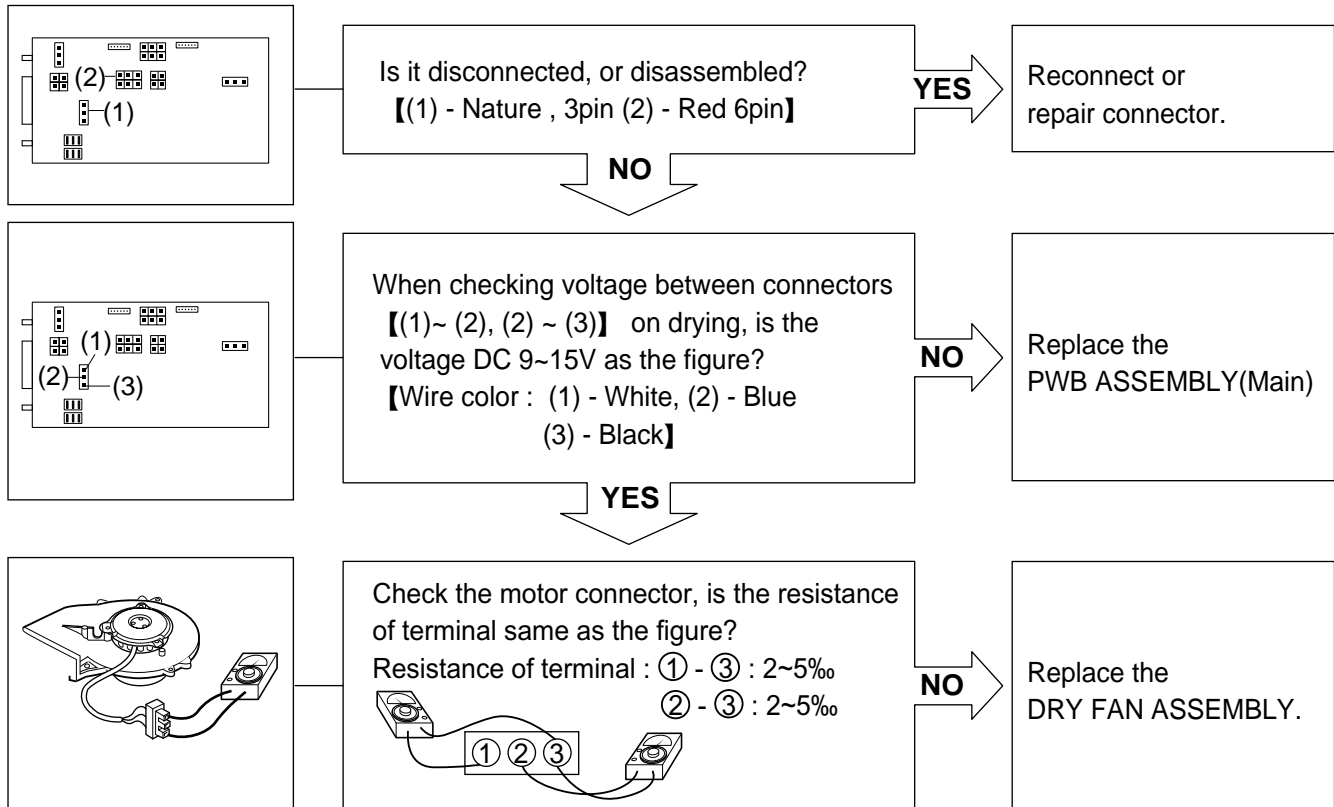

## LOT OF VAPOR IN DRAWER WHEN DRYING

