

# Service

This manual is to be used by qualified appliance technicians only. Maytag does not assume any responsibility for property damage or personal injury for improper service procedures done by an unqualified person.

## 24" Intl Front Load Washer

This Base Manual covers general information.

Refer to individual Technical Sheet for information on specific models.

This manual includes, but is not limited to the following:

**MAH2440AW\***

# Important Information

## Important Notices for Servicers and Consumers

Maytag will not be responsible for personal injury or property damage from improper service procedures. Pride and workmanship go into every product to provide our customers with quality products. It is possible, however, that during its lifetime a product may require service. Products should be serviced only by a qualified service technician who is familiar with the safety procedures required in the repair and who is equipped with the proper tools, parts, testing instruments and the appropriate service information. **IT IS THE TECHNICIANS RESPONSIBILITY TO REVIEW ALL APPROPRIATE SERVICE INFORMATION BEFORE BEGINNING REPAIRS.**



### **WARNING**

To avoid risk of severe personal injury or death, disconnect power before working/servicing on appliance to avoid electrical shock.

To locate an authorized servicer, please consult your telephone book or the dealer from whom you purchased this product. For further assistance, please contact:

### Customer Service Support Center

CAIR Center

Web Site

Telephone Number

WWW.MAYTAG.COM ..... 1-800-688-9900

CAIR Center in Canada ..... 1-800-688-2002

### Recognize Safety Symbols, Words, and Labels



### **DANGER**

**DANGER**—Immediate hazards which **WILL** result in severe personal injury or death.



### **WARNING**

**WARNING**—Hazards or unsafe practices which **COULD** result in severe personal injury or death.



### **CAUTION**

**CAUTION**—Hazards or unsafe practices which **COULD** result in minor personal injury, product or property damage.

Important Information .....	2
Important Safety Information .....	4
General Information	
Model Identification .....	8
Serial Label Location .....	8
Model Nomenclature .....	9
Troubleshooting	
Troubleshooting General Symptoms .....	10
Component Testing Information	
Component Testing Information .....	15
Disassembly Procedures	
Top Removal .....	19
Water Valve Removal .....	19
Pressure Valve Removal .....	19
Drain Pump Removal .....	20
EMI Filter .....	21
Console/Machine Control Removal .....	21
Boot Removal .....	22
Door Assembly Removal .....	22
Door Disassembly .....	23
Front Panel/Door Removal .....	23
Motor And Belt Removal .....	24
Tub Pulley Removal .....	25
Tub Removal .....	25
Appendix A	
Installation Instructions/Owners Guide .....	30

# Important Safety Information



## WARNING

To reduce the risk of fire, electric shock, serious injury or death to persons when using your washer, follow these basic precautions:

- Read all instructions before using the washer.
- Refer to the Grounding Instructions in the Installation Manual for the proper grounding of the washer.
- Do not wash articles that have been previously cleaned in, washed in, soaked in, or spotted with gasoline, dry-cleaning solvents, or other flammable or explosive substances as they give off vapors that could ignite or explode.
- Do not add gasoline, dry-cleaning solvents, or other flammable or explosive substances to the wash water. These substances give off vapors that could ignite or explode.
- Under certain conditions, hydrogen gas may be produced in a hot water system that has not been used for two weeks or more. Hydrogen gas is explosive. If the hot water system has not been used for such a period, before using a washing machine or combination washer-dryer, turn on all hot water faucets and let the water flow from each for several minutes. This will release any accumulated hydrogen gas. The gas is flammable, do not smoke or use an open flame during this time.
- Do not allow children to play on or in the washer. Close supervision of children is necessary when the washer is used near children. This is a safety rule for all appliances.
- Before the washer is removed from service or discarded, remove the lid to the washing compartment.
- Do not reach into the washer if the wash tub is moving.
- Do not install or store the washer where it will be exposed to water and/or weather.
- Do not tamper with the controls.
- Do not repair or replace any part of the washer, or attempt any servicing unless specifically recommended in the User-Maintenance instructions or in published user-repair instructions that you understand and have the skills to carry out.
- To reduce the risk of an electric shock or fire, do not use an extension cord or an adapter to connect the washer to the electrical power source.
- Use your washer only for its intended purpose, washing clothes.
- Always disconnect the washer from electrical supply before attempting any service. Disconnect the power cord by grasping the plug, not the cord.
- Install the washer according to the Installation Instructions. All connections for water, drain, electrical power and grounding must comply with local codes and be made by licensed personnel

when required. Do not do it yourself unless you know how!

- To reduce the risk of fire, clothes which have traces of any flammable substances such as vegetable oil, cooking oil, machine oil, flammable chemicals, thinner, etc. or anything containing wax or chemicals such as in mops and cleaning cloths, must not be put into the washer. These flammable substances may cause the fabric to catch on fire by itself.
- Do not use fabric softeners or products to eliminate static unless recommended by the manufacturer of the fabric softener or product.
- Keep your washer in good condition. Bumping or dropping the washer can damage safety features. If this occurs, have your washer checked by a qualified service person.
- Replace worn power cords and/or loose plugs.
- Be sure water connections have a shut-off valve and that fill hose connections are tight. Close the shut-off valves at the end of each wash day.
- Loading door must be closed any time the washer is in operational fill, tumble, or spin. Do not attempt to bypass the loading lid switch by permitting the washer to operate with the loading lid open.
- Always read and follow manufacturer's instructions on packages of laundry and cleaning aids. Heed all warnings or precautions. To reduce the risk of poisoning or chemical burns, keep them out of the reach of children at all times (preferably in a locked cabinet).
- Always follow the fabric care instructions supplied by the garment manufacturer.
- Never operate the washer with any guards and/or panels removed.
- Do not operate the washer with missing or broken parts.
- Do not bypass any safety devices.
- Failure to install, maintain, and/or operate this washer according to the manufacturer's instructions may result in conditions which can produce bodily injury and/or property damage.

**NOTE:** The Warnings and Important Safety Instructions appearing in this manual are not meant to cover all possible conditions and situations that may occur. Common sense, caution and care must be exercised when installing, maintaining, or operating the washer.

Always contact your dealer, distributor, service agent or the manufacturer about any problems or conditions you do not understand.



# Important Safety Information

## **WARNING**

To avoid personal injury or death from improper servicing, make sure you read and understand the descriptions and meaning of various safety symbols, words and labels used in this manual, before attempting any procedures described in the manual. Failure to understand and comply with safety information may result in severe personal injury or death.

### General Information

This Service Manual describes the operation, disassembly, troubleshooting, and repair of the Compact washer. It is intended for use by authorized technicians who troubleshoot and repair these units.

**NOTE:** It is assumed that users of this manual are familiar with the use of tools and equipment used to troubleshoot and repair electrical, and mechanical systems; and understand the terminology used to describe and discuss them.

### Related Publications

This is a base service manual, covering a range of similar models. It is intended to be used in conjunction with the Parts Manual and Technical Sheet covering the specific model being serviced.

### About Ground Wires

In the event of an electrical short circuit, a ground wire reduces the risk of electric shock by providing an escape wire for the electric current.

Standard accepted color coding for ground wires is **green** or **green with a yellow stripe**.

Grounding wires and wires colored like grounding wires are **NOT** to be used as current carrying conductors.

## **WARNING**

To reduce the risk of fire, electric shock, serious injury or death, all wiring and grounding must conform with the latest edition of the National Electric Code, ANSI/NFPA 70, or the Canadian Electrical Code, CSA C22.1, and such local regulations as might apply. It is the customer's responsibility to have the wiring and fuses checked by a qualified electrician to make sure your home has adequate electrical power to operate the washer.

## **WARNING**

**To avoid risk of personal injury or death due to electrical shock:**

- **Observe all local codes and ordinances.**
- Disconnect electrical power to unit before servicing.
- Ground appliance properly.
- Check with a qualified electrician if you are not sure this appliance is properly grounded.
- DO NOT ground to gas line.
- DO NOT ground to cold water pipe if pipe is interrupted by plastic, nonmetallic gaskets, or other insulating (nonconducting) materials.
- DO NOT modify plug on power cord. If plug does not fit electrical outlet, have proper outlet installed by qualified electrician.
- DO NOT have a fuse in the neutral or ground circuit. A fuse in the neutral or ground circuit could result in an electrical shock.
- DO NOT use an extension cord with this appliance.
- DO NOT use an adapter plug with this appliance.
- DO NOT pinch power cord.

# Important Safety Information

## Explanation

**Grounded**—This means the round hole connection is connected to earth ground through a connection to the main power panel.

**Ungrounded**—The round hole connection is not complete to earth ground and/or the main power panel.

## Grounding Instructions

### **WARNING**

- To avoid the risk of electrical shock or death, do not alter the plug.
- Do not remove grounding prong when installing grounded appliance in a home that does not have three wire grounding receptacle. Under no condition is grounding prong to be cut off or removed. It is the personal responsibility of the consumer to contact a qualified electrician and have properly grounded three prong wall receptacle installed in accordance with appropriate electrical codes.
- To avoid the risk of electrical shock or death, this equipment must be grounded.

This equipment **MUST** be grounded. In the event of an electrical short circuit, grounding reduces the risk of electric shock by providing an escape wire for the electric current. This unit is equipped with a cord having a grounding wire with a grounding plug. The plug must be plugged into an outlet that is properly installed and grounded.

Consult a qualified electrician or technician if grounding instructions are not completely understood, or if doubt exists as to whether the equipment is properly grounded. Do not use an extension cord. If the product power cord is too short, have a qualified electrician install a three-slot receptacle. This unit should be plugged into a separate circuit with the electrical rating.

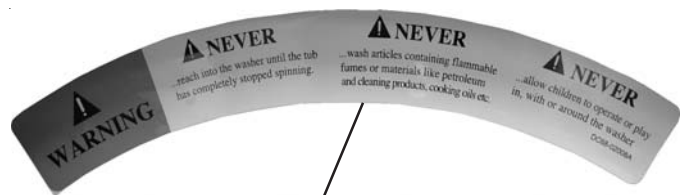

# Important Safety Information

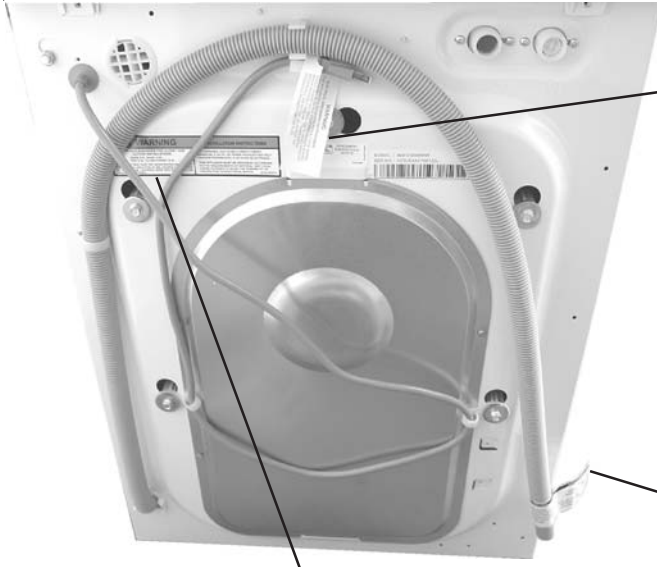

**WARNING**

**ELECTRICAL GROUNDING INSTRUCTIONS**

THIS APPLIANCE IS EQUIPPED WITH A THREE-PRONG (GROUNDING) PLUG FOR YOUR PROTECTION AGAINST SHOCK HAZARD AND SHOULD BE PLUGGED DIRECTLY INTO A PROPERLY GROUNDED THREE-PRONG RECEPTACLE. DO NOT CUT OR REMOVE THE GROUNDING PRONG FROM THIS PLUG.

**WARNING**

**MINIMUM CLEARANCES FOR CLOSET AND ALCOVE INSTALLATIONS**

SIDES 0 IN., REAR -0 IN.  
TOP -0 IN., CLOSET FRONT -0 IN.

CLOSET FRONT MUST HAVE TWO UNOBSTRUCTED AIR OPENINGS COMBINED TOTAL AREA 72 SQ. IN. MIN. LOCATED 3 IN. MIN. FROM TOP AND BOTTOM. LOUVERED DOOR WITH EQUIVALENT AIR OPENING IS ACCEPTABLE.

**DRAIN HOSE INSTALLATION: MAYTAG IMPORTANT**

If the standpipe is less than 36" high, the drain hose must be routed through clip on the cabinet back to raise hose to proper height.

CLIP

If an airtight connection between the drain hose and standpipe is demanded, an anti-siphon valve is needed.

HOSE RETAINER

Do not remove the hose retainer from the drain hose.

DC68-02045A



**WARNING**

CONTROL BOARD, HEAT SINK, MOTOR AND PUMP ARE INTENTIONALLY NOT GROUNDED AND MAY PRESENT A RISK OF ELECTRIC SHOCK, ONLY DURING SERVICING.

**CAUTION**

KEEP CLEAR  
ROTATING BELTS AND PULLEYS

DC68-02003A

DC68-02006A

# General Information

## Model Identification

Complete registration card and promptly return. If registration card is missing:

- For Maytag product call 1-800-688-9900 or visit the Web Site at [www.maytag.com](http://www.maytag.com)
- For product in Canada call 1-866-587-2002 or visit the Web Site at [www.maytag.com](http://www.maytag.com).

When contacting provide product information located on rating label. Record the following:

Model Number: \_\_\_\_\_  
Manufacturing Number: \_\_\_\_\_  
Serial or S/N Number: \_\_\_\_\_  
Date of purchase: \_\_\_\_\_  
Dealer's name and address: \_\_\_\_\_



Serial Label is located on the back of the unit and the front behind the door.



## Service

Keep a copy of sales receipt for future reference or in case warranty service is required. To locate an authorized technician:

- For Maytag call 1-800-462-9824 or visit the Web Site at [www.maytag.com](http://www.maytag.com).
- For product in Canada call 1-866-587-2002 or visit the Web Site at [www.maytag.com](http://www.maytag.com).

Warranty service must be performed by an authorized technician. We also recommend contacting an authorized technician, if service is required after warranty expires.

## Parts and Accessories

Purchase replacement parts and accessories over the phone. To order accessories for your product call:

- For Maytag product call 1-800-462-9824 or visit the Web Site at [www.maytag.com](http://www.maytag.com).
- For product in Canada call 1-866-587-2002 or visit the Web Site at [www.maytag.com](http://www.maytag.com).

## Extended Service Plan

We offer long-term service protection for this new washer.

- Dependability Plus™ Extended Service Plan is specially designed to supplement Maytag's strong warranty. This plan covers parts, labor, and travel charges.  
Call 1-800-925-2020 for information.

# General Information

## Compact Washer Nomenclature

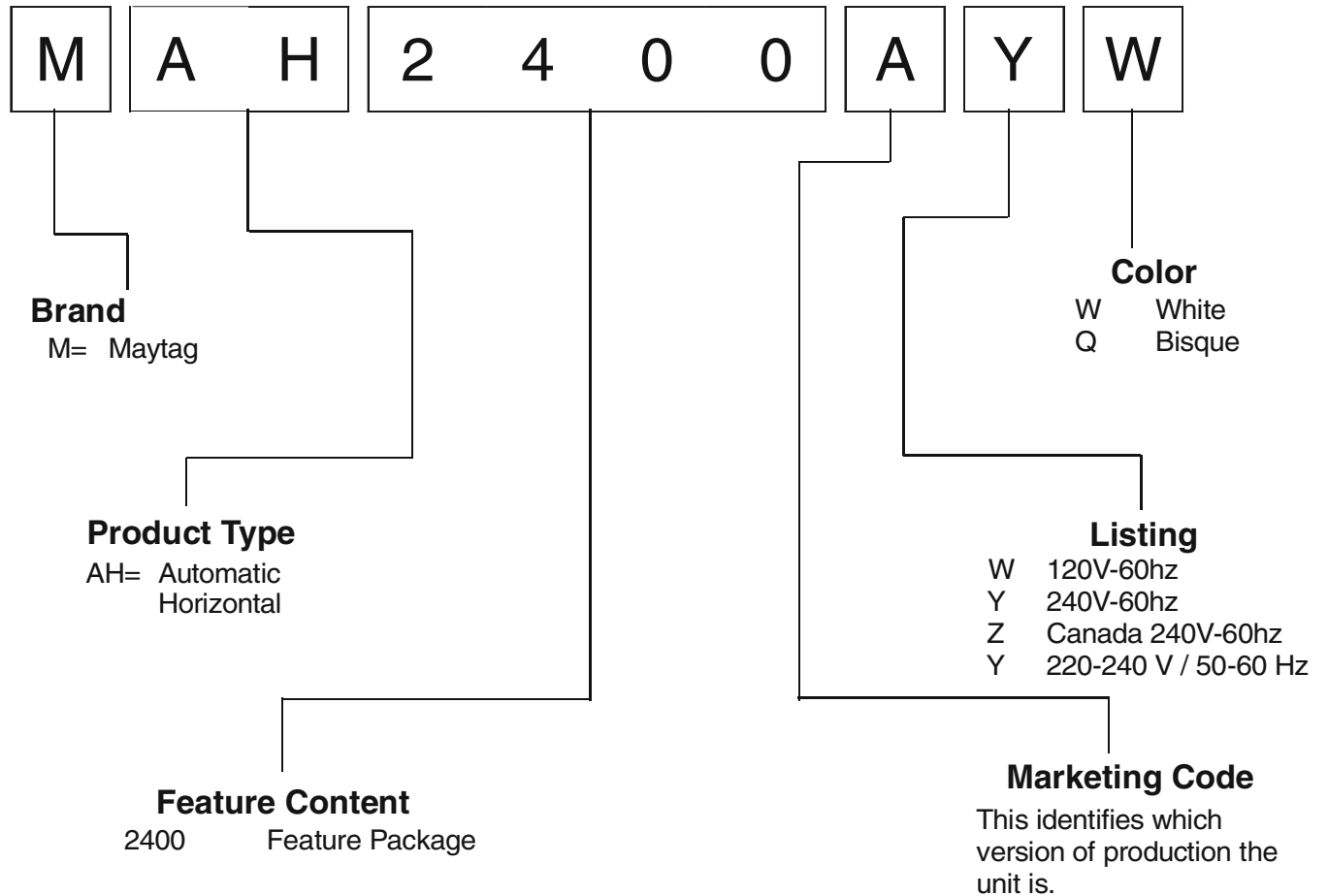

**Trouble Shooting and Diagnostic Guide is Located Behind Toe Panel.**

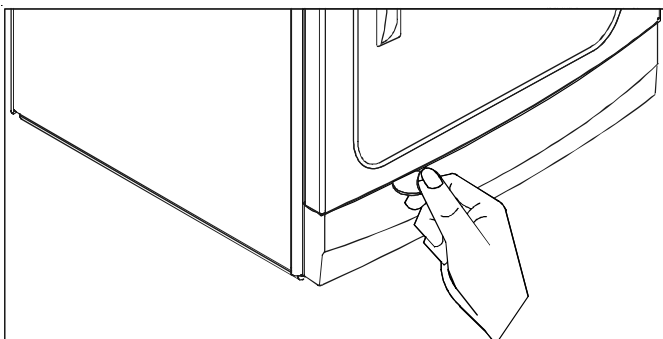



# Troubleshooting Procedures



## WARNING

To avoid risk of electrical shock, personal injury or death, disconnect power to unit before servicing, unless testing requires power.

Place washer into **Service Mode** and check for diagnostic codes. See **Technical Data Sheet** taped to rear panel.

### Will Not Start

- Plug cord into live electrical outlet. Check for proper voltage.
- Check fuse or reset circuit breaker.
- Push the START/PAUSE button to start the clothes washer.
- Close door and push the START/PAUSE button to start the clothes washer. START/PAUSE LED should change from flashing to on continuously.
- Check to see if the washer in a pause or soak period in the cycle. Wait briefly and it may start.
- Check for restricted drain system.
- Check the line filter connection terminals for good connections.
- Check the machine control board terminal connections AC1-CN7 (Pin 2) White to AC2-CN5 Black for good connections.
- Check for stuck buttons on console, pushing in on board tact switches. Readjust buttons on inside of console.
- Replace console control board.

### Leaking

- Make sure inlet hose connections are not leaking. Check for rubber gasket damage due to over-tightening.
- Check standpipe for leak. Wrap a dry rag around the standpipe opening. If rag becomes wet, leak is fault of home plumbing. Be sure the standpipe is capable of accepting the flow of water from the washer.
- Make sure end of drain hose is correctly inserted and secured to drain standpipe.
- Check internal hose connections (fill, drain systems, dispenser hoses & clamps).
- Check rubber boot. Remove, reposition and reinstall, if necessary.
- Check for possible kinked dispenser to outer tub hose. Hot water pressurization may force door open.

### No Tumble

- Start normal cycle with an empty machine and allow a fill to check tumble.
- Washer does not tumble during most fills or during presoak.
- Perform **Board Output Test**.
- Check for loose connections at machine control board, pressure switch, motor, tach harness and motor control.
- Check motor windings resistance. (Pins 8 & 9 = 3.6 ohms, pins 1 & 10 = 1.1 ohms, Pins 5 &

10 = 1.1 ohms)

- Check belt.

### Will Not Spin

- Check to make sure the door is fully closed.
- Check for water left inside the washer. If present, see **Will Not Drain**.
- Perform **Board Output Test**. Will washer spin? Possible unbalanced load scenario previously.
- Check for loose connections at machine control board, pressure switch, motor, tach harness and motor control.
- Check belt.

### No Water Fill

- Test water fill. Perform **Board Output Test**.
- Check to make sure water supply is turned on fully.
- With no clothes in washer normal water level is between the 4<sup>th</sup> and 5<sup>th</sup> hole on the spinner back wall.
- Check electrical circuit and connections at the water valve, and pressure switch.
- Check for kinks in inlet hoses.
- Check for clogged inlet screens.
- Visually check hot and cold separately for fill.
- Check for low water pressure. May be dependent on pressure entering home. Variations may occur due to usage in the home at the time machine is used.
- Check for frozen pipes and hoses.
- Check resistance of water valve coils. (normal 1.18K ohms; CN3 connector – Cold (BU) – Bleach (OR) – Hot (RD)
- Check for loose connections at the pressure switch or on the machine control board, connector 5P.

### Tub Full of Suds

- Check for restricted drain system. See **Will Not Drain** and **Will Not Spin**.
- Check for loose wire connections at control board and pump.
- Perform **Board Output Test**.
- Use high efficiency or low sudsing detergent specially formulated for front load washers.
- Reduce detergent amount for that specific load size and soil level. Towel loads have a minimal amount of soil present and typically

# Troubleshooting Procedures



## WARNING

To avoid risk of electrical shock, personal injury or death, disconnect power to unit before servicing, unless testing requires power.

create more suds.

- Check to see if belt is off motor and pulley.
- Run the clothes washer through another complete cycle using the coldest water, tablespoon of salt and no detergent.

### Wet Clothes

- Very small clothes loads can cause unbalanced loads. Add additional towels.
- Excessive suds may have been present, due to not using High-Efficiency detergent. Reduce amount of detergent usage.
- See **Will Not Spin**.
- Low Spin Speed was selected.

### Will Not Lock

- Door not all the way closed or not properly aligned. Possible laundry load is too large to close door.
- Place washer into **Service Mode** and check for diagnostic codes.
- Perform **Board Output Test**. Check door lock system.
- Check electrical connections at lock switch assembly and machine control board (CN2).

### Will Not Unlock

- Push door closed to make sure nothing from inside is pressing against it, which may keep it from unlocking.
- Display shows **door**. Press **Off, Start/Pause** or unplug washer. Door will unlock after 3 minutes.
- Door locked from water level too high. Opening door will result in water draining from door opening.
- Place washer into **Service Mode**.
- Perform **Board Output Test**. Check door lock system for loose connections.

### Will Not Drain

- Check for restricted drain system.
- In cold climates check for frozen drain hose.
- Check for voltage at the pump when a spin cycle is selected.
- Check pump motor winding resistance. (14.2 ohms)
- Go to **Board Output Test** and perform Pump Out Test.
- Check the machine control board connections at CN3 (Pin 1) for the pump. Should see 110-120VAC.
- Check tub to pump hose for twist in hose.

### Wrong Water Temperature

- Too Hot/Too Cold: This washer uses a reduced amount of water, while the control board meters the incoming flow to regulate the actual temperature of the water in the tub. This may appear to be significantly warmer/cooler than expected.
- Make sure the temperature selection is correct.
- Disconnect inlet hoses from the Water Valve and clean the valve screens of any debris.
- Go to Board Output Test and perform Heater and Thermistor test.

### Noisy and/or Vibration/Walking

- Check if the washer was properly leveled and the locking nuts are securely tightened up against the base frame of the washer.
- Check and determine all five of the shipping bolts and spacers have been fully removed from the rear panel of the washer.
- Check for proper load size and distribution. If clothes load is too small, add a few towels to balance the clothes load better.
- Check the tightness of the rear pulley bolt. Tighten if necessary.
- Clean floor and bottom side of washer feet.

### Rubber Feet Leaving Marks on Floor

- Use a pencil eraser to remove mark.
- Walk washer into location, do not drag.

### Additive Cups Full of Water

- Small amount of water in bottom of additive cups is normal.
- Remove and wash Dispenser Tray, removable Cup, and Rinse Cap.
- Level washer.

### Buttons do not Respond

- Options cannot be changed while cycle is running. Press **Start/Pause** once to pause cycle while making selections. Press **Start/Pause** again to restart washer.
- Child Lock feature has been selected. To disable feature press and hold **Prewash** and **Delay Start** simultaneously until a beep is heard.
- When display shows "**End**", only the **Power Off** button will function. Press **Power Off** and make new cycle selections.

# Troubleshooting Procedures



## WARNING

To avoid risk of electrical shock, personal injury or death, disconnect power to unit before servicing, unless testing requires power.

### Service Mode

Service Mode enables service personnel to verify the operation of the washing machine and diagnose problems. Service Mode can be entered in the middle of any wash cycle without interrupting the cycle. While in Service Mode, the technician can cancel the current cycle, set a continuous running mode, start a variety of special service tests and view diagnostic displays.

### Enter / Exit Service Mode

To enter Service Mode press the **Temperature** and **Rinse** keys, then press the **Power On/Off** key.

**NOTE:** The washer must be on before Service Mode can be entered.

The model number of the washer will be displayed for one second followed by "t1".

To exit:

- 1) Press **Off**, or
- 2) Unplug the machine.

Pressing the **Start/Pause** button while running a test will pause the individual test, while remaining in Service Mode.

### Component Test

While in Service Mode, pressing the **Start/Pause** button will cycle the Pre Valve on/off, Cold Valve on/off, Hot Valve on/off, Drain Pump on/off, Motor clockwise (50rpm), Motor counterclockwise (50rpm), Heater on/off.

### Thermistor Test

While in Service Mode, pressing the **Delay Start** (Two times) followed by the **Start/Pause** button will display the temperature inside the tub.

### Unbalance Test

While in Service Mode, pressing the **Delay Start** (Three times) followed by the **Start/Pause** button will display the unbalance value.

### Abbreviated White/Cottons Cycle Test

While in Service Mode, pressing the **Delay Start** (Four times) followed by the **Start/Pause** button will start an abbreviated White/Cottons cycle.

### White/Cottons Cycle Test

While in Service Mode, pressing the **Delay Start** (Five times) followed by the **Start/Pause** button will start a White/Cottons cycle.

### Spin Test

While in Service Mode, pressing the **Delay Start** (Six times) followed by the **Start/Pause** button will start a spin test. Washer will spin up to 1400 rpm.

### Rinse And Spin Test

While in Service Mode, pressing the **Delay Start** (Seven times) followed by the **Start/Pause** button will start a rinse and spin test. Washer will rinse and spin up to 1400 rpm.

### Board Output Test

To test the EEPROM press and hold the **Rinse**, **Prewash** and **Delay Start** followed by the **Power On/Off** switch. All LED's will light. If test is passed display will show "Eg" or "Et".

Press the **Temperature** key (Once) followed by the **Start/Pause** button will cycle the following:

Component	Display	Cycle Time
Pre Valve	95C LED	0.3sec
Cold Valve	60C LED	0.3sec
Hot Valve	40C LED	0.3sec
Drain Pump	30C LED	0.3sec
Heater	Cold LED	0.3sec

### Motor Output Test

Enter the Board Output Test then press the **Temperature** key (Twice) followed by the **Start/Pause** button to test the motor. Motor will rotate Counterclockwise stop then rotate clockwise and turn off.

### LED/Switch Test

Enter the Board Output Test then press the **Temperature** key (Three times) followed by the **Start/Pause** button to test the LED's.

Button Selection	Display
Start/Pause	All cycle LED's
Temperature	Wash, 95C, 60C, 40C, 30C, Cold LED's.
Rinse	Rinse 321 LED's.
Spin rpm	Spin, 1400, 1200, 800, 400, Rinse Hold LED's.
Prewash	Door Lock, 7-Segment, Prewash LED.
Delay Start	Child Lock, Delay Start LED's

### Diagnostic Codes

When the washer generates a diagnostic code an audible signal will play for 5 seconds along with the



# Troubleshooting Procedures



## WARNING

To avoid risk of electrical shock, personal injury or death, disconnect power to unit before servicing, unless testing requires power.

error code displayed in the 7-segment window. Washer will stop functioning until the error code is cleared. To clear a error code press the **Power** button.

### Diagnostic Codes

Diag. Code	Description	Trigger	Action to be taken
5E	No Drain	The water level fails to drop below the Low Water level reset within 10 minutes.	Displays " <b>5E</b> " Go to " <b>Will Not Drain</b> " Troubleshooting Section. Press <b>Start/Pause</b> to resume washer operation.
door	Door open error	Door is open and washer is paused	Close door
LE	No Fill	Washer tried to fill 4 times but did not reach safe water level for the heater.	Displays " <b>LE</b> " Go to " <b>No Water Fill</b> " Troubleshooting Section
4E	Water level sensor fault.	No change in higher frequency above 100Hz for 2 minutes during the initial water fill. Water level doesn't reach the preset level in 10 minutes Washer will beep and pause the wash cycle.	Displays " <b>4E</b> " Go to "No water fill Troubleshooting". Press <b>Start/Pause</b> to resume washer operation.
HE2	Heater is not heating	Heater has been on for 10 minutes and water temperature has not increased.	Check for: Loose wire connections to heater and thermistor. Faulty thermistor Faulty heater Low water fill.
HE1	Heater is over heating	Heater runs continuously.	Check for: Faulty thermostat Faulty heater Low water fill.

Diag. Code	Description	Trigger	Action to be taken
UE	Unbalance detected during final spin, which prevented the spinner from exceeding 400 rpm	Never exceeded 400 rpm due to an unbalanced load. If detected, washer will pause and alert user to redistribute the load.	LED – Will display " <b>UE</b> " Go to "Machine Control Board Output Test"
CE	Water temperature fault	Water fill is above 40 degrees. This is above set temperature for the cycle selected.	Drain begins if above 40 degrees is sensed at the time of water fill for Delicates, Wool, and Hand wash cycles.
OE	Water sensor level fault.	Water level in the machine is believed to be above the overflow level. When this condition is detected, the machine will automatically begin pumping water out of the machine until it falls below the overflow level.	First check to see that water valve is not stuck. If water valve is OK, check water level sensor
IE	Water sensor fault	Frequency signals generated by water level sensor over 5sec. Low:30.0kHz High:15.0kHz	Pressure S/W Error. Drain water for 3 minutes. Check Pressure Switch continuity page 10.
13E	Signal for MAIN PCB is not detected for 10 seconds.		Displays " <b>13E</b> ". Replace Machine Control Board.

# Troubleshooting Procedures



## WARNING

To avoid risk of electrical shock, personal injury or death, disconnect power to unit before servicing, unless testing requires power.

Diag. Code	Description	Trigger	Action to be taken
tE	Sump thermistor failure	Abnormal high/low temp or ohm resistance seen	Displays "tE". - Loose or pinched wires - Bad sump thermistor
3E	Motor failure	Motor speed indicator error. Motor won't turn.	Displays "3E". Check the motor windings, the speed sensor, wiring connections, or Control Board.
8E	Motor fault	Motor locked causing a spike in voltage.	Replace motor
PF	Power Failure	Cycle interrupted by a power loss. Door has been unlocked.	Displays "PF" Close door press Start to resume operation.

### Exit Service Mode



To exit:

- 1) Press **Spin** and **Temperature** keys for 3 seconds again, or
- 2) Press **Off**, or
- 3) Unplug the machine. Pressing the **Off** key will completely exit Service Mode. If a cycle is running, cancel the cycle. Pressing the **Start/Pause** key while running a test will pause the individual test, while remaining in Service Mode. A power loss during Service Mode will cancel this mode.

# Component Testing Information

## ! WARNING

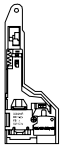
To avoid risk of electrical shock, personal injury or death, disconnect power to unit before servicing, unless testing requires power.

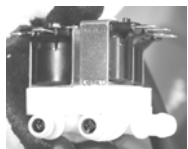
Illustration	Component	Test Procedure	Results
	Thermistor	Unplug harness connector and test from wire insertion side.  Pin #3 and Pin #4 of CN1	12 k ohms @ 77° F /25° C.
	Door Lock	Unplug harness connector and test Door Lock terminals.  Between Term 3 and 5	1000 ohms ±5%
	Motor	Unplug harness connector and test Motor terminals.  Between any 2 pins Pin #1,#2, or #3	3.5 ohms
	Drain Pump	During drain check voltage at Pin #1 of Heater Relay and Pin #6 of CN2	230V AC (During drain)
	Water Valves	Unplug harness connector and test from wire insertion side.  (Hot valve) Pin #5 of CN2 and Pin #1 of Heater Relay (Pre valve) Pin #1 of CN2 and Pin #1 of Heater Relay (Cold valve) Pin #2 of CN2 and Pin #1 of Heater Relay	4500 ohms 4500 ohms 4500 ohms
	Heater 230V AC 2000W Thermal Fuse 128C/262.4F	Unplug harness connector and test from wire insertion side.  Pin #2 of Heater Relay and Pin #2 of Power Relay	Approx 23-29 ohms ± 5%
	AC Power	Check voltage at Pin #1 of Heater Relay and Pin #1 of Power Relay	230V
	Reactor	Unplug harness connector and test from wire insertion side.  Pin #1 of CN6 and Pin #2 of CN6	Approx 0.8 ohms ± 5%

# Component Testing Information

## ⚠ WARNING

To avoid risk of electrical shock, personal injury or death, disconnect power to unit before servicing, unless testing requires power.

### Component Diagnostics

**NOTE:** For ohm checks unplug harness connector on console and test from wire insertion side of the harness connectors.

- Pin 1 Pre Valve
- Pin 2 Cold Valve
- Pin 3 Door Lock
- Pin 4 Blank
- Pin 5 Hot Valve
- Pin 6 Drain Pump
- Pin 7 Blank
- Pin 8 Blank

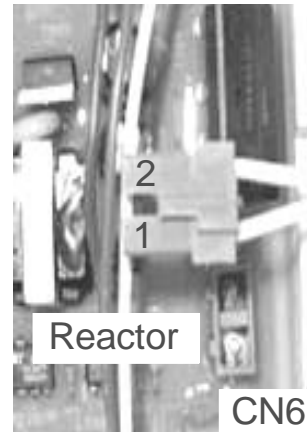
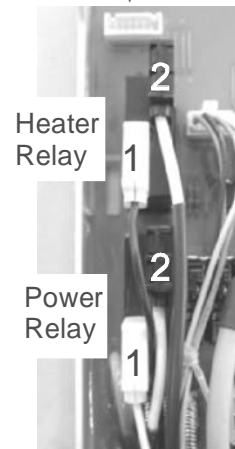
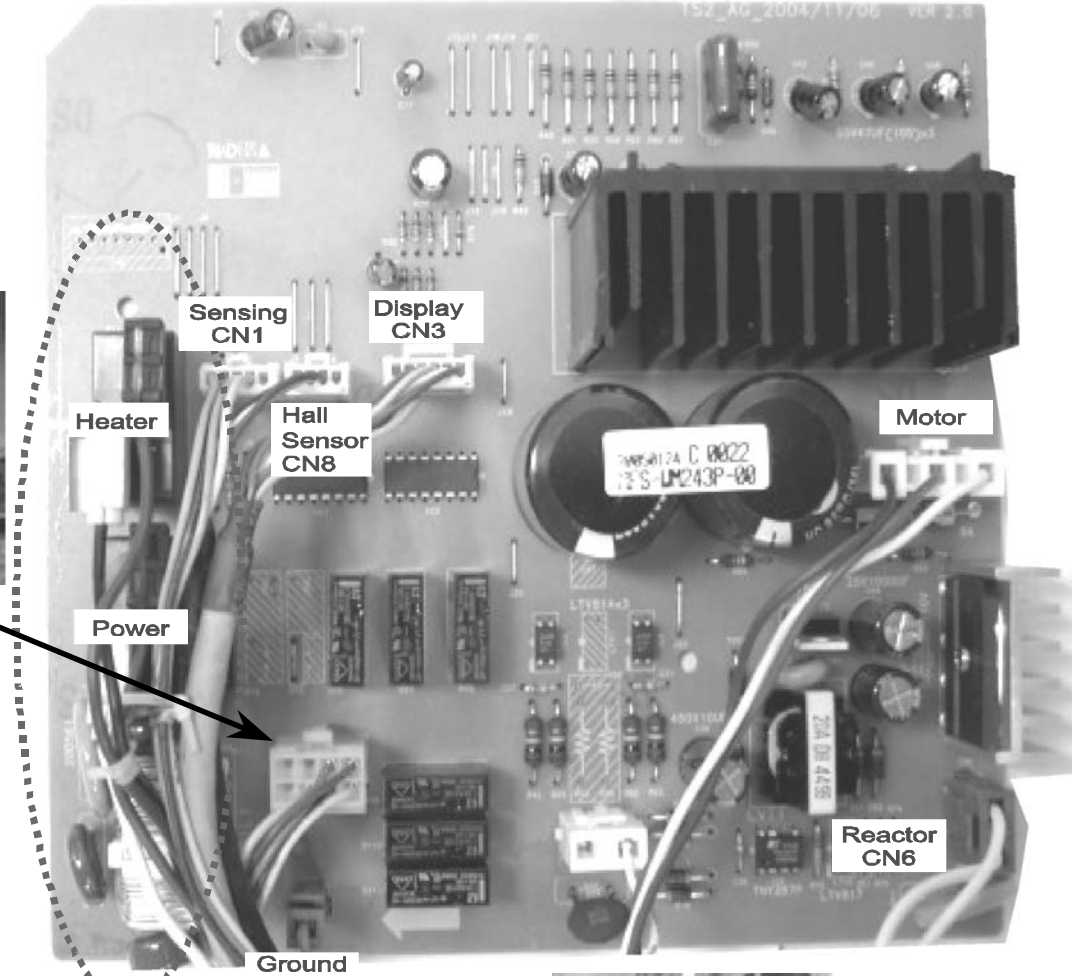

# Component Testing Information



## WARNING

To avoid risk of electrical shock, personal injury or death, disconnect power to unit before servicing, unless testing requires power.

### Motor 220/240V 50Hz

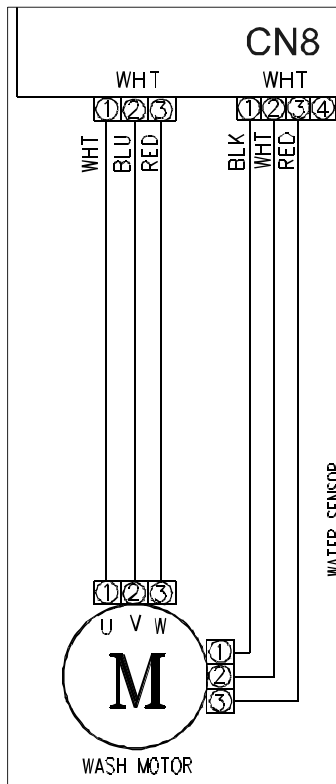
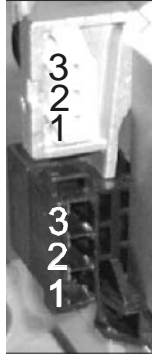
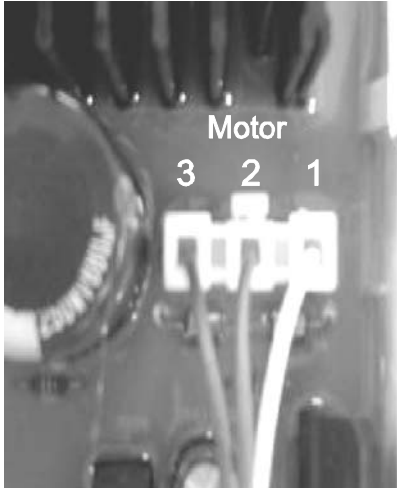

# Component Testing Information

## **WARNING**

To avoid risk of electrical shock, personal injury or death, disconnect power to unit before servicing, unless testing requires power.

### Water Flow Through The Dispenser During Wash

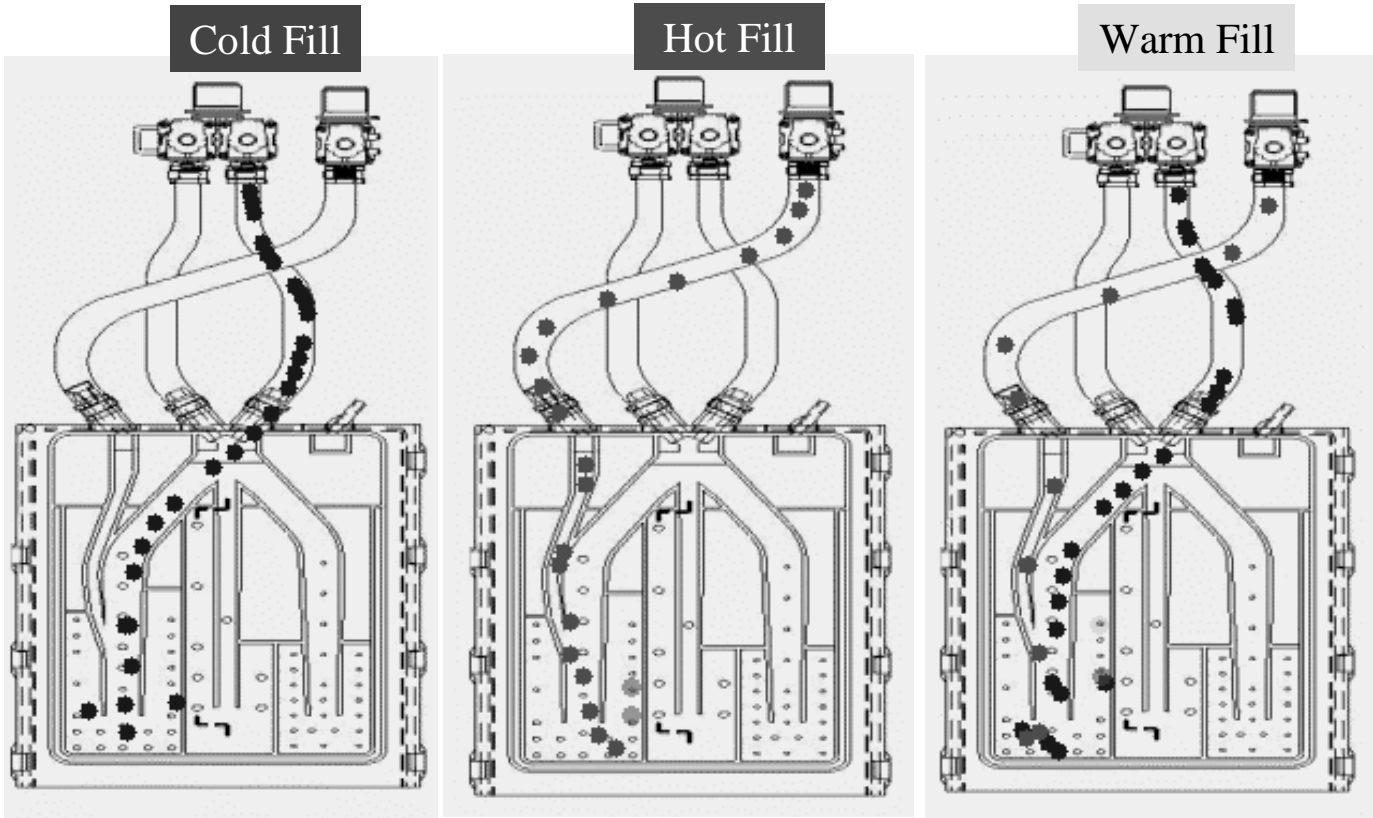

### Rinse 1 Bleach Fill

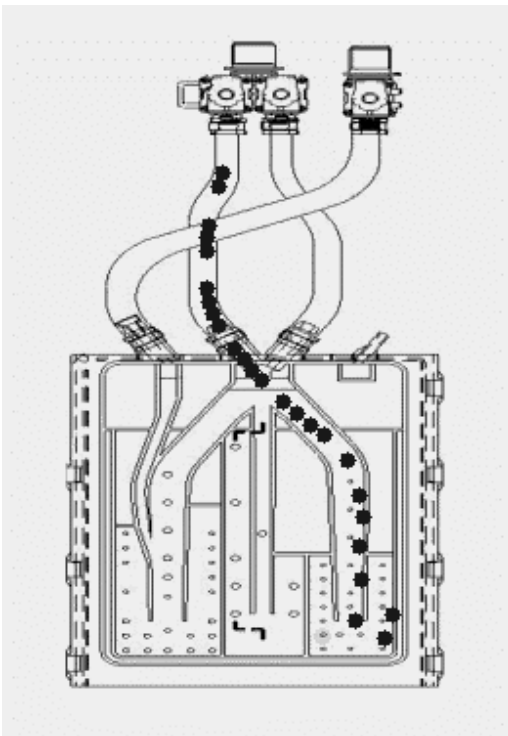

### Rinse 2 Fabric Softener

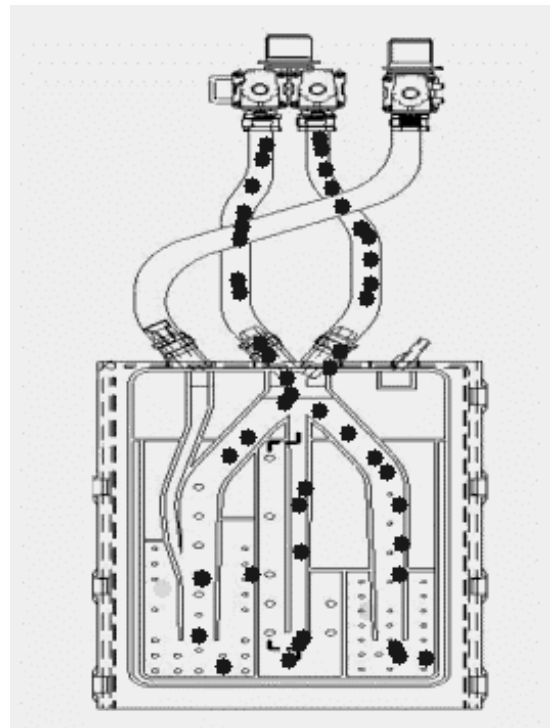



# Disassembly Procedures



## WARNING

To avoid risk of electrical shock, personal injury or death; disconnect power to unit before servicing.

### Top Removal

1. Disconnect power supply to unit.
2. Remove 2 screws from washer back.

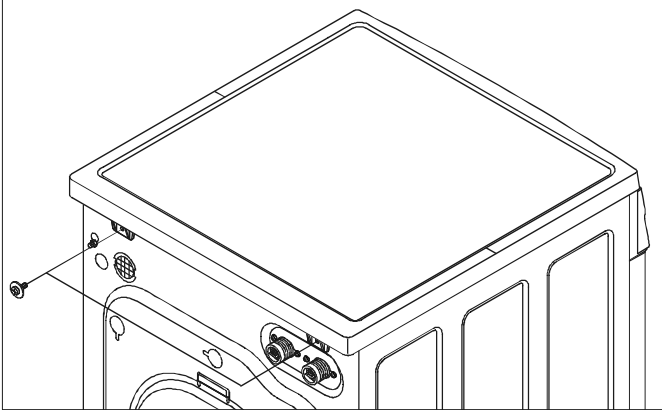

3. Slide Top Cover to the rear of the washer and separate from cabinet.

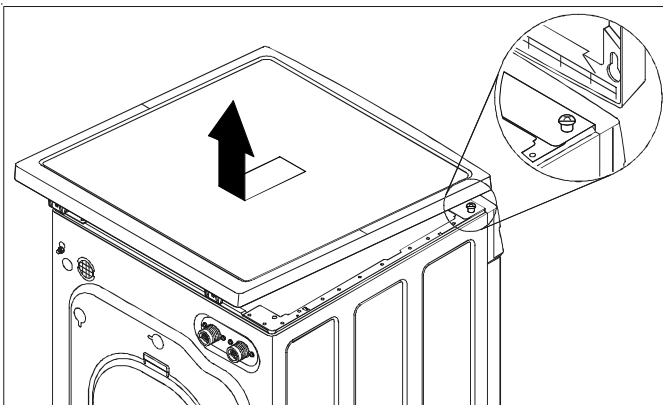

### Water Valve Removal

1. Disconnect power supply to unit.
2. Remove Top Cover.
3. Remove hoses.

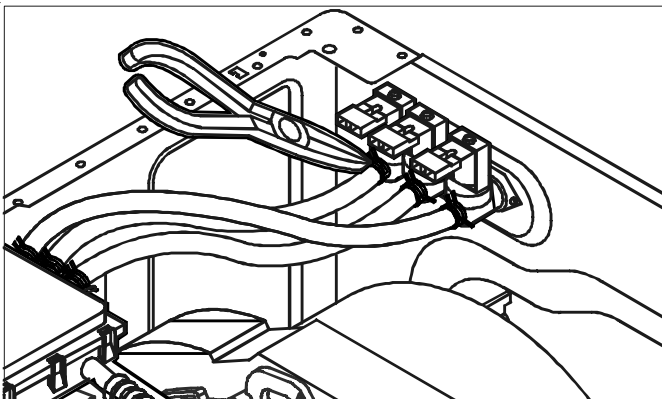

4. Remove connectors.

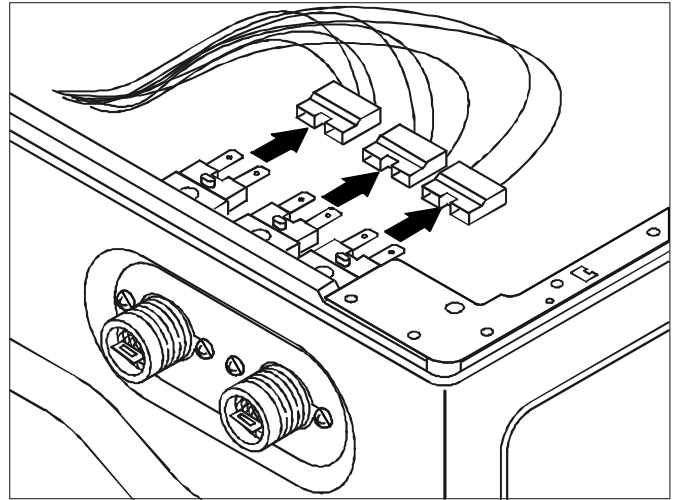

5. Remove screws retaining Water Valves.

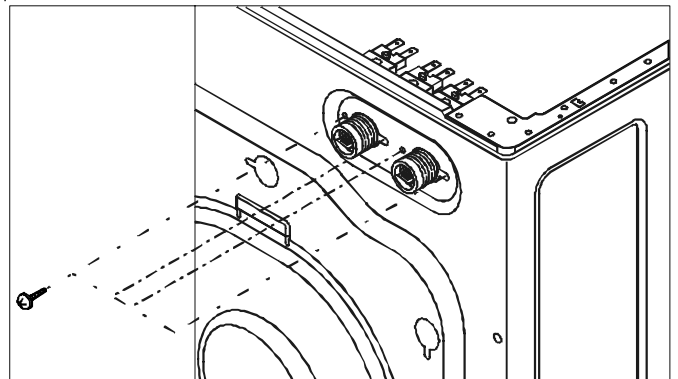

### Pressure Valve Removal

1. Disconnect power supply to unit.
2. Remove Top Cover.
3. Remove Wiring connectors.
4. Remove mounting screw.

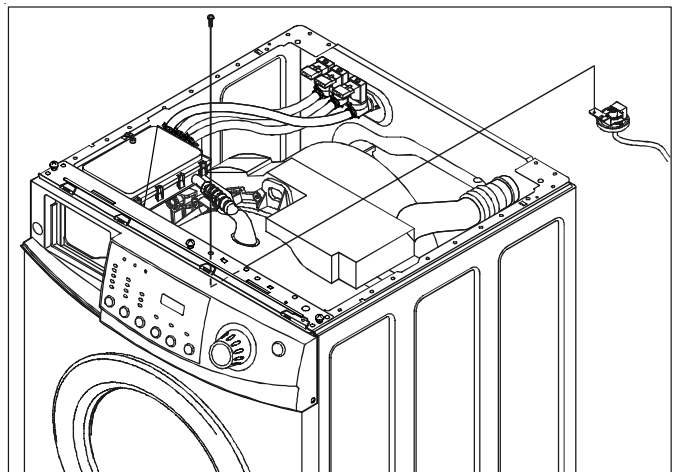

# Disassembly Procedures



**WARNING**

To avoid risk of electrical shock, personal injury or death; disconnect power to unit before servicing.

## Drain Pump Removal

1. Disconnect power supply to unit.
2. Gain access to bottom of unit.
3. Remove 4 screws securing panel to the bottom of the cabinet.

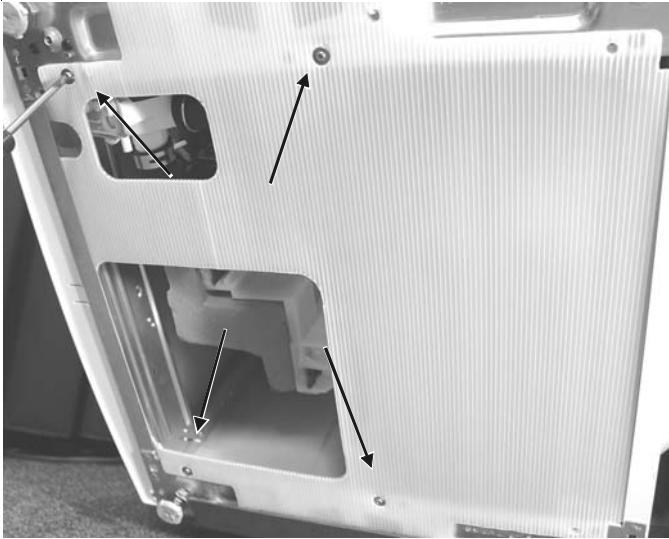

4. Remove drain hose and tub hose from pump.

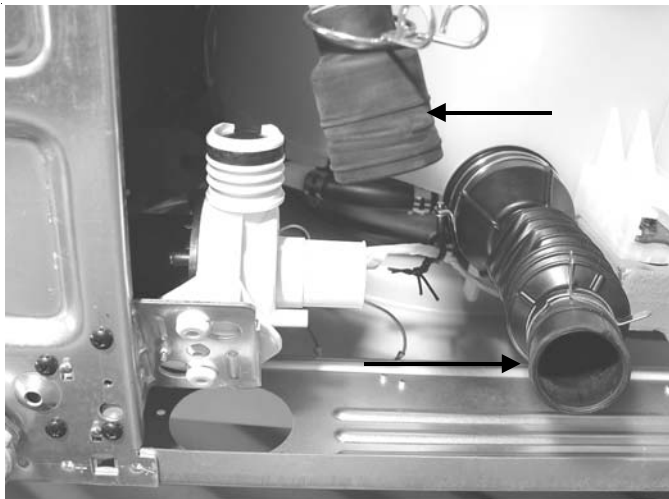

5. Disconnect electrical connector .



6. Remove 4 screws and slide pump mounting bracket to free tabs and remove motor.

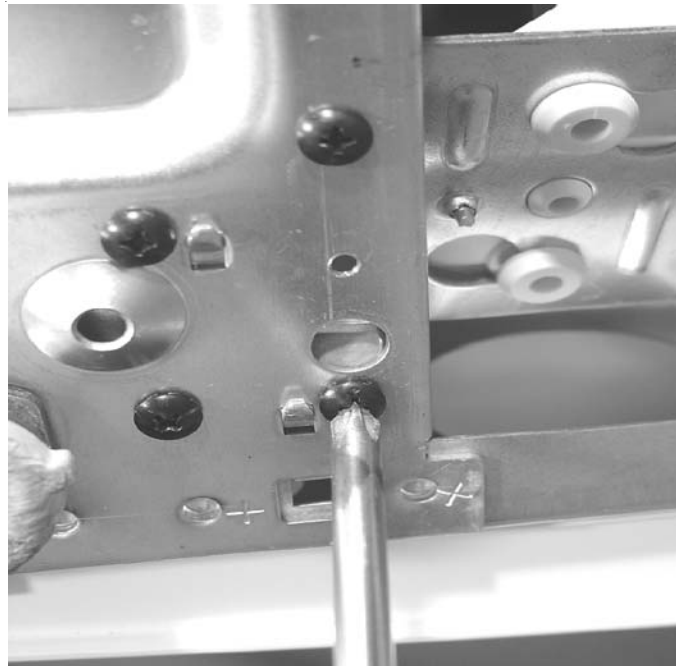



# Disassembly Procedures



## WARNING

To avoid risk of electrical shock, personal injury or death; disconnect power to unit before servicing.

### EMI Filter Removal

1. Disconnect power supply to unit.
2. Remove Top Cover.
3. Remove wiring connectors and ground wires.

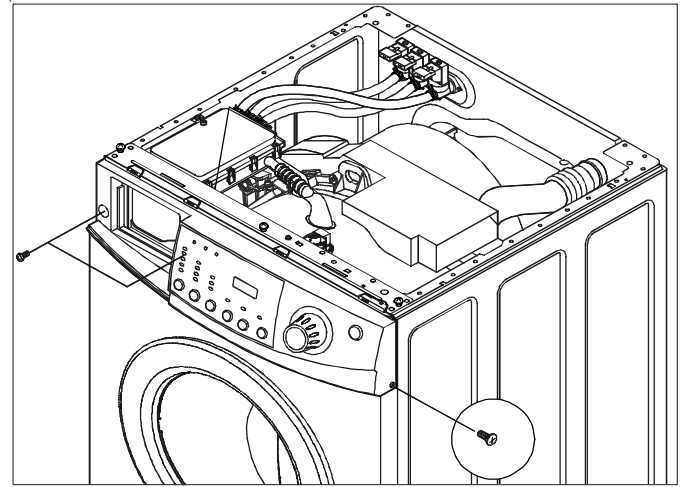
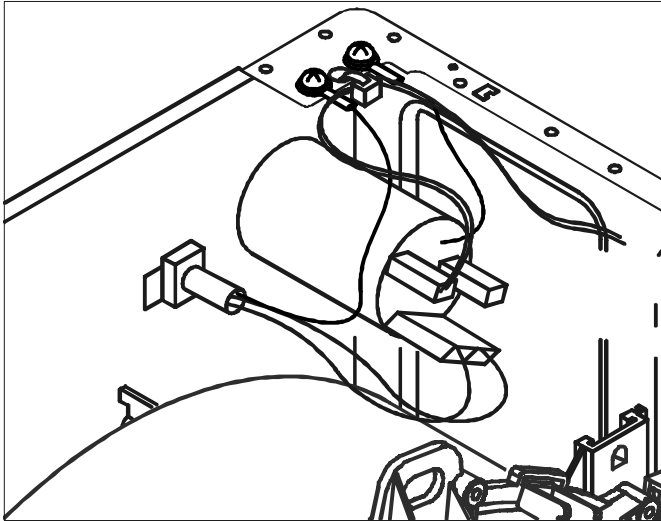

4. Tip Console to access connectors.



**NOTE:** Clip wire ties if necessary to gain access to Control Board.

**CAUTION:** Do not reassemble washer without replacing clipped wire ties. Do not remove wire ties if replacement are not available.

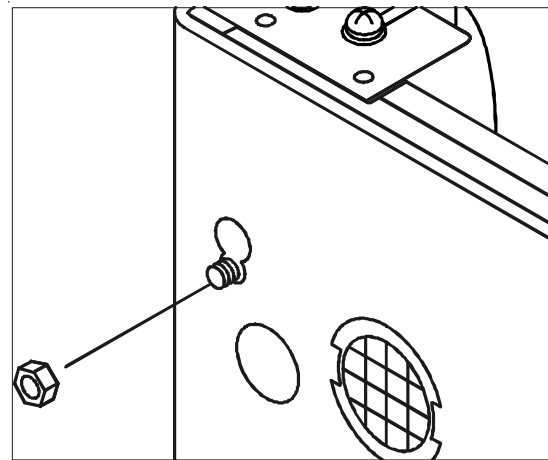

### Console/Machine Control Board Removal

1. Disconnect power supply to unit.
2. Remove Dispenser drawer.
3. Remove 2 screws located behind dispenser. Remove 1 screw on console right side.

5. Remove connectors from Control Board back.

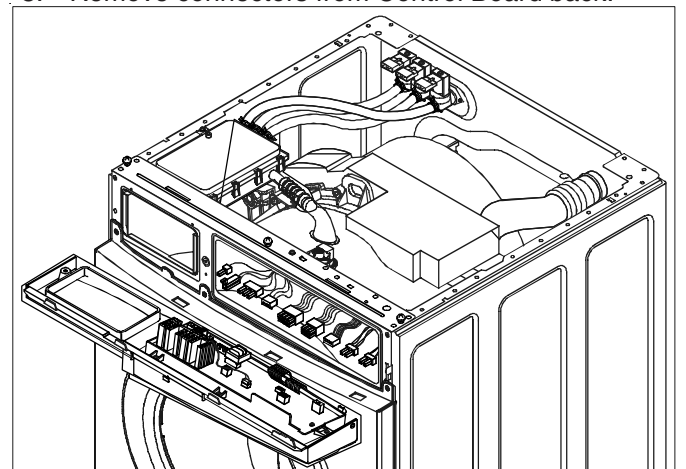

# Disassembly Procedures



**WARNING**

To avoid risk of electrical shock, personal injury or death; disconnect power to unit before servicing.

6. Remove 5 screws retaining Control Board to Console.

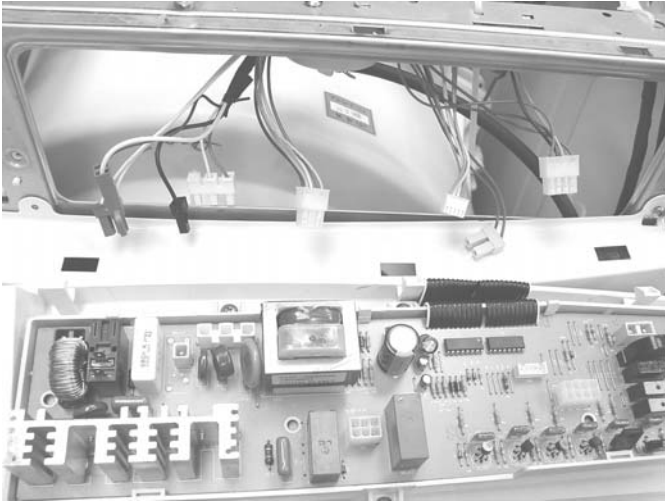

7. Separate the Control Board from the Console.

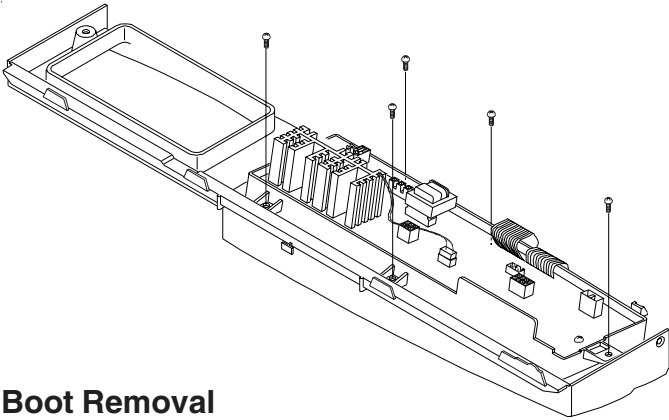

## Boot Removal

1. Disconnect power supply to unit.
2. Remove Boot retainer spring.

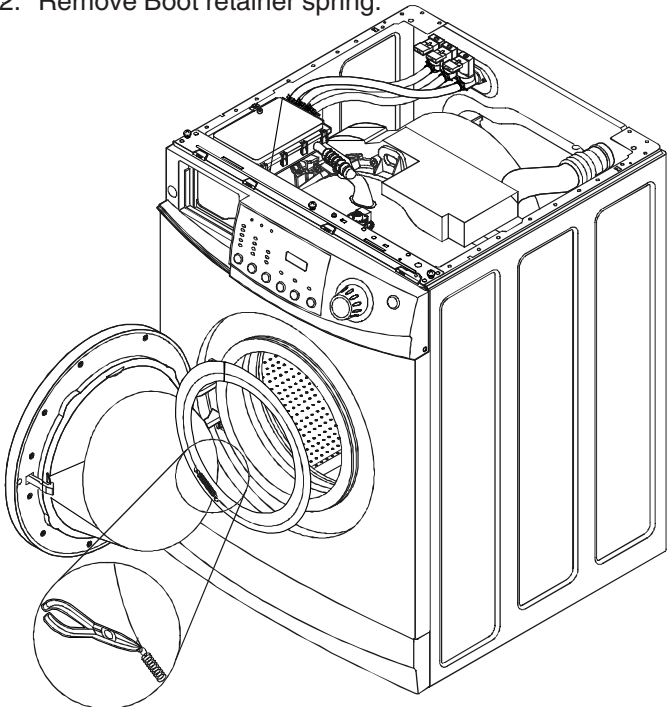

3. Remove boot retainer wire from groove.



4. Pull boot over lip on Front Panel.



## Door Assembly Removal

1. Remove Door Hinge with screwdriver and 5/16" wrench.

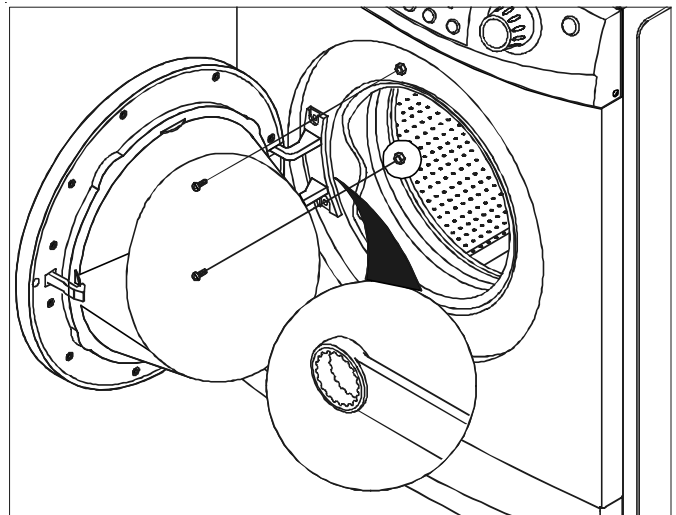

# Disassembly Procedures



**WARNING**

To avoid risk of electrical shock, personal injury or death; disconnect power to unit before servicing.

## Disassemble Door Assembly

1. Disconnect power supply to unit.
2. Remove Door Assembly
3. Remove screws on door inner panel.

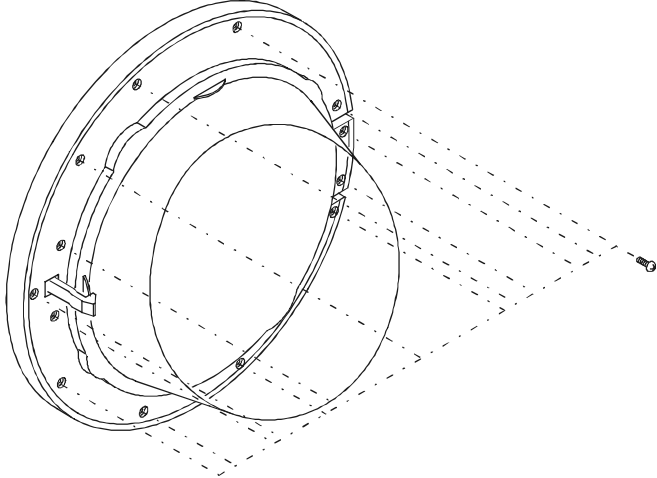

4. Remove pin through door strike.

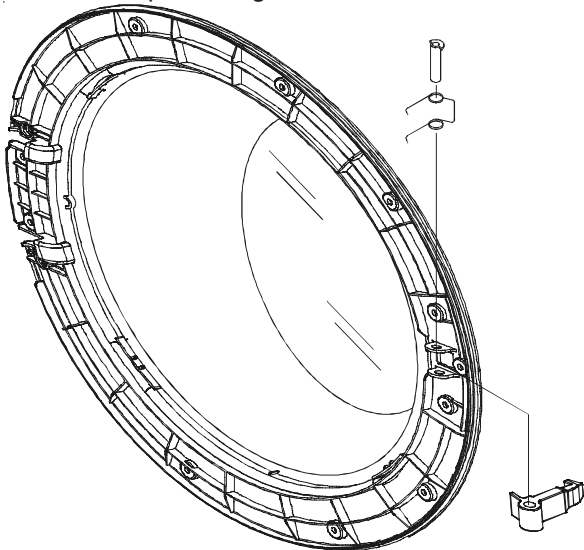

5. Unsnap handle from retainer.

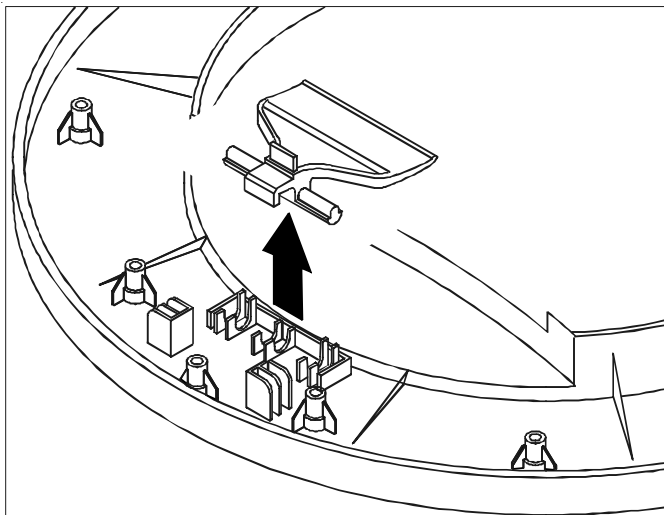

6. Remove glass sight window from frame.

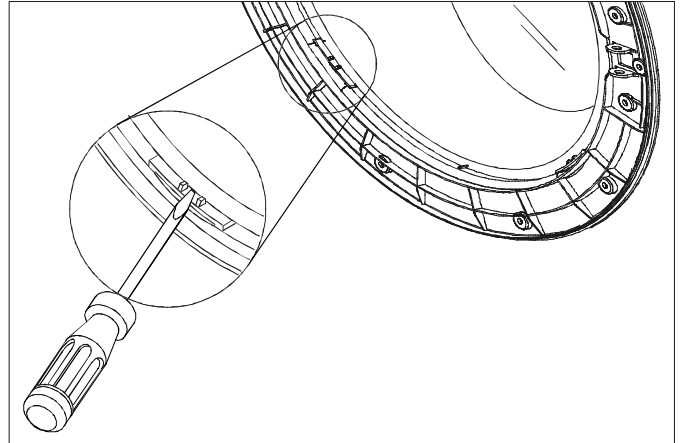

**NOTE:** Align indent in glass with drain hole in frame during reassembly.

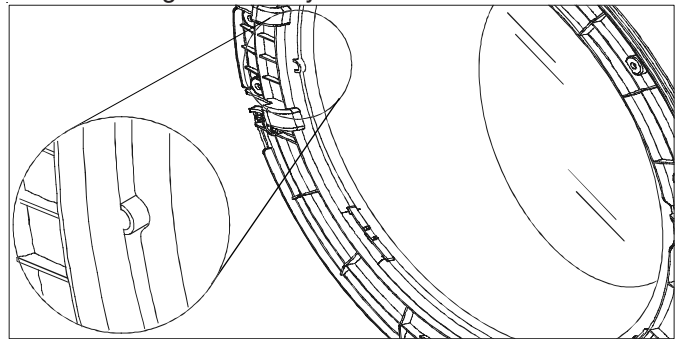

## Front Panel/ Door Latch Removal

1. Disconnect power supply to unit.
2. Remove Console.
3. Remove Toe Panel.

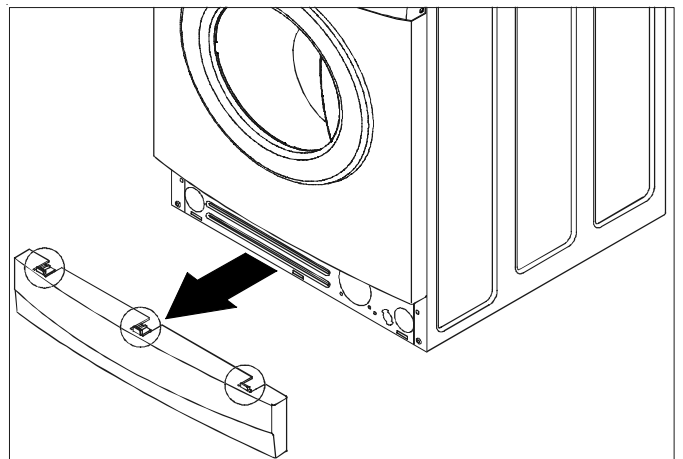

4. Remove 3 screws on Front Panel bottom.



# Disassembly Procedures



## WARNING

To avoid risk of electrical shock, personal injury or death; disconnect power to unit before servicing.

5. Remove 6 screws on Front Panel top and bottom.

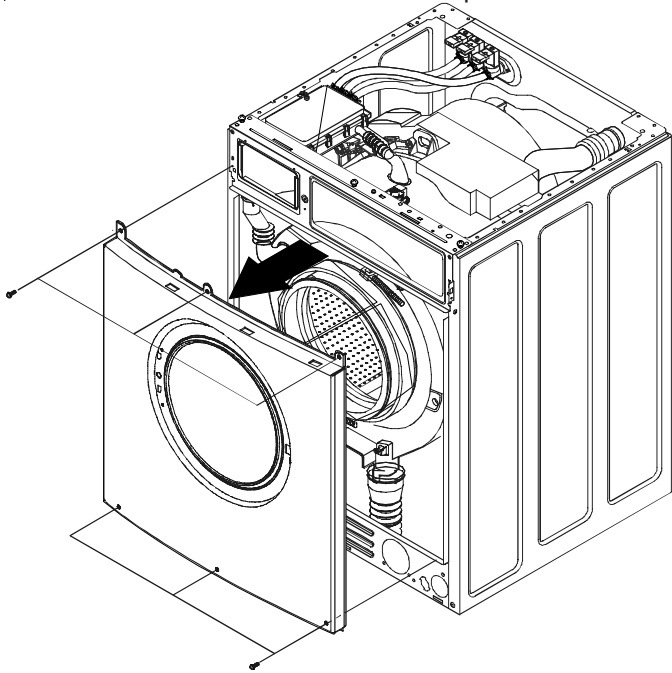

8. Remove 2 screws retaining Door Latch to Front Panel.

### Motor and Belt Removal

1. Disconnect power supply to unit.
2. Remove 3 screws retaining Back Cover.

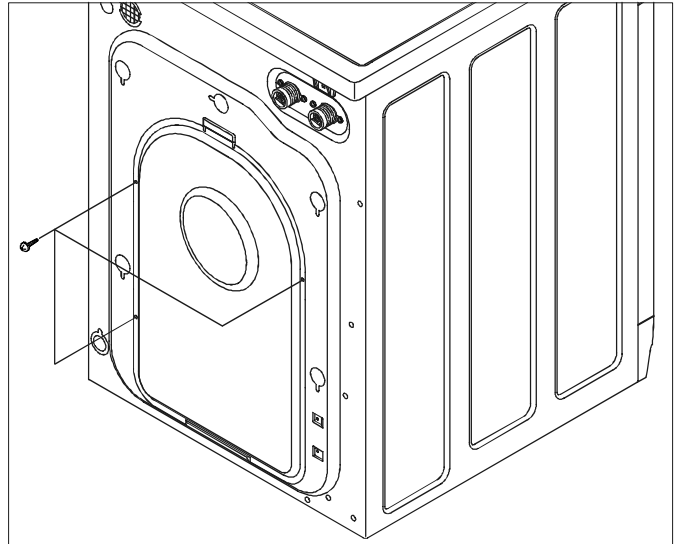

6. Lift front Panel from hanger hooks.



3. Remove belt by pulling belt while rotating pulley causing belt to derail from motor.

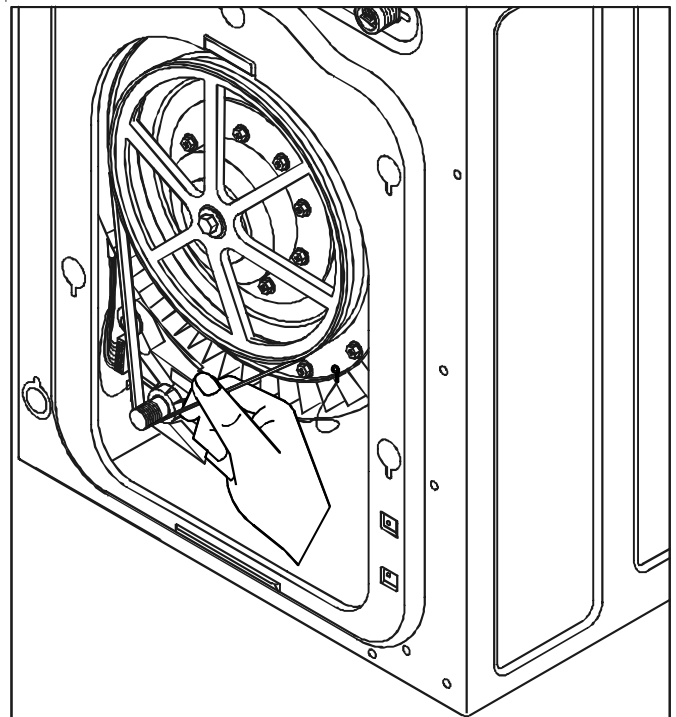

7. Disconnect Door Latch wire connector.

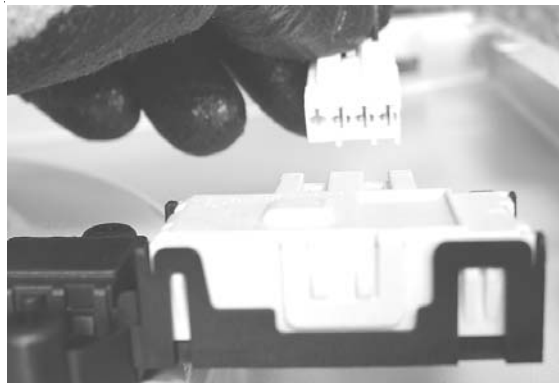

4. Remove Motor wiring connector and ground wires.



# Disassembly Procedures

## **WARNING**

To avoid risk of electrical shock, personal injury or death; disconnect power to unit before servicing.

5. Remove Motor wiring connector and ground wires.

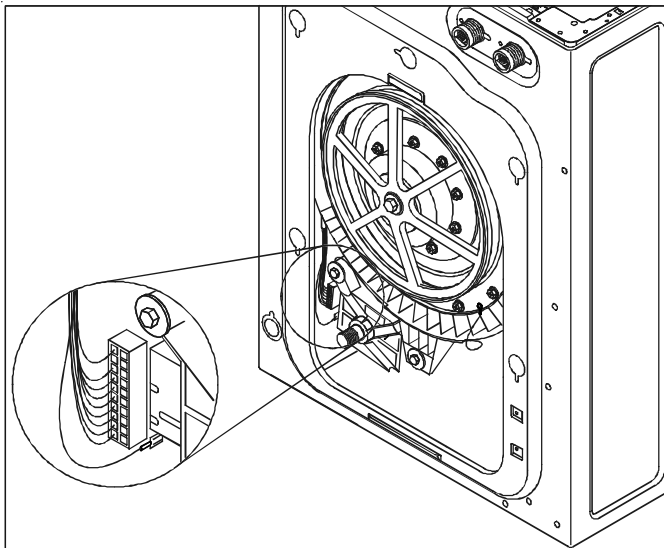

4. Insert a 3/8" drive extension into hole in bearing cover to lock pulley from rotating.



6. Remove 2 1/2" Motor mounting bolts. Bolt torque is 10.8-18.1 ft. lbs.

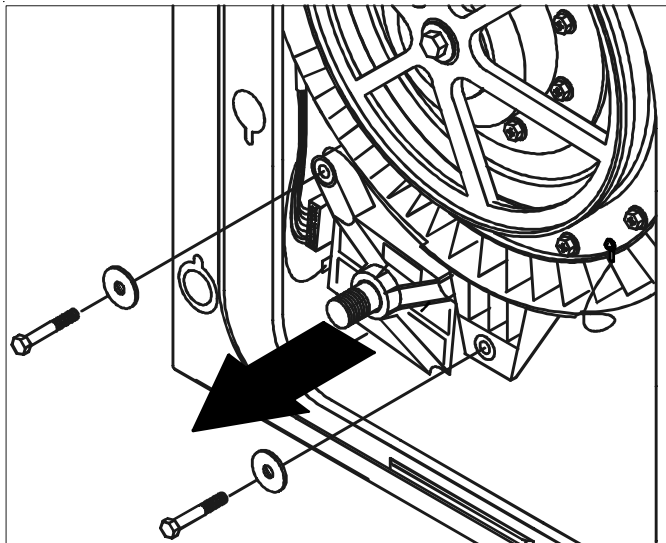

5. Loosen bolt retaining pulley. Bolt torque is 21.7-28.9 ft. lbs.



7. Swing Motor down and to the left to remove.



## **Tub Removal**

1. Disconnect power supply to unit.
2. Remove Top Cover.
3. Remove Back Cover.
4. Disconnect and remove Drive Motor and belt.
5. Disconnect Drain Pump hose and wiring.
6. Remove Front Panel.
7. Remove wire harness and hose from Pressure Switch. Remove the Pressure Hose from tub bottom.
8. Remove Console mounting bracket.

## **Tub Pulley Removal**

1. Disconnect power supply to unit.
2. Remove Back Cover.
3. Remove Belt.

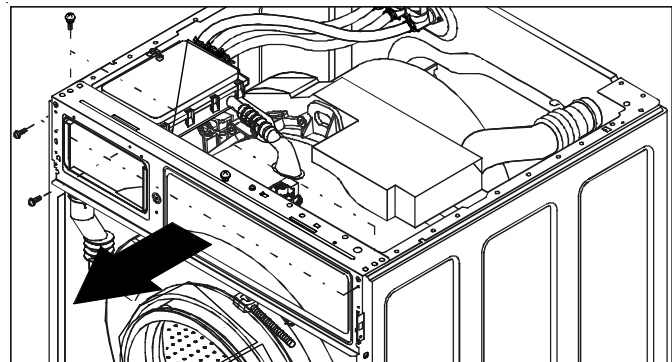

# Disassembly Procedures

## **WARNING**

To avoid risk of electrical shock, personal injury or death; disconnect power to unit before servicing.

9. Remove Fill Hose and Dispenser Hose from Tub.

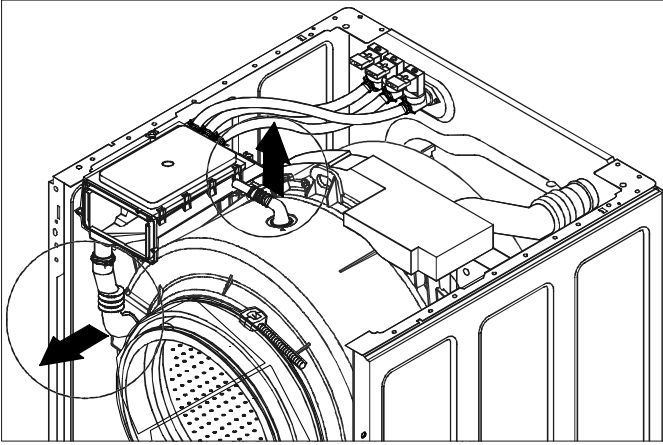

10. Remove Dispenser Feeder Hoses.

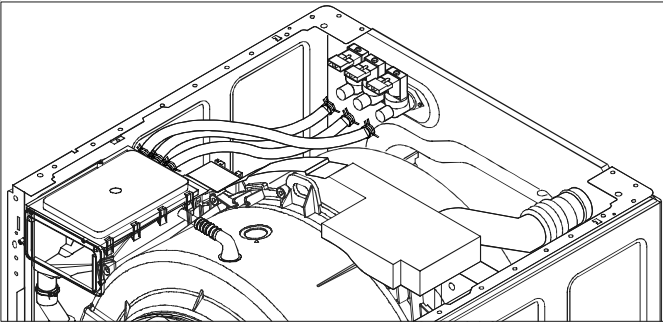

11. Remove screw retaining Dispenser.

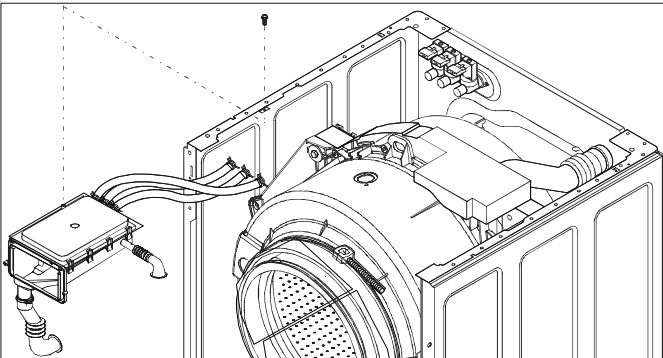

12. Remove Dispenser from washer.

13. Remove 1/2" bolts retaining upper counter weight.

Bolt torque is 10.8 to 18.1 ft. lbs.

14. Remove Upper Counter Weight.

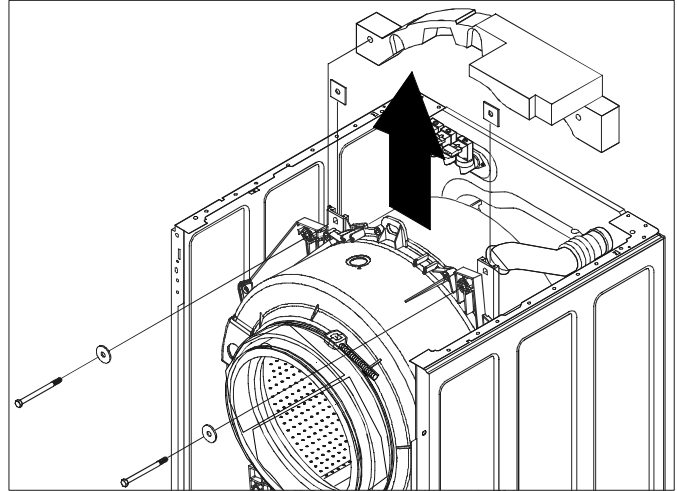

15. Disconnect Sump Thermistor wire harness.



16. Remove 3 1/2" bolts retaining Lower Counter Weight.

Bolt torque is 10.8 to 18.1 ft. lbs.

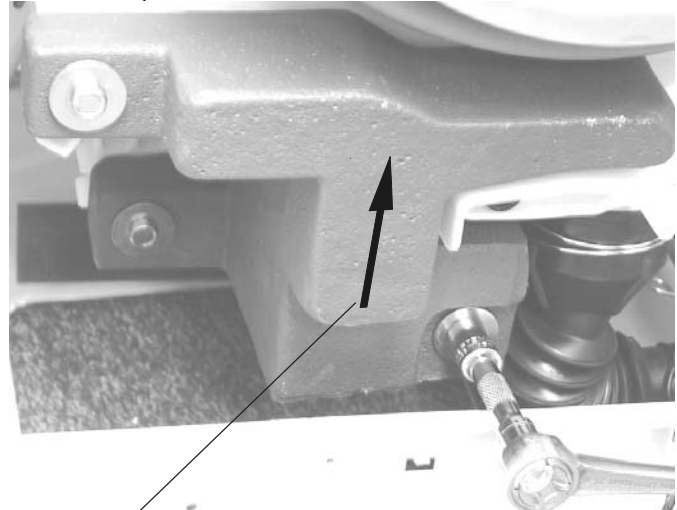

**NOTE:** Mark the counter weight front surface for ease of reassembly.

# Disassembly Procedures

 **WARNING**

To avoid risk of electrical shock, personal injury or death; disconnect power to unit before servicing.

17. Remove Lower Counter Weight.



18. Remove remaining wire harnesses and hose from tub.



19. Remove 2 1/2" bolts retaining the Struts. All Strut bolts are torqued to 18.1-25.3 ft. lbs.

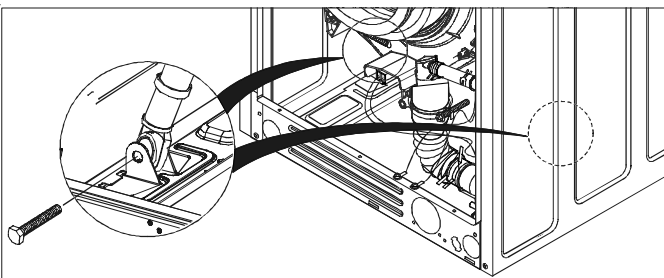

20. Move Struts to center of washer.

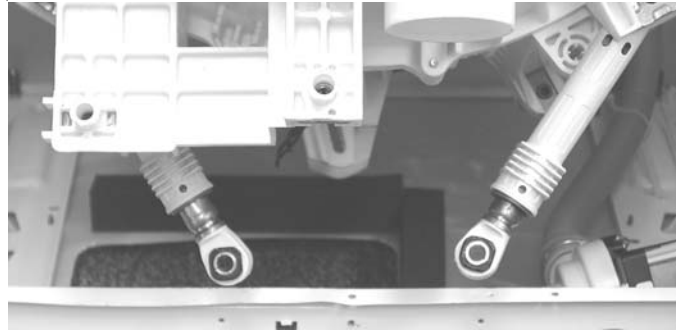

21. Mark location and position of Suspension Springs.

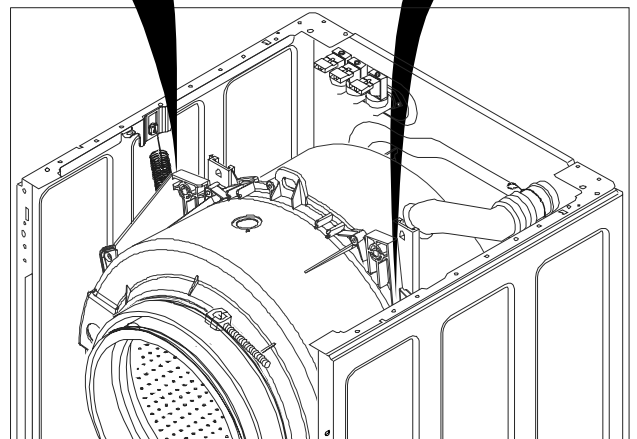
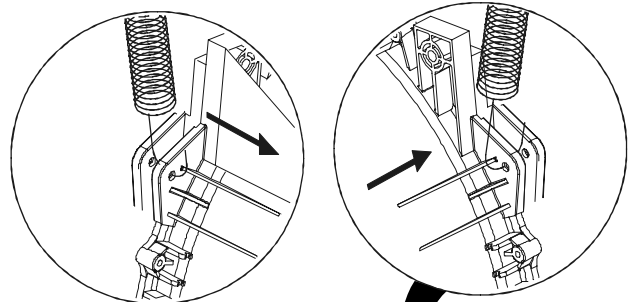

22. Reinstall Upper Counter Weight bolts to tub without weight in place. Use these as handles when lifting tub.





# Disassembly Procedures

## **WARNING**

To avoid risk of electrical shock, personal injury or death; disconnect power to unit before servicing.

23. Use weight bolts to lift tub and unhook Suspension Springs.



24. Grasp the front and rear of the tub and remove from cabinet.

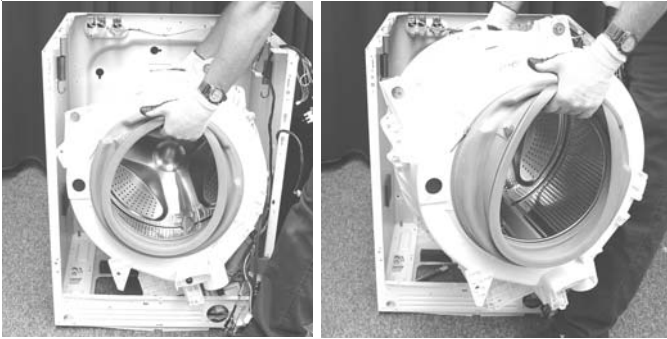

25. Loosen screw and remove boot from tub lip.

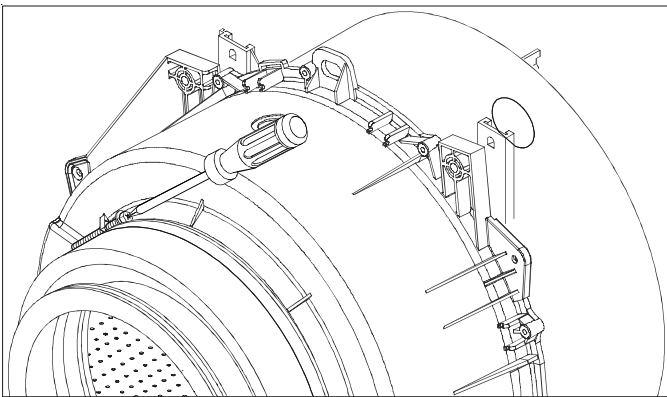

26. Remove rear Spinner Pulley.

NOTE: After Spinner Pulley bolt is removed Spinner can fall from tub. Block Spinner to prevent Spinner from falling free.

27. Remove bolts around perimeter and separate the tub halves.

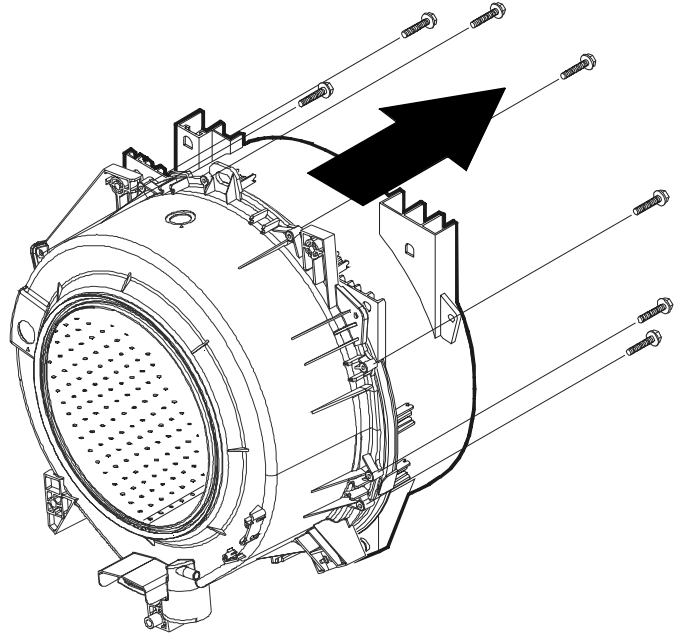

NOTE: During reassembly snug bolts in a cross pattern before tightening to prevent tub warp.

28. Remove Spinner.

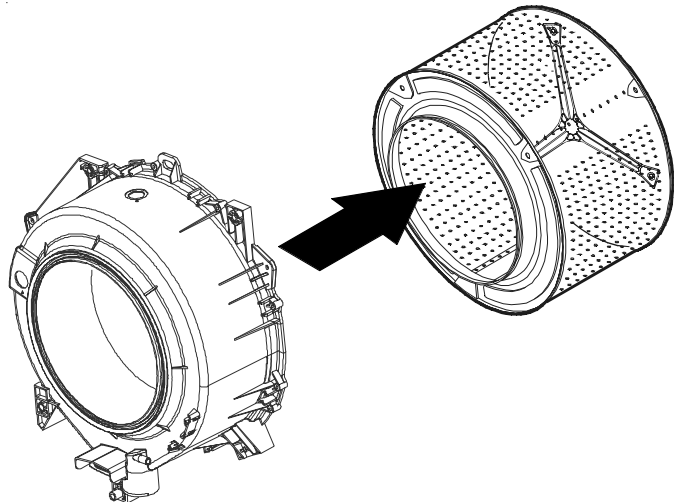



## Disassembly Procedures



### WARNING

To avoid risk of electrical shock, personal injury or death; disconnect power to unit before servicing.

29. Install new Gasket between front and rear tub halves.



30. Install new Spinner and reassemble washer by reversing the preceding steps.

# Appendix A



# Washing Machine Owner's Instructions

**MAH2440AGW**

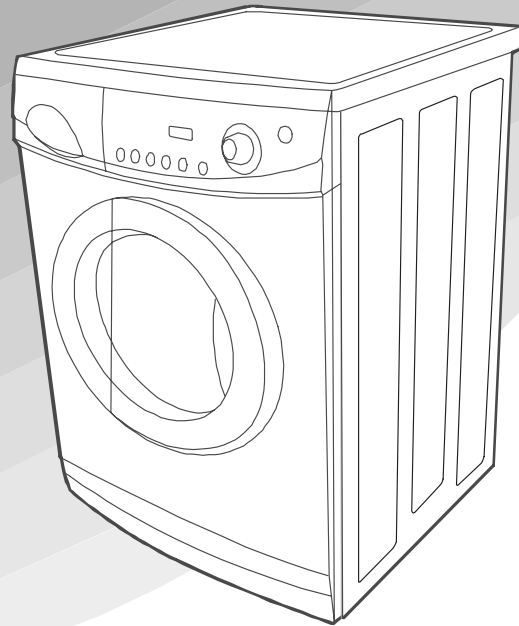

## Safety Precautions

These Owner's Instructions contain valuable information on the installation, use, and care of this appliance. Please take the time to read these instructions so that you can take full advantage of the washing machine's features and enjoy this appliance for many years to come.

### Before using the appliance

- Packing materials can be dangerous to children; keep all packing material (plastic bags, polystyrene, etc.) well out of the reach of children.
- The appliance is designed for home use only.
- Make sure that water and electrical connections are made by qualified technicians, observing the manufacturer's instructions (see "Installing the Washing Machine" on page 2) and local safety regulations.
- All packaging and shipping bolts must be removed before the appliance is used. Serious damage may occur if they are not removed. See "Removing the shipping bolts" on page 3.
- Before washing clothes for the first time, you must run a complete cycle without clothes. See "Washing for the first time" on page 7.

### Safety instructions

- Before cleaning or carrying out maintenance, unplug the appliance from the electrical outlet or set the  $\text{\textcircled{1}}$  (On/Off) button to Off.
- Make sure that the pockets of all clothing to be washed are empty. Hard, sharp objects, such as coins, safety pins, nails, screws, or stones can cause extensive damage to the appliance.
- Always unplug the appliance and turn off the water after use.
- Before you open the door of the appliance, check that the water has drained. Do not open the door if you can still see water.
- Pets and small children may climb into the appliance. Check the appliance before each use.
- The glass door becomes very hot during the washing cycle. Keep children away from the appliance while it is in use.
- Do not attempt to repair the appliance yourself. Repairs made by inexperienced or unqualified persons may cause injury and /or make more serious repairs to the appliance necessary.
- If the plug (power supply cord) is damaged, it must be replaced by the manufacturer or its service agent or a similarly qualified person in order to avoid a hazard.
- This appliance should only be serviced by an authorized service center, and only genuine spare parts should be used.
- This appliance is not intended for use by young children or infirm persons unless they have been adequately supervised by a responsible person to ensure that they can use the appliance safely. Young children should be supervised to ensure that they do not play with the appliance.
- If this appliance is supplied from a cord extension set or an electrical portable outlet device, the cord extension set or electrical portable outlet device must be positioned so that it is not subject to splashing or ingress of moisture. Additionally, the cord extension set or electrical portable outlet device must be of a current rating suitable for the appliance.

● SAVE THESE INSTRUCTIONS

## Table of Contents

<b>Safety Precautions</b> .....	<b>inside cover</b>
<b>Installing the Washing Machine</b> .....	<b>2</b>
Unpacking the washing machine .....	2
Overview of the washing machine .....	2
Selecting a location .....	3
Adjusting the leveling feet .....	3
Removing the shipping bolts .....	3
Connecting the water supply hose .....	4
Connecting the water supply hose(option) .....	5
Positioning the drain hose .....	5
Plugging in the machine .....	6
<b>Washing a Load of Laundry</b> .....	<b>7</b>
Washing for the first time .....	7
Putting detergent in the washing machine .....	7
Overview of the control panel .....	8
Washing clothes using Fuzzy Logic .....	10
Washing clothes manually .....	11
Using delay start .....	11
Washing tips and hints .....	12
<b>Maintaining the Washing Machine</b> .....	<b>13</b>
Draining the washing machine in an emergency .....	13
Repairing a frozen washing machine .....	13
Cleaning the exterior .....	13
Cleaning the detergent drawer and recess .....	14
Cleaning the debris filter .....	14
Cleaning the water hose mesh filter .....	15
<b>Troubleshooting</b> .....	<b>16</b>
Problems and solutions .....	16
Understanding error messages .....	16
<b>Programme chart</b> .....	<b>17</b>
<b>Appendix</b> .....	<b>18</b>
Fabric care chart .....	18
Electrical warnings .....	18
Protecting the environment .....	19
Declaration of conformity .....	19
Specification .....	19

## Installing the Washing Machine

### Unpacking the Washing Machine

Unpack your washing machine and inspect it for shipping damage. Also make sure that you have received all of the items shown below. If the washing machine was damaged during shipping or you do not have all of the items, contact your Maytag dealer immediately.

### Overview of the washing machine

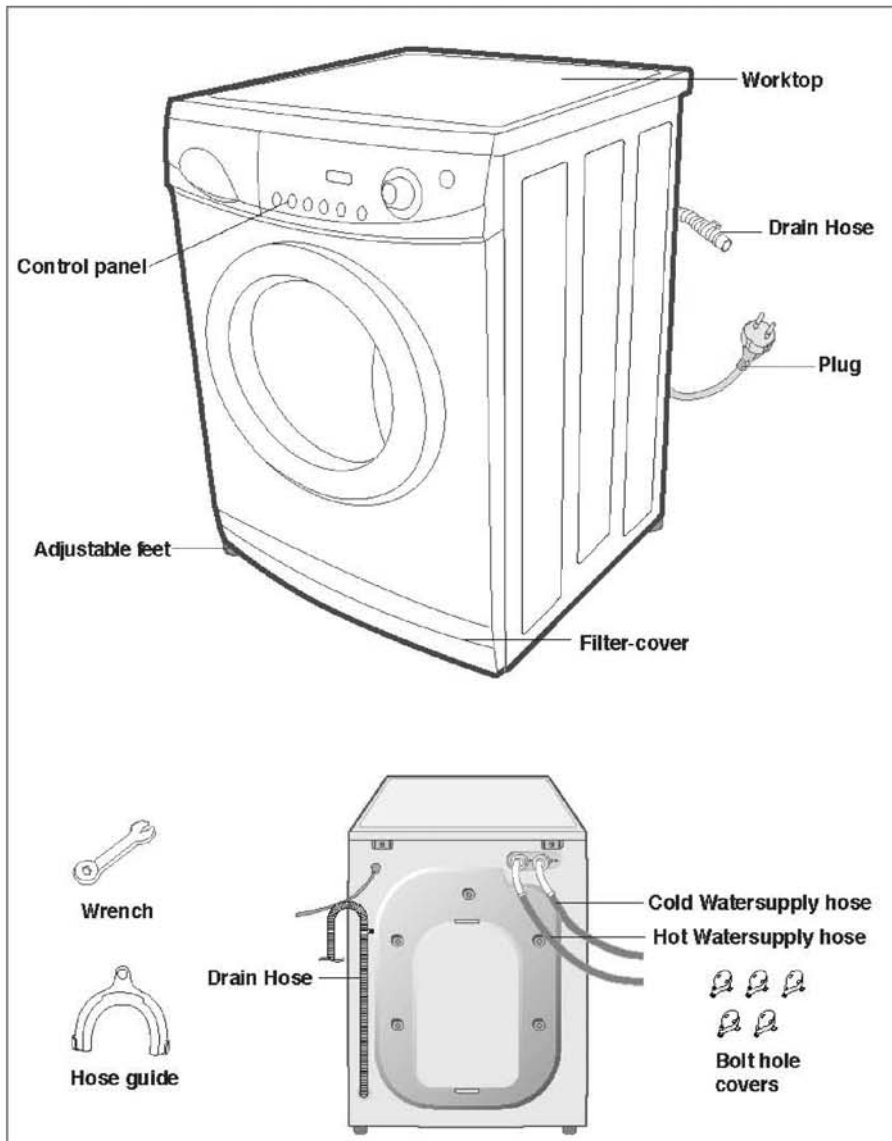

## Installing the Washing Machine

### Selecting a location

Before you install the washing machine, select a location with the following characteristics:

- A hard, level surface (if the surface is uneven, see "Adjusting the leveling feet," below)
- Away from direct sunlight
- Adequate ventilation
- Room temperature that will not fall below 0 °C
- Away from sources of heat such as coal or gas

Make sure that the washing machine does not stand on its power cord.

Ventilation openings must not be obstructed by carpeting when the washing machine is installed on a carpeted floor.

### Adjusting the leveling feet

If the floor is uneven, adjust the feet (do not insert pieces of wood or any other objects under the feet):

1. Loosen the leg bolt by turning it with your hand until it is at the desired height.
2. Tighten the locking nut by turning it with the supplied wrench.

If the washer is placed on an uneven or weak surface, noise or vibration occurs. (Only 1 degree angle is allowed.)

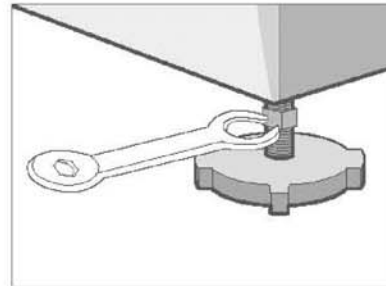

### Removing the shipping bolts

Before using the washing machine, you must remove the five shipping bolts from the back of the unit. To remove the bolts:

1. Loosen all bolts with the supplied wrench before removing them.
2. Take each bolt head and pull it through the wide part of the hole. Repeat for each bolt.
3. Fill the holes with the supplied plastic covers.
4. Keep the shipping bolts for future use.

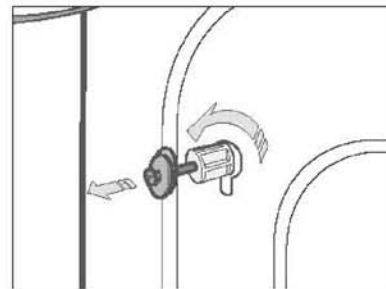



## Installing the Washing Machine

### Connecting the water supply hose

The water supply hose must be connected to the washing machine at one end and to the water faucet at the other. Do not stretch the water supply hose. If the hose is too short replace the hose with a longer, high pressure hose.

To connect the water supply hose:

1. Take the L-shaped arm fitting for the water supply hose and connect to the water supply intake on the back of the machine. Tighten by hand.
2. Connect the other end of the water supply hose to your sink's water faucet and tighten it by hand. If necessary, you can reposition the water supply hose at the washing machine end by loosening the fitting, rotating the hose, and retightening the fitting.

**NOTICE** *The appliance is to be connected to the water mains using new hose-sets and that old hose-sets should not be used.*

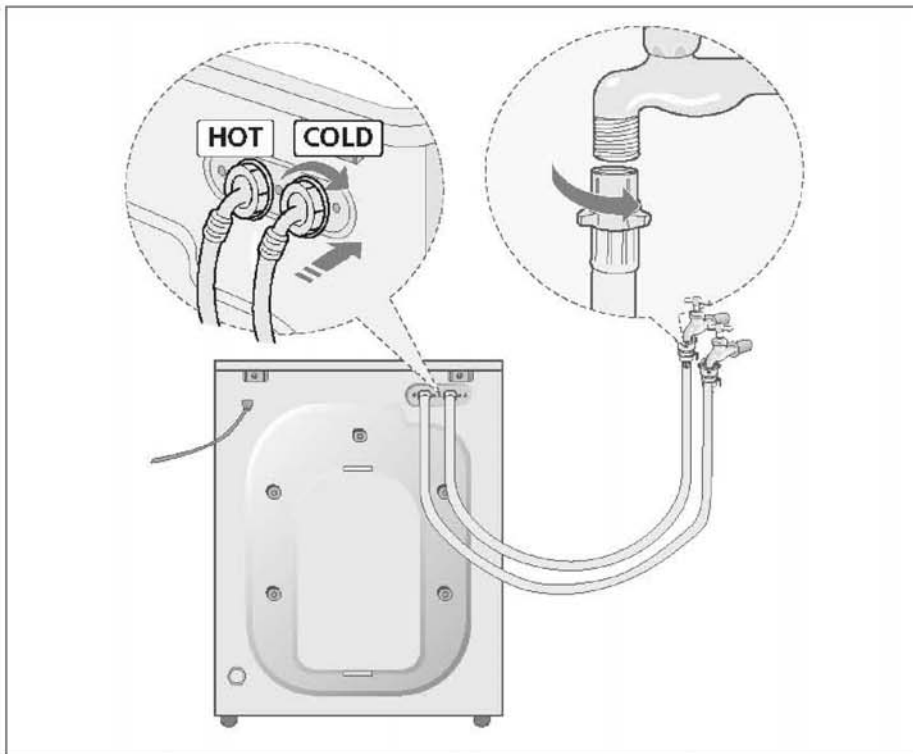



## Installing the Washing Machine

### Connecting the water supply hose (Option)

1. Remove the adaptor from the water supply hose.



2. First, using a "+" type screw driver, loosen the four screws on the adaptor. Next, take the adaptor and turn part (b) following the arrow until there is a 5mm gap.

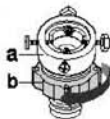

3. Connect adaptor to the water tap by tightening the screws firmly. Then, turn part (b) following the arrow and put (a) and (b) together.

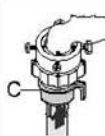
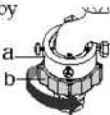

4. Connect the water supply hose to the adaptor. Pull down part (c) of the water supply hose. When you release part (c) the hose automatically connects to the adaptor making a 'click' sound.



5. Connect the other end of the water supply hose to the inlet water valve at the rear of the washer. Screw the hose clockwise all the way in.

**NOTICE** After completing connection, if water leaks from the hose, then repeat the same steps. Use the most conventional type of faucet for water supply. In case the faucet is square or too big, remove the spacing ring before inserting the faucet into the adaptor.

### Positioning the drain hose

The end of the drain hose may be positioned in three ways:

#### Over the edge of a wash basin.

The drain hose must be placed at a height of between 60 and 90 cm. To keep the drain hose spout bent, use the supplied plastic hose guide. Secure the guide to the wall with a hook or to the faucet with a piece of string to prevent the drain hose from moving.



#### In a sink drain pipe branch

The drain pipe branch must be above the sink siphon so that the end of the hose is at least 60 cm above the ground.

#### In a drain pipe

Maytag recommends that you use a 65 cm high vertical pipe; it must be no shorter than 60 cm and no longer than 90 cm.

## Installing the Washing Machine

### Plugging in the machine

**For European Users.** You will **NOT** need to ground the plug of the washing machine.

**For U.S. Users.** You **MUST** ground the plug of the washing machine.

Check with a licensed electrician before using the machine to make sure it is properly grounded.

**For U.K. Users.**

### Wiring Instructions

#### **WARNING THIS APPLIANCE MUST BE EARTHED.**

This appliance must be earthed. In the event of an electrical short circuit, earthing reduces the risk of electric shock providing an escape wire for the electric current. The appliance is equipped with a mains lead which includes an earth wire for connecting to the earth terminal of your mains plug. The plug must be plugged into a socket that is properly installed and earthed.

\*The wires in this mains lead are coloured in accordance with the following code:

- Green and yellow : Earth
  - Blue : Neutral
  - Brown : Live
- AS the colours of the wires in the mains lead of this appliance may not correspond with the coloured markings identifying the terminals in your plug, proceed as follows.
  - Connect the green and yellow wire to the terminal in the plug marked with the letter E or the earth symbol (  $\equiv$  ) or coloured green or green-and-yellow.
  - Connect the blue wire to the terminal marked with the letter N or coloured black.
  - Connect the brown wire to the terminal marked with the letter L or coloured red.
- \* Consult a qualified electrician or service technician if in doubt about any of these instructions. The manufacturer of this washing machine will not accept any liability for damage to persons or material for non observance of these requirements. There are no user serviceable parts inside the washing machine and if the mains lead of this appliance is damaged, it must only be replaced by qualified service personnel approved by the manufacturer because special tools are required.

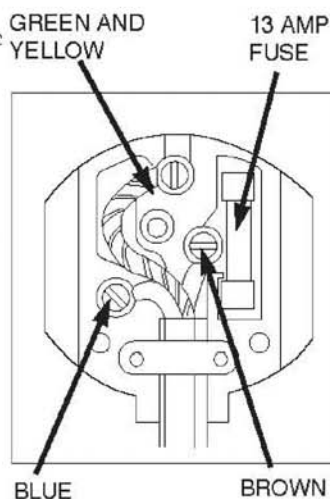

#### **WARNING**

Ensure that the plug and power cord are not damaged before use. If you have any reason to remove the moulded plug from this appliance, immediately remove the fuse and dispose of the plug. Do not connect the plug to a mains socket under any circumstances as there is a danger of electric shock.

#### **CIRCUITS**

Your washing machine should be operated on a separate circuit from other appliances. Failure to do this may cause the circuit breaker to trip or the fuse to blow.

## Washing a Load of Laundry

### Washing for the first time

Before washing clothes for the first time, you must run a complete cycle without clothes. To do this:

1. Press the (On/Off) button.
2. Pour a little detergent into compartment (II) in the detergent drawer.
3. Turn on the water supply to the washing machine.
4. Press the Temperature button repeatedly until 40 °C is displayed.
5. Press the Start/Pause button.
  - This will remove any water from the manufacturer's test run remaining in the machine.

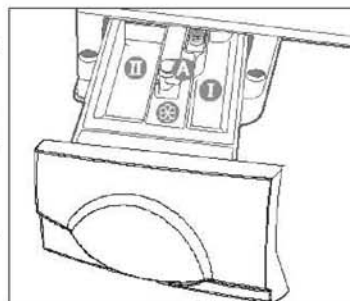

**Dispenser (I)** : Detergent for prewash or starch.

**Dispenser (II)** : Detergent for main wash, water softener, pre-soaking agent, bleach and stain removal product.

**Dispenser (III)** : Additives, e.g. fabric softener or former (fill no higher than lower edge of insert "A")

### Putting detergent in the washing machine

1. Pull out the detergent drawer.
2. Add laundry detergent into compartment (II) .
3. Add softener into compartment (III) (if you desire).
4. Add prewash detergent into compartment (I) (if you desire).

#### Caution :

Concentrated or thick fabric softener and conditioner must be diluted with a little water before being poured into the dispenser (prevents the overflow from becoming blocked.)

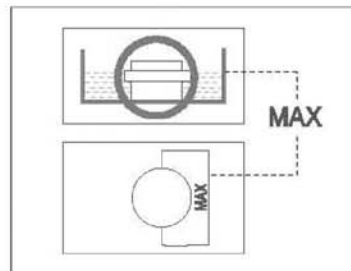

## Washing a Load of Laundry

### Overview of the control panel

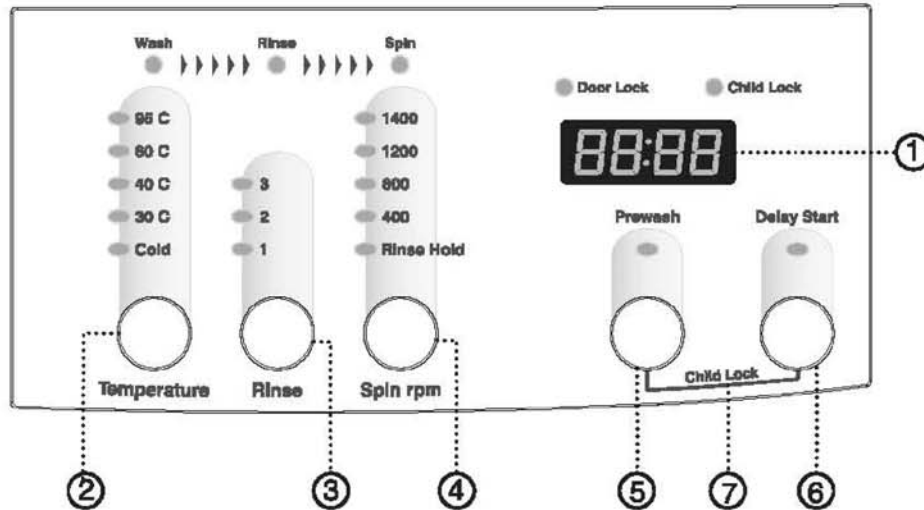

#### 1. Digital display

Displays the remaining wash cycle time, all of washing information and error messages.

#### 2. Temperature selection button

Press the button repeatedly to cycle through the available water temperature options.

#### 3. Rinse selection button

Press the rinse button to add rinse cycles. Maximum number of rinse cycles is three.

#### 4. Spin selection button

Press the button repeatedly to cycle through the available spin speed options.

##### Rinse Hold

The laundry remains soaking in the final rinse water

Before the laundry can be unloaded, either "Drain" or "Spin" program must be run

#### 5. Prewash selection button

Press the button to select pre-wash. Pre-wash is available only with White Cotton, Colours, Synthetics and Delicates programs.

#### 6. Delay Start selection button

Press the button repeatedly to cycle through the available delayed start options (from 1 hour to 19 hours in one hour increments).

Displayed hours means the time of started washing-cycle.

#### 7. Child Lock selection button

Press the button for 2-3 seconds to prevent mis-operation of child. When child lock is on, other buttons are not selected. To cancel the child lock, press the button for 2-3 seconds once more.

## Washing a Load of Laundry

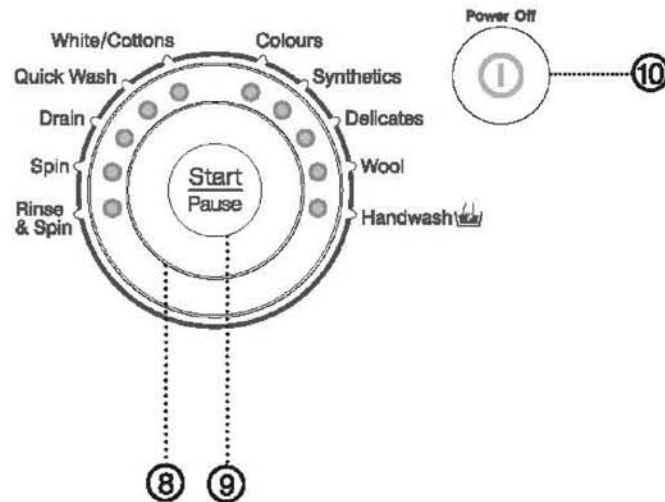

### 8. Control dial

Turn the dial to select one of the 10 available wash programs.

Hand wash, Wool, Dedicates, Synthetics, Colours, White / Cottons,  
Quick Wash, Drain, Spin, Rinse & Spin

### 9. Start/Pause selection button

Press to pause and restart programs.

### 10. ⏻ (On/Off) selection button

Press once to turn the washing machine on, press again to turn the washing machine off. If the washing machine power is left on for longer than 10 minutes without any buttons being touched, the power automatically turns off.



## Washing a Load of Laundry

### Washing clothes using Fuzzy Logic

Your new washing machine makes washing clothes easy, using Maytag's "Fuzzy Logic" automatic control system. When you select a wash program, the machine will set the correct temperature, washing time, and washing speed.

To wash clothes using the Fuzzy Logic programs:

1. Turn on your sink's water faucet.
2. Press the  (On/Off) button.
3. Open the door.
4. Load the articles one at a time loosely into the drum, without overfilling.
5. Close the door.
6. Add the detergent, softener, and pre-wash detergent (if necessary) into the appropriate compartment.

**Note:** Pre-wash is only available when washing White Cotton, Colours, Synthetics and Delicates programs.

It is only necessary if your clothing is heavily soiled.

7. Turn the Fuzzy Control dial to select the appropriate program for the type of clothes Hand wash, Wool, Delicates, Synthetics, Colours, White/Cottons, Quick Wash.

You will see the indicators light up on the control panel.

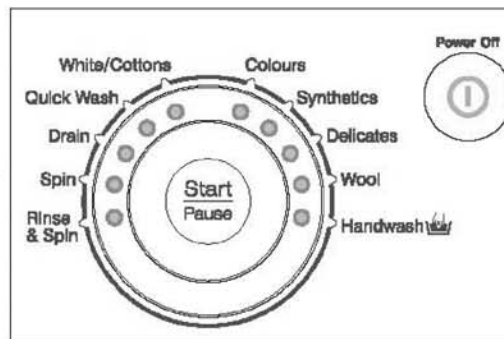

8. At this time, you can control the wash temperature, rinsing times, spin speed, delay time by pressing the appropriate option button.
9. Press the Start/Pause button on the Fuzzy Control dial and the wash cycle will begin. The process indicator will light up and the remaining time for the cycle will appear in the display.

### Pause Option

1. The door can NOT be opened when the water is too HOT or the water level is too HIGH.
2. After closed the door, depressing the START/PAUSE button again will restart the washing process.

### When the cycle is finished:

After the total cycle has finished, the power will turn off automatically.

1. Open the door.
2. Remove laundry.



## Washing a Load of Laundry

### Washing clothes manually

You can wash clothes manually without using the Fuzzy Logic feature. To do so:

1. Turn the water supply on.
2. Press the  $\text{\textcircled{I}}$  (On/Off) button on the washing machine.
3. Open the door.
4. Load the articles one at a time loosely into the drum, without overfilling.
5. Close the door.
6. Put the detergent and, if necessary, softener or prewash detergent, in the appropriate compartments.
7. Press the Temperature button to select the temperature (cold water, 30°C, 40°C, 60°C, 95°C)
8. Press to rinse button to select the required number of rinse cycles. Maximum number of rinse cycles is five. The washing duration will be prolonged accordingly.
9. Press the Spin button to select the spin speed.  
**Note:** The rinse hold program allows you to take clothes that are dripping wet out of the washing machine.
10. Press the button repeatedly to cycle through the available delayed start options (from 1 hour to 19 hours in one hour increments). Displayed hours means the time of finished washing-cycle.
11. Press the Start/ Pause button and the machine will begin the cycle.

### Using Delay Start

You can set the washing machine to finish your wash automatically at a later time, choosing from 1 to 19 hour delay (in 1 hour increments). Displayed hours means the time of started washing-cycle.

To do this:

1. Manually or automatically set your washing machine for the type of clothes you are washing.
2. Press the Delay Start button repeatedly until the delay time is set.
3. Press the Start/ Pause button. The Delay Start indicator will light, and the clock will begin counting down until it reaches your finish time.
4. To cancel Delay Start, press the  $\text{\textcircled{I}}$  (On/Off) button, then turn the washing machine on again.

## Washing a Load of Laundry

### Washing tips and hints

**Sorting your laundry :** Sort your laundry according to the following characteristics:

- **Type of fabric care label symbol :** Sort laundry into cottons, mixed fibers, synthetics, silks, wools and rayon.
- **Colour :** Divide whites and colours. Wash new, coloured items separately.
- **Size:** Placing items of different sizes in the same load will improve the washing action.
- **Sensitivity:** Wash delicate items separately, using the Delicate wash program for pure new wool, curtains and silk articles. Check the labels on the items you are washing or refer to the fabric care chart in the appendix.

**Emptying pockets :** Coins, safety pins and similar items can damage linen, the washing machine drum, and the water tank.

**Securing fasteners :** Close zippers and fasten buttons or hooks; loose belts or ribbons should be tied together.

**Prewashing cotton :** Your new washing machine, combined with modern detergents, will give perfect washing results, thus saving energy, time, water and detergent. However, if your cotton is particularly dirty, use a prewash with a protein-based detergent.

**Determining load capacity:** Do not overload the washing machine or your laundry may not wash properly. Use the chart below to determine the load capacity for the type of laundry you are washing.

Fabric Type	Load Capacity
Cotton / Coloured	7.0 kg
Synthetics / Towel	4.0 kg
Quick	3.0 kg
Delicates	2.5 kg
Wools / Handwash	2.0 kg
Curtain / Bedding	5.0 kg
Duvet	1 king size (9 Tog)

**Detergent tips:** The type of detergent you should use is based on the type of fabric (cotton, synthetic, delicate items, wool), colour, wash temperature, degree and type of soiling. Always use "low suds" laundry soap, which is designed for automatic washing machines.

Follow the detergent manufacturer's recommendations based upon the weight of the laundry, the degree of soiling, and the hardness of the water in your area. If you do not know how hard your water is, ask your water authority.

**Note:**

Keep detergents and additives in a safe, dry place out of the reach of children.

## Maintaining the Washing Machine

### Draining the washing machine in an emergency

1. Unplug the washing machine from the power supply.
2. Open the filter-cover by using a coin or a key.

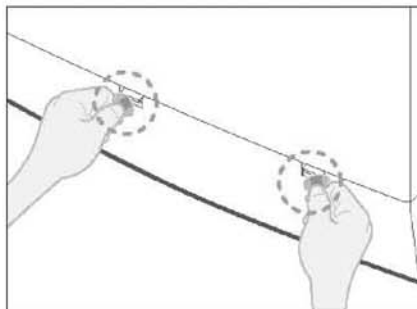

3. Unscrew the emergency drain cap by turning left. Grip the cap on the end of the emergency drain tube and slowly pull it out about 15 cm.

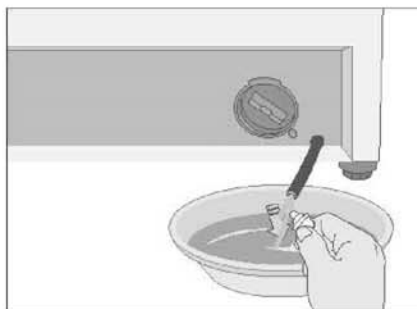

4. Allow all the water to flow into a bowl.
5. Reinsert the drain tube and screw the cap back on.
6. Replace the filter-cover.

### Repairing a frozen washing machine

If the temperature drops below freezing and your washing machine is frozen:

1. Unplug the washing machine.
2. Pour warm water on the source faucet to loosen the water supply hose.
3. Remove the water supply hose and soak it in warm water.
4. Pour warm water into the washing machine drum and let it sit for 10 minutes.
5. Reconnect the water supply hose to the water faucet and check if the water supply and drain operations are normal.

### Cleaning the exterior

1. Wipe the washing machine surfaces, including the control panel, with a soft cloth and non-abrasive household detergents.
2. Use a soft cloth to dry the surfaces.
3. Do not pour water on the washing machine.

## Maintaining the Washing Machine

### Cleaning the detergent drawer and recess

1. Press the release lever on the inside of the detergent drawer and pull it out.
2. Remove the cap from compartment ②.
3. Wash all of the parts under running water.
4. Clean the drawer recess with an old toothbrush.
5. Reinsert the cap (Pushing it firmly into place) and replace the liquid detergent divider into the drawer.
6. Push the drawer back into place.
7. Run a rinse program without any laundry in the drum.

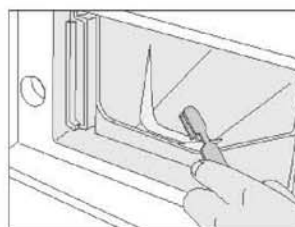
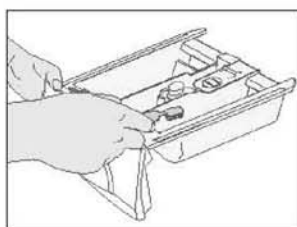

### Cleaning the debris filter

Clean the debris filter 5 or 6 times a year, or when you see the following error message on the display:

5E

1. Open the filter-cover,  
See "Draining the washing machine in an emergency" on page 13.
2. Unscrew emergency drain cap by turning left and drain off all the water.  
See "Draining the washing machine in an emergency" on page 13.
3. Unscrew the filter cap and take it out.

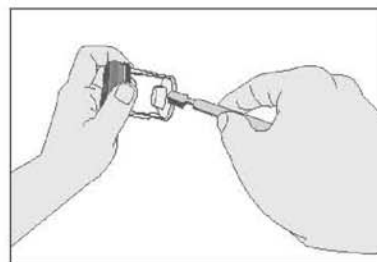

4. Wash any dirt or other material from the filter. Make sure the drain pump propeller behind the filter is not blocked. Replace the filter cap.
5. Replace the filter-cover.

## Maintaining the Washing Machine

### Cleaning the water hose mesh filter

You should clean the water hose mesh filter at least one time per year, or when you see the following error message on the display:

**4E**

#### To do this:

1. Turn off the water source to the washing machine.
2. Unscrew the hose from the back of the washing machine.
3. With a pair of pliers, gently pull out the mesh filter from the end of the hose and rinse it under water until clean. Also clean the inside and outside of the threaded connector.

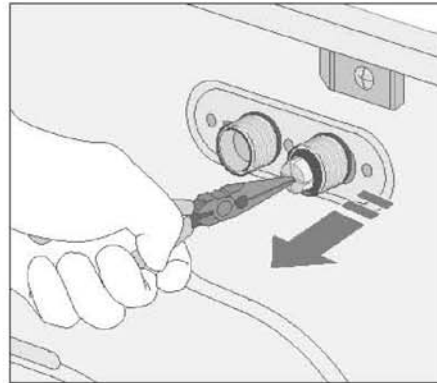
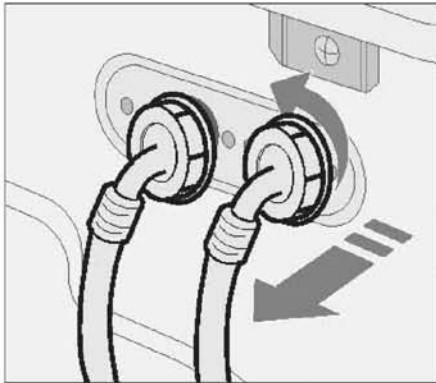

4. Push the filter back into place.
5. Screw the hose back onto the washing machine.
6. Turn on the faucet and make sure the connections are watertight.



## Troubleshooting

### Problems and solutions

#### The washing machine will not start

- Make sure the door is firmly closed.
- Make sure the washing machine is plugged in.
- Make sure the water source faucet is turned on.
- Make sure to press the Start / Pause button.

#### No water or insufficient water supply

- Make sure the water source faucet is turned on.
- Make sure the water source hose is not frozen.
- Make sure the water intake hose is not bent.
- Make sure the filter on the water intake hose is not clogged.

#### Detergent remains in the detergent drawer after the wash program is complete

- Make sure the washing machine is running with sufficient water pressure.
- Put the detergents in the inner parts of the detergent drawer (away from the outside edges).

#### Washing machine vibrates or is too noisy

- Make sure the washing machine is set on a level surface. If the surface is not level, adjust the washing machine feet to level the appliance (see page 3).
- Make sure that the shipping bolts are removed (see page 3).
- Make sure the washing machine is not touching any other object.
- Make sure the laundry load is balanced.

#### The washing machine does not drain and/or spin

- Make sure the drain hose is not squashed or bent.
- Make sure the debris filter is not clogged.

#### The Door does not open

- The door will not open until 3 minutes after the machine stops or the power turns off.

### Understanding error messages

#### Error displayed

#### Solution

door

Close the door.

4E

- Make sure the source water faucet is turned on.
- Check the water pressure.

5E

- Clean the debris filter.
- Make sure the drainage hose is installed correctly.

UE

Laundry load is unbalanced; loosen any tangled laundry.  
If only one item of clothing needs washing, such as a bathrobe or jeans, the final spin result might be unsatisfactory and an "UE" error message will be shown in the display window.

eE

3E

- Call after-sales service.

#### Before contacting After-Sales service:

1. Try to remedy the problem (See "Troubleshooting" on this page).
2. Restart the programme to see if the fault is repeated.
3. If the malfunction persists, call after-sales service and describe the problem.

## Programme Chart

(\* user option)













PRO-GRAM	Max load (kg)	DETERGENT AND ADDITIVES		Tem (°C)		Spin Speed (MAX)rpm	Delay start	Water (l)	Electricity (kWh)
		Prewash	wash	default	Max				
Cotton	7.0	*	yes	60	95	1400	*	75	1.33
Coloureds	7.0	*	yes	40	40	1400	*	75	0.90
Synthetics	4.0	*	yes	40	60	800	*	55	0.85
Delicates	2.5	*	yes	40	40	800	*	55	0.85
Wool	2.0	-	yes	30	40	400	*	65	0.75
Handwash	2.0	-	yes	30	30	400	*	65	0.75
Quick	3.0	-	yes	40	40	1400	*	45	0.45

PROGRAM	Type of WASH
Hand wash	Average or lightly soiled cottons, bed linen, table linen, underwear, towels, shirts, etc.
Wool	Average or lightly soiled cottons, bed linen, table linen, underwear, towels, shirts, etc.
Dedicates	Average or lightly soiled blouses, shirts, etc, which are made of polyester (diolen, trevira), polyamide (perlon, nylon) or other similar blends.
Synthetics	Delicate curtains, dresses, skirts, shirts and blouses.
Colours	Only machine washable woolens with pure new wool label.
White/ Cottons	Very light wash course like hand wash.
Quick Wash	Lightly soiled cottons or linen blouses, shirts, dark coloured terry cloth, coloured linen articles, jeans, etc.

1. Programme with prewash lasts approx. 15 minutes longer.
2. The programme duration data has been measured under the conditions specified in Standard IEC 456.
3. Consumption in individual homes may differ from the values given in the table due to variations in the pressure and temperature of the water supply, the load and the type of laundry.

## Appendix

### Fabric care chart

	Resistant material		Can be ironed at 100 °C max
	Delicate fabric		Do not iron
 	Item may be washed at 95 °C		Can be dry cleaned using any solvent
 	Item may be washed at 60 °C		Dry clean with perchloride, lighter fuel, pure alcohol or R113 only
 	Item may be washed at 40 °C		Dry clean with aviation fuel, pure alcohol or R113 only
 	Item may be washed at 30 °C		Do not dry clean
	Item may be hand washed		Dry flat
	Dry clean only		Can be hung to dry
	Can be bleached in cold water		Dry on clothes hanger
	Do not bleach		Tumble dry, normal heat
	Can be ironed at 200 °C max		Tumble dry, reduced heat
	Can be ironed at 150 °C max		Do not tumble dry

### Electrical warnings

To reduce the risk of fire, electrical shock, and other injuries, keep these safety precautions in mind:

- Operate the appliance only from the type of power source indicated on the marking label. If you are not sure of the type of power supplied to your home, consult your appliance dealer or local power company.
- Use only a grounded or polarized outlet. For your safety, this appliance is equipped with a polarized alternating current line plug having one blade wider than the other. This plug will fit into the power outlet only one way. If you are unable to insert the plug fully into the outlet, try reversing the plug. If the plug still doesn't fit, contact your electrician to replace your outlet.
- Protect the power cord. Power supply cords should be routed so that they are unlikely to be walked on or pinched by items placed on or against them. Pay particular attention to cords at plugs, convenience receptacles, and the point where they exit from the unit.
- Do not overload the wall outlet or extension cords. Overloading can result in fire or electric shock.

## Appendix

### Protecting the environment

- This appliance is manufactured from recyclable materials. If you decide to dispose of this appliance, please observe local waste disposal regulations. Cut off the power cord so that the appliance cannot be connected to a power source. Remove the door so that animals and small children cannot get trapped inside the appliance.
- Do not exceed the detergent quantities recommended in the detergent manufacturers' instructions.
- Use stain removal products and bleaches before the wash cycle only when strictly necessary.
- Save water and electricity by only washing full loads (the exact amount depends upon the program used).

### Declaration of conformity

This appliance complies with European safety standards, EC directive 93/68 and EN Standard 60335.

### Specification

TYPE	FRONT LOADING WASHER		
DIMENSION	W600mm x D600mm x H850mm		
WATER PRESSURE	50 kPa ~ 800 kPa		
WEIGHT	75 kg		
WASH and SPIN CAPACITY	7.0kg (DRY LAUNDRY)		
POWER CONSUMPTION	WASHING	220V	150W
		240V	150W
	WASHING AND HEATING	220V	2400W
		240V	2800W
	SPIN	230V	500W
PUMPING	34W		
WATER VOLUME	60l (STANDARD COURSE)		
SPIN REVOLUTION	rpm	1400	
PACKAGE Wt	PAPER	2.5 kg	
	PLASTIC	1.0 kg	

**IN CASE THE NEED FOR  
SERVICING ARISES**

-Don't hesitate to call any AS center nearby  
with your name, address, telephone number,  
model number and serial number of your machine  
when anything wrong with your product occurs.



Maytag Europe  
2 St. Annes Blvd Foxboro Business Park  
Redhill Surrey  
RH1 1AX  
Great Britain

TEL: (44) 1509 264 007

Code No.: DC68-000000